

ADJUSTMENTS

Before riding - always ensure that the basic settings made by Öhlins are intact.

- 1 Spring Preload**
Use the C-spanner provided in this kit. Turn the spring platform nut (A) clockwise to increase the spring preload, turn counter clockwise to decrease it. Lock the setting with the lock nut (B).

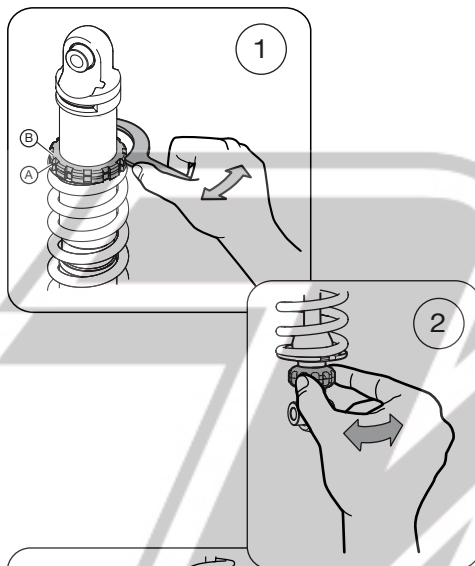

- 2 Rebound**
Turn the wheel on the piston shaft above the end eye/bracket. Turn clockwise to increase damping, turn counter clockwise to decrease.

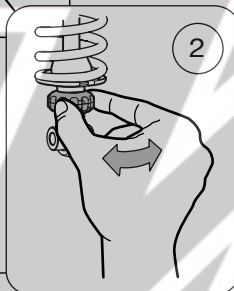

NOTE!

When delivered the Öhlins shock absorber is dialed to the recommended settings for the specific vehicle model. If you have changed the setting, reset according to the following:

The adjuster has a right hand thread. Turn the adjuster clockwise to fully closed (pos. zero [0]). Turn counter clockwise to open and count the clicks until you reach the recommended number (see Set-up Data).

CAUTION!

Do not use force, delicate sealing surfaces can be damaged. Handtighten only.

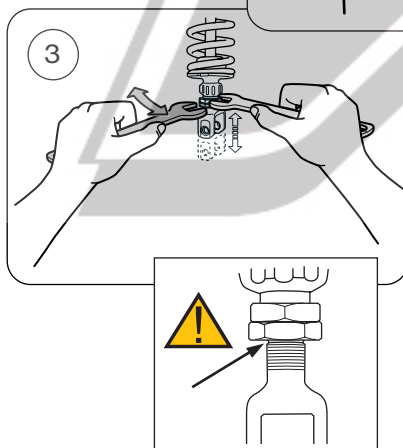

- 3 Length**
We recommend you to adjust the length before installing the shock absorber to the vehicle. Use two wrenches. Hold the upper nut with one hand and at the same time loosen the lock nut (lower nut). Turn the end eye/ bracket to the desired length. Lock the lock nut. Tightening torque: 40 Nm.

⚠ WARNING!

The adjustable end eye/bracket must not be threaded out more than that the groove is fully visible beneath the lock nut. This is maximum length. After adjusting, make sure that the lock nut is tightened.

Mounting instruction

WITH SET-UP DATA

SHOCK ABSORBER YA754
for Yamaha XVS 1300A Midnight Star

Before installing this shock absorber, check the contents of the kit listed below. If anything is missing, please contact your nearest Öhlins dealer.

Kit Contents	Art. No.	Pcs.
Shock absorber	YA753	1
Öhlins Sticker black	00191-13	2
Öhlins Sticker white	00191-20	2
Memo Notes Sticker	01180-01	1
C-spanner	00710-02	1
Owner's Manual	07241-02	1

Set-up data

Spring preload	14 mm
Rebound damping	18 click
Shock absorber length	305 ⁰ ₋₁₂
Stroke	39,5
Spring	21014-64
Free spring length	140 mm

During storage and transportation, especially at high ambient temperature, some of the oil and grease used for assembling may leak and stain the packaging. This is in no way detrimental to the product, wipe off the excessive oil/grease with a cloth.

Before installing this product, read the Öhlins Owner's Manual!



HOW TO INSTALL

⚠ WARNING!

It is advisable to have an Öhlins dealer to install the shock absorber. Refer to your vehicle service manual when installing this product.

1. Put the motorcycle on a workstand and raise it so that the rear wheel barely touches the ground.

⚠ WARNING!

Make sure the vehicle is securely supported so that it will not tip.

2. Remove the seat, dust cover and tool box.

3. Disconnect and remove the battery and loosen the battery box (do not remove).

4. Remove the left side cover and disconnect the seat release wire.

5. Remove the seat lock bracket.

6. Loosen the relay bracket (do not remove) to reveal the upper (LH) shock absorber attachment.

7. Remove the right side cover.

8. Loosen the fuel-tank (do not remove) to reveal the upper (RH) shock absorber attachment.

9. Remove the screws at the lower attachment of the original shock absorber and the link arm.

10. Remove the screw at the upper attachment of the original shock absorber, while gently lifting the fuel tank.

11. Remove the original shock absorber.

Install the ÖHLINS shock absorber:

NOTE!

Before installing the Öhlins shock absorber:

- Clean the vehicle thoroughly
- Adjust the length of the shock absorber (check the headlight angle after adjusting the length!)

12. Make sure that the shock absorber oil fill screw is at the top and pointing towards the rear. Attach the upper screw of the Öhlins shock absorber, without tightening yet.

13. Reinstall the triangle link and link arm, and attach the lower screw of the Öhlins shock absorber. Do not tighten yet.

NOTE!

Lower the motorcycle so that the shock absorber is slightly compressed, before tightening the screws.

14. Tighten the screws of the upper and lower attachments, triangle link and push rods.

15. Reinstall all removed parts in the same way as they were before installation of the Öhlins shock absorber.

NOTE!

Make sure that all screws are tightened to the correct torque and that nothing fouls or restricts movement of the shock absorber when the suspension is being fully compressed or extended.

