

## SET-UP DATA

### Recommendations

Spring preload	11 mm
Compression damping	
Low speed	15 clicks
High speed	30 clicks
Rebound damping	16 clicks

### Shock absorber data

Length	302 (+4/-2)
Stroke	64 mm

*Always ensure that the basic settings made by Öhlins are intact.*

## CHECK SAG AND RIDE HEIGHT

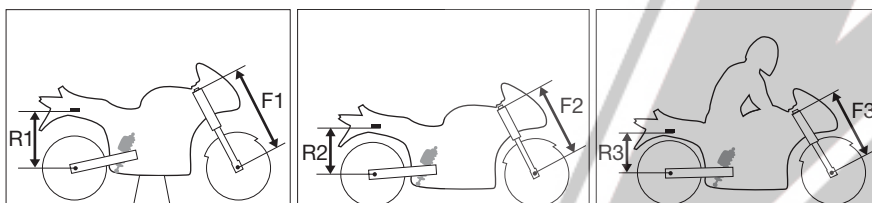

### Front suspension

- F1 Bike on a stand with the suspension fully extended = ...
- F2 Bike on the ground without rider = ...
- F3 Bike on the ground with rider = ...

**Free sag F1-F2 = ...**

**Ride height F1-F3 = ...**

### Rear suspension

- R1 Bike on a stand with the suspension fully extended = ...
- R2 Bike on the ground without rider = ...
- R3 Bike on the ground with rider = ...

**Free sag R1-R2 = ...**

**Ride height R1-R3 = ...**

# Mounting Instructions

WITH SET-UP DATA

## SHOCK ABSORBER YA743 for Yamaha R1 2007

Before installing this shock absorber, check the contents of the kit listed below. If anything is missing, please contact your nearest Öhlins dealer.

### Kit Contents:

	Part no.	Pcs.
Shock absorber	YA743	1
Öhlins Sticker	00192-01	2
Memo notes Sticker	01180-01	1
Owner's Manual		1

### NOTE!

During storage and transportation, especially at high ambient temperature, the oil and grease used for assembling may leak inside the packing and damage the expanded polystyrene packing material. This is not unusual and is in no way detrimental to the shock absorber.

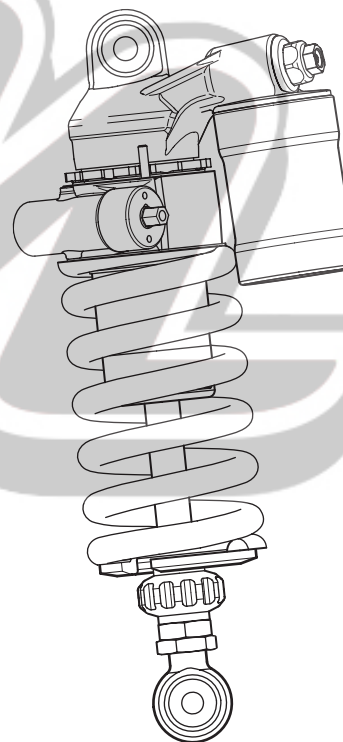

Before installing this product, read the Öhlins Owner's Manual!



## HOW TO INSTALL

1

Put the motorcycle on a workstand so that the rear wheel barely touches the ground.

### ⚠ WARNING!

Make sure the vehicle is securely supported so that it will not tip.

2

Remove the upper and the lower attachments of the original shock absorber.

3

Remove the original shock absorber.

### NOTE!

Recommendation! Before installing the Öhlins shock absorber:

- clean the vehicle thoroughly

4

Install the Öhlins shock absorber in the same way as the original unit.

5

Fasten the upper and the lower attachments, but do not tighten yet.

### NOTE!

Lower the motorcycle so that the shock absorber is compressed 1 mm, before tightening the screws.

6

Tighten the upper and the lower attachments.

7

Read more about the shock absorber in the Öhlins Owner's Manual.

### NOTE!

Make sure that all screws are tightened to the correct torque and that nothing fouls or restricts movement of the shock absorber when the suspension is being fully compressed or extended.

## ADJUSTMENTS

1

### Spring preload adjuster

Turn the hexagon screw on the hydraulic adjuster to set the spring preload. Turn clockwise to increase, turn counter clockwise to release the preload.

2

### Compression damping

Adjust on top of the reservoir.  
Low speed: Turn the slotted centre screw.  
High speed: Turn the hexagon screw. Turn clockwise to increase damping, turn counter clockwise to decrease.

3

### Rebound damping

Turn the wheel on the piston shaft above the end eye/ bracket. Turn clockwise to increase damping, turn counter clockwise to decrease.

4

### Length adjuster

Use two wrenches. Hold the upper nut with one hand and at the same time loosen the lock nut (lower nut). Turn the end eye/ bracket to the desired length. Lock the lock nut. We advise to adjust the length when the shock absorber is not installed into the vehicle.

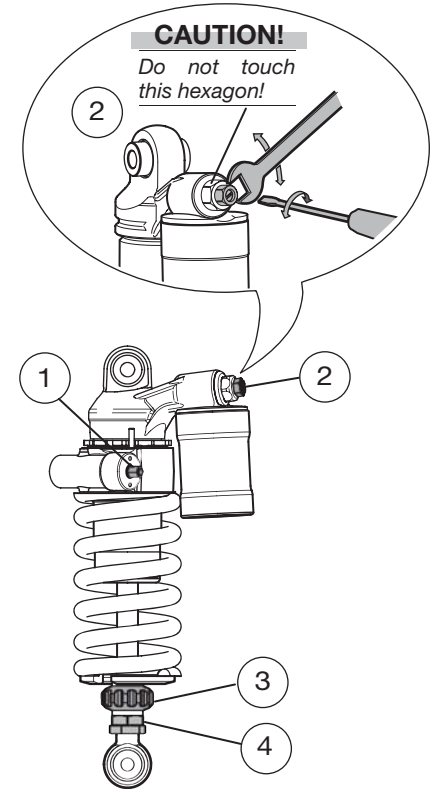

### ⚠ WARNING!

The adjustable end eye/bracket must not be threaded out more than that the groove is fully visible beneath the lock nut. This is maximum length. After adjusting, make sure that the lock nut is tightened.

### NOTE!

Maximum length when the groove is visible.

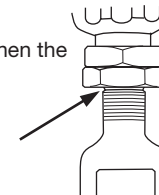

### NOTE!

When delivered the Öhlins shock absorber is dialed to recommended settings for the specific brand and make of the vehicle. If you have changed the setting, reset according to the set-up data.

To reset: The adjuster has a right hand thread. Turn the adjuster clockwise to fully closed (pos. zero [0]). Turn counter clockwise to open and count the clicks until you reach the recommended number in the set-up data.

### CAUTION!

Do not use force, delicate sealing surfaces can be damaged. Handtighten only.