

Setup data

Shock absorber length	341 mm
Shock absorber stroke	68 mm
Spring pre-load	12 mm
Rebound damping adjuster	14 clicks

Checking sag and ride height

Front suspension

F1. Bike on a stand with the suspension fully extended =

F2. Bike on the ground without rider =

F3. Bike on the ground with rider =

Free sag F1 - F2 =

Ride height F1 - F3 =

Rear suspension

R1. Bike on a stand with the suspension fully extended =

R2. Bike on the ground without rider =

R3. Bike on the ground with rider =

Free sag R1 - R2 =

Ride height R1 - R3 =



Öhlins Racing AB, Box 722, S-194 27 Upplands Väsby, Sweden.
Phone +46 8 590 025 00. Fax +46 8 590 025 80.
www.ohlins.com

Part No. YA 418. Issued 04 06 04

Mounting Instructions

Öhlins shock absorber kit
YA 418 for Yamaha XT660R

Öhlins shock absorber 46 DR

Your Öhlins shock absorber type 46 DR features the following adjusters:

Rebound damping adjuster

Adjuster wheel on the piston shaft above the end bracket.

Spring pre-load adjuster

Adjustments are made by turning the threaded ring on the shock absorber body. Use the tool provided. Clockwise for harder adjustment, counter clockwise to release the pre-load.



NOTE!

When delivered the Öhlins shock absorber is dialed to recommended settings for the specific brand and make of the motorcycle. If you have changed the settings, check like this:

The adjusters have a normal right hand thread. Turn the damping adjusters clockwise to fully closed (pos. zero [0]). Turn counter clockwise to open and count the clicks until you reach the recommended number of clicks. See Setup data at last page.

CAUTION!

Do not use too much force, delicate sealing surfaces can be damaged.

© Öhlins Racing AB. All rights reserved. Any reprinting or unauthorized use without the written permission of Öhlins Racing AB is prohibited. Printed in Sweden.



Important information concerning safety is distinguished in this manual by the following notations:

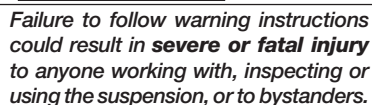
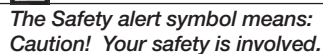

Caution indicates that special precautions must be taken to avoid damage to the suspension.

This indicates information that is of importance with regard to procedures.

NOTE!

During storage and transportation, especially at high ambient temperature, the oil and grease used for assembling may run out inside the packing and damage the expanded polystyrene packing material. This is not unusual and is in no way detrimental to the shock absorber.

Before installing the shock absorber, please check the contents of the kit. If anything is missing, contact your Öhlins dealer.

Description	Pcs.	Part No.
Shock absorber 46 DR	1	YA 418
C-spanner	1	00710-02
Washer	2	00153-09
Lock nut M12	1	00539-01
Bolt M12x55	1	00439-16
Sticker memo notes	1	01180-01
Sticker Öhlins	2	00192-01
Owners manual	1	

Öhlins Racing AB can not be held responsible for any damage whatsoever to shock absorber or vehicle, or injury to persons, if the instructions for fitting and maintenance are not followed exactly.

Similarly, the warranty will become null and void if the instructions are not adhered to.

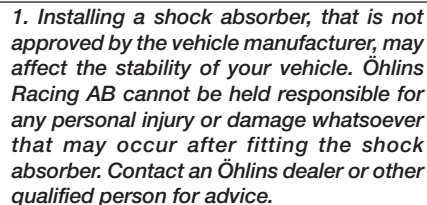

2. Please study and make certain that you fully understand all the mounting instructions and the owners manuals before handling this shock absorber kit. If you have any questions regarding proper installation procedures, contact an Öhlins dealer or other qualified person.

3. The vehicle service manual must be referred to when installing the Öhlins shock absorber

Notes

Mounting instructions

1

Put the motorcycle on a stand so the rear wheel is clear of the ground. Make sure it's steadily fixed so it will not fall over.

⚠ WARNING!

1. It's advisable to have an Öhlins dealer or other qualified person to fit your shock absorber.
2. Instructions in the vehicle service manual are to be followed when changing the shock absorber.
3. When working on a lifted vehicle it must be securely supported to prevent it from falling.

2

Remove the seat, the side fairings and the tool case.

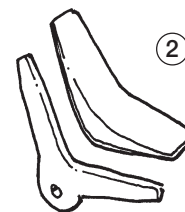

Remove the seat and the side fairings

3

Loosen the battery cover (2 screws) and the connection cables. Remove the battery.

4

Loosen the regulator and the ignition box.

5

Disconnect the multicontact.

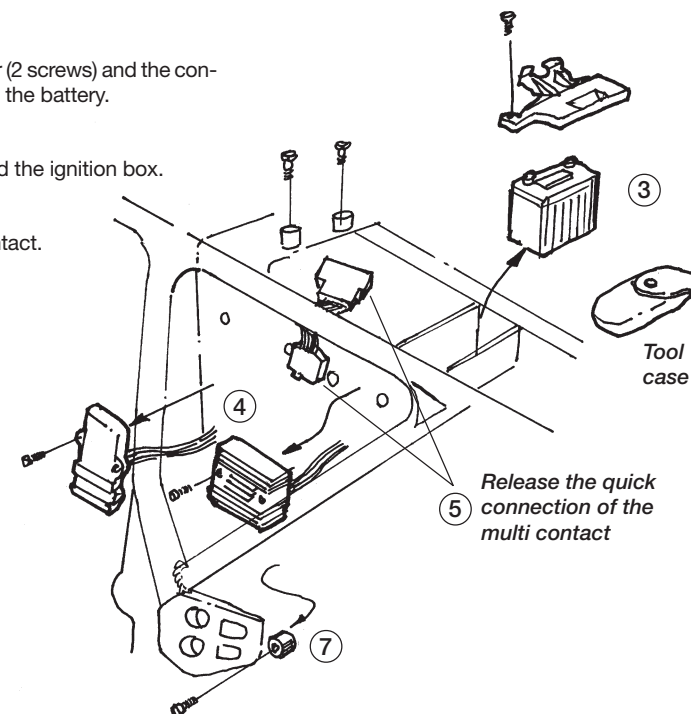

6

Loosen the chain tensioner (roller).

The air filter box must be pressed down in order to access the upper shock absorber mount

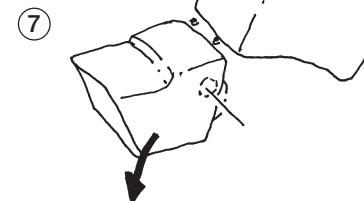

7

Loosen the air cleaner unit (fuel tank bolts), so that it can be turned down downward, to access the upper shock absorber mounting.

8

Loosen and remove the triangle link and the pulling rod.

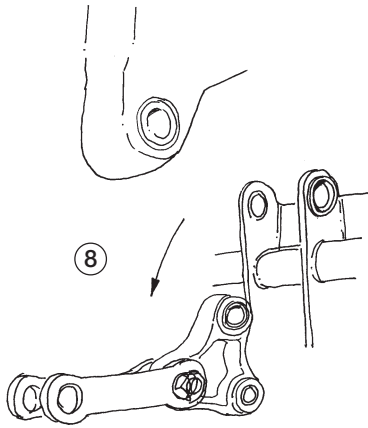

9

Loosen and remove the original shock absorber from below.

10

Fit the Öhlins shock absorber from below, by first attaching the upper bracket. Make sure the gas filling valve of the shock absorber is directed toward the rear of the bike.

11

Refit the triangle link and pulling rod.

12

Fasten the air cleaner unit (fuel tank bolts).

13

Refit the chain tensioner (roller).

14

Reconnect the multicontact.

15

Fasten the regulator and the ignition box.

16

Refit the battery. Fasten the battery cover (2 screws) and the connection cables.

17

Refit the seat, the side fairings and the tool case.

NOTE!

Make sure that all bolts are tightened to the correct torque and that nothing fouls or restricts movement of the shock absorber when the suspension is being fully compressed or extended.

18

Continue your work according to the Owners Manual, section Adjustments.

Notes