

Mounting instructions

YA004 - YAMAHA Majesty YP 250

Kit contents

Shock absorber Type 36E	YA 004	
Sleeve 10/14/16.5 al	00123-11	2
Bolt M6SF 8x35	00432-01	2
C-spanner twin	00710-01	2
Sticker Öhlin	00192-01	2
Sticker Memo Notes	01180-01	1
Owners manual		1

Set-up data

Length	346 mm
Stroke	101 mm
Preload spring	22 mm

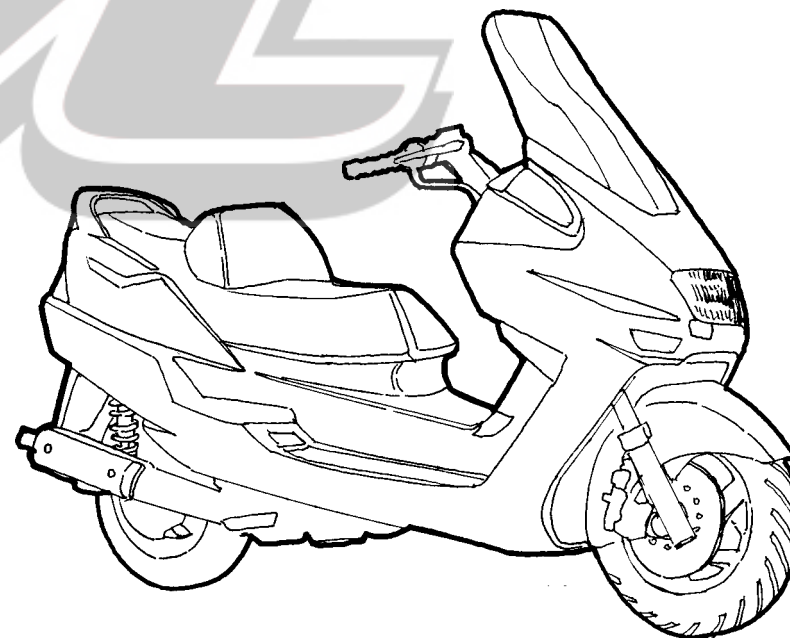

ADVANCED SUSPENSION TECHNOLOGY

Öhlins Racing AB, Box 722, S-194 27 Upplands Väsby, Sweden.

E-mail: info@ohlins.se

Web: www.ohlins.com

YA 004, ISSUED 00 12 18



ADVANCED SUSPENSION TECHNOLOGY

Safety signals

Important information concerning safety is distinguished in this manual by the following notations



The Safety alert symbol means:
Caution! Your safety is involved.

WARNING!

Failure to follow warning instructions could result in **severe or fatal injury** to anyone working with, inspecting or using the suspension, or to bystanders.

CAUTION!

Caution indicates that special precautions must be taken to avoid damage to the suspension.

NOTE!

This indicates information that is of importance with regard to procedures

Kit contents

Before installing the shock absorber, please check the contents of the kit, listed on the front page of this instruction. If anything is missing, contact your Öhlins dealer.

NOTE!

During storage and transportation, especially at high ambient temperature, the oil and grease used for assembling may run out inside the packing and damage the expanded polystyrene packing material. This is not unusual and is in no way detrimental to the shock absorber.

© Öhlins Racing AB.
All rights reserved.

Any reprinting or unauthorized use without the written permission of Öhlins Racing AB is prohibited.
Printed in Sweden.

Before you start

WARNING!

Installing a shock absorber, that is not approved by the vehicle manufacturer, may affect the stability of your vehicle. Öhlins Racing AB cannot be held responsible for any personal injury or damage whatsoever that may occur after fitting the suspension. Contact an Öhlins dealer or other qualified person for advice.

Öhlins Racing AB can not be held responsible for any damage whatsoever to shock absorber or vehicle, or injury to persons, if the instructions for fitting and maintenance are not followed exactly. Similarly, the warranty will become null and void if the instructions are not adhered to.

WARNING!

Please study and make certain that you fully understand all the mounting instructions and the owner's manuals before handling this shock absorber kit. If you have any questions regarding proper installation procedures, contact an Öhlins dealer or other qualified person.

WARNING!

The vehicle service manual must be referred to when installing the Öhlins shock absorber.

NOTE!

Öhlins products are subject to continual improvement and development. Consequently, although these instructions include the most up-to-date information available at the time of printing, there may be minor differences between your suspension and this manual. Please consult your Öhlins dealer if you have any questions with regard to the contents of the manual.

Mounting instructions

1

Put the motorcycle on the central stand so that the rear wheel is clear of the ground. Make sure it is fixed so it will not fall over.

2

Open the seat.

WARNING!

1. It's advisable to have an Öhlins dealer or other qualified person to fit your shock absorber.
2. Instructions in the motorcycle workshop manual are to be followed when changing the shock absorber.
3. When working on the motorcycle it must be securely supported to prevent it from falling over.

5

Remove left and right rear side cover.

6

Remove the rear cover part.

7

Remove the helmet carrier and the clothing. Uncouple the lightning devices.

8

Loosen the silencer, so it can be turned away.

9

Remove the original shock absorber.

10

Fit the Öhlins shock absorber. The head shall be upwards and the gas filling nipple to the rear. Sleeves 123-11 shall be mounted to the upper attachment and the bolt supplied shall be mounted to the lower attachment.

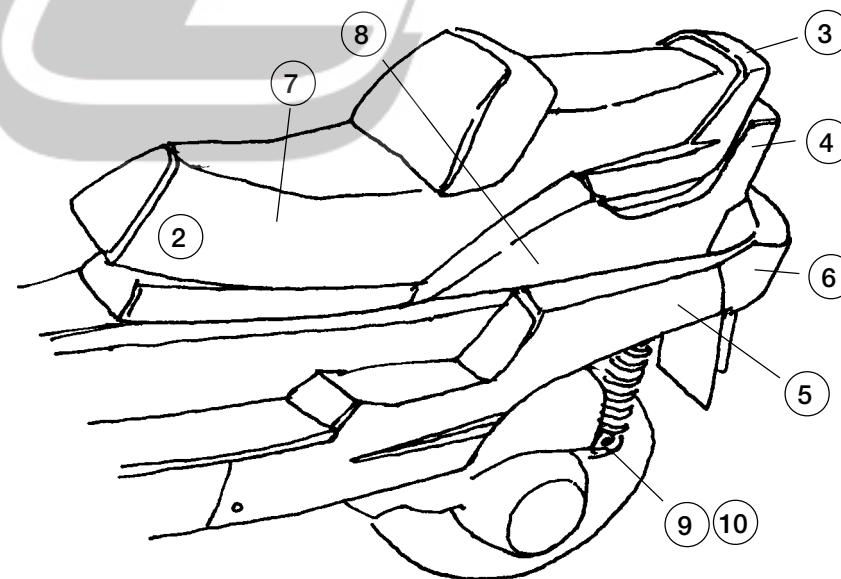

3

Remove the passengers handle/spoiler.

4

Remove the rear duck tail.

11

Reassemble the helmet carrier, motorcycle cover, and other components.