

12

Attach the hydraulic preload adjuster to the wheel side of the right foot rest bracket. Reassemble with the nut provided, M10x1.25.

13

Fit the hose on the backside of the foot rest bracket on the right side of the motorcycle. Fasten the hose with tie raps.

NOTE!

Make sure that all bolts are tightened to the correct torque and that nothing fouls or restricts movement of the shock absorber when the suspension is being fully compressed or extended. Check with the Workshop Manual of the motorbike for correct torque.

14

Reassemble by fitting the silencer, the side panels and the seats.

15

Continue your work according to the Owners Manual, section Adjustments

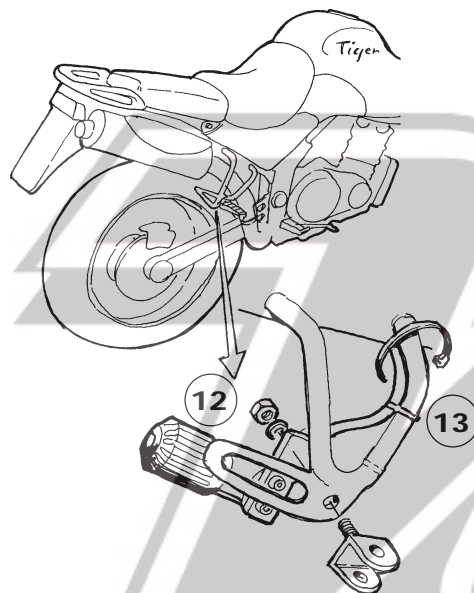

Mounting instructions

TR 852 - TRIUMPH Tiger

Kit contents

Triumph Tiger

1. Shock absorber Type 46PRCS	TR 852	1
2. Nut M10x1.25	00588-01	1
3. Tie rap, l=188	00231-01	2
4. Sticker Öhlins	00192-01	2
5. Sticker Memo note	01180-01	1
6. Owners Manual		1

Set-up data

Length	370 mm
Stroke	69 mm
Rebound adjustment	12
Compression adjustment	10
Preload	18 mm

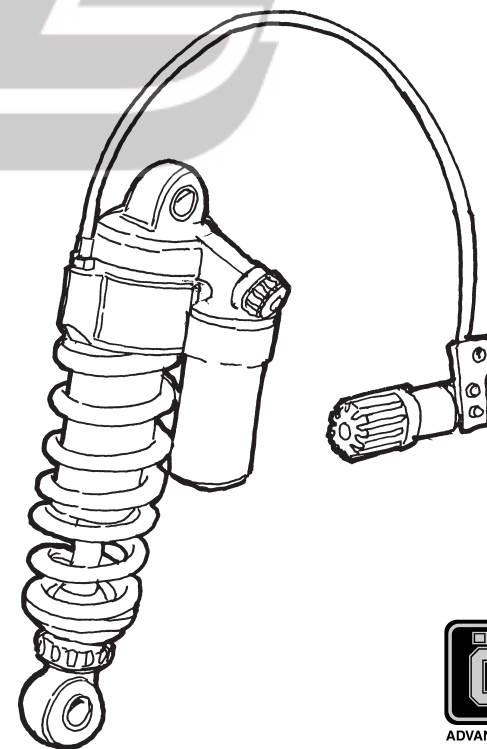

Notes

Traction, handling,
comfort and safety



Öhlins Racing AB, Box 722, S-194 27 Upplands Väsby, Sweden.
Phone +46 8 590 025 00, fax +46 8 590 025 80.

TR 852, ISSUED 99 03 11



Safety signals

Important information concerning safety is distinguished in this manual by the following notations



The Beware sign means:
Pay attention!
Your safety is at risk.

⚠ WARNING!

Failure to follow Warning text could result in **serious or fatal injury** to anyone working with, inspecting or using the suspension, or to bystanders.

CAUTION!

Caution indicates special precautions that must be taken to avoid damage to the suspension.

NOTE!

This indicates information that is of importance with regard to procedures

Kit contents

Before installing the shock absorber kit, please check the contents, listed on the front page of this instruction. If anything is missing, contact your Öhlins dealer.

NOTE!

During storage and transportation, especially at high ambient temperature, the oil and grease used for assembling may run out inside the packing and damage the expanded polystyrene packing material. This is not unusual and is in no way detrimental to the shock absorber.

Before you start

⚠ WARNING!

Installing a shock absorber, that is not approved by the motorcycle manufacturer, may affect the stability of your motorcycle. Öhlins Racing AB can't be held responsible for any personal injury or damage whatsoever which may occur after fitting the shock absorber.

Öhlins Racing AB can not be held responsible for any damage whatsoever to spare parts, or injury to persons, if the instructions for servicing and maintenance are not followed exactly. Similarly, the guarantees relating to performance and reliability will become null and void if the instructions are not adhered to.

⚠ WARNING!

Please study the mounting instructions and the owner's and workshop manuals thoroughly before handling this shock absorber kit.

⚠ WARNING!

When installing the Öhlins shock absorber the motorcycle workshop manual must be at hand.

NOTE!

Öhlins products are subject to continual improvement and development in design and quality. Consequently, although these instructions include the most up-to-date information available at the time of printing, there may be minor differences between your suspension and this manual. Please consult your Öhlins dealer if you have any questions concerning the manual.

Mounting instructions

1

Put the motorcycle on a stand so the rear wheel is off the ground. Make sure it's steadily positioned and will not fall over.

⚠ WARNING!

1. It's advisable to have an Öhlins dealer or other qualified person to fit your shock absorber.
2. Instructions in the motorcycle workshop manual are to be followed when changing the shock absorber.
3. When working on the motorcycle it must be securely supported to prevent it from falling over.

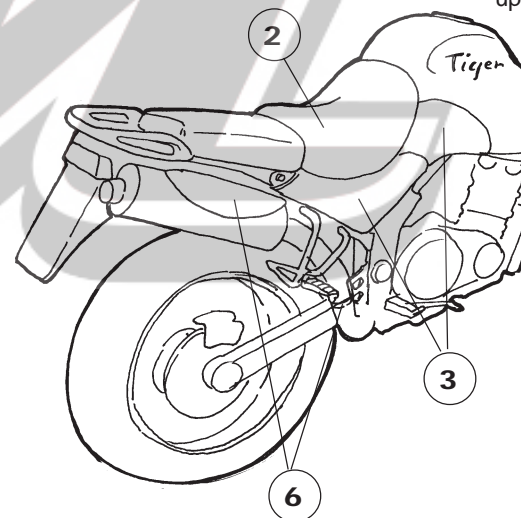

2

Unlock the seat, remove the rear and the front seat.

3

Loosen the front side panels, then the rear ones.

4

Loosen the hydraulic preloader.

5

Loosen first the upper bolt of the original shock absorber.

6

Loosen the silencer bracket and clamp. Remove the silencer.

7

Remove both rubber protectors from the attachment holes in the swing arm.

8

Loosen the nut and screw, holding the shock absorber sleeve, and remove them.

9

Tap the sleeve that holds the shock absorber out long enough to remove the shock absorber. Push it from the right side to the left side.

10

Remove the shock absorber by lifting it upwards, backwards and out to the left.

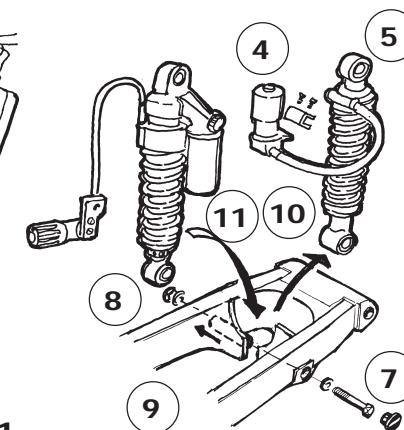

11

Fit the Öhlins shock absorber in reverse order. The piggyback towards right. Fasten it by first attaching the upper bolt, then the lower shaft and bolt.

⚠ WARNING!

Certain modifications are necessary to install the Öhlins shock absorber. It is vital that the mounting instructions are carefully followed.

© Öhlins Racing AB.
All rights reserved.

Any reprinting or unauthorized use without the written permission of Öhlins Racing AB is prohibited.
Printed in Sweden.