

## ADJUSTMENTS

Before riding - always ensure that the basic settings made by Öhlins are intact.

- ① **Spring preload**  
Turn the hexagon screw on the hydraulic adjuster to set the spring preload. Turn clockwise to increase, turn counter clockwise to decrease.
- ② **Rebound**  
Turn the wheel on the piston shaft above the end eye/bracket. Turn clockwise to increase damping, turn counter clockwise to decrease.
- ③ **Compression**  
Adjust by turning the knob on top of the reservoir. Turn clockwise to increase the preload, turn counter clockwise to decrease.

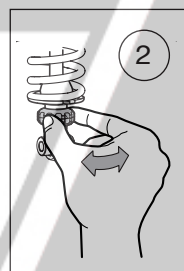
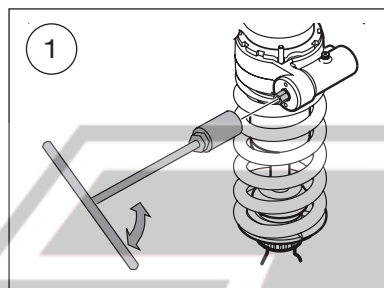

### NOTE!

When delivered the Öhlins shock absorber is dialed to the recommended settings for the specific vehicle model. If you have changed the setting, reset according to the following:

The adjuster has a right hand thread. Turn the adjuster clockwise to fully closed (pos. zero [0]). Turn counter clockwise to open and count the clicks until you reach the recommended number (see Set-up Data).

### CAUTION!

Do not use force, delicate sealing surfaces can be damaged. Handtighten only.

# Mounting instruction

WITH SET-UP DATA

**SHOCK ABSORBER TR704**  
for Triumph Tiger 1050 2007 Rear

Before installing this shock absorber, check the contents of the kit listed below. If anything is missing, please contact your nearest Öhlins dealer.

#### Kit Contents:

	Art. No.	Pcs.
Shock absorber	TR704	1
Sticker "Öhlins" Y/B	00192-01	2
Sticker "Memo Notes"	01180-01	1
Washer	00153-03	2
Nut	00430-04	3
Screw 16 mm	01046-18	2
Screw 22 mm	01046-26	1
Reservoir bracket	05378-10	1
Bracket Tiger 1050	21121-01	1
Owner's Manual		1

#### Set-up data:

Spring preload	16 mm
Rebound damping	12 clicks
Compression damping	12 clicks
Shock absorber length	350 <sup>±8</sup> mm
Stroke	62,5 mm
Free spring length	180 mm
	120 N/mm

During storage and transportation, especially at high ambient temperature, some of the oil and grease used for assembling may leak and stain the packaging. This is in no way detrimental to the product, wipe off the excessive oil/grease with a cloth.

Before installing this product, read the Öhlins Owner's Manual!



© Öhlins Racing AB. All rights reserved.  
Any reprinting or unauthorized use without the written permission of Öhlins Racing AB is prohibited. Printed in Sweden.



Mounting Instruction TR704.  
Issued 2008-02-15 Öhlins Racing AB/ AnAs.  
This instruction and other documents can be downloaded from [www.ohlins.com](http://www.ohlins.com)

## HOW TO INSTALL

### ⚠ WARNING!

It is advisable to have an Öhlins dealer to install the shock absorber kit. Refer to your vehicle service manual when installing this product.

#### 1.

Put the motorcycle on a workstand and raise it so that the rear wheel barely touch the ground.

### ⚠ WARNING!

Make sure the vehicle is securely supported so that it will not tip.

#### 2.

Remove the seat and the middle side covers.

#### 3.

Remove the passenger handles and the rear side covers.

#### 4.

Remove the screws for the rear bracket holding the silencer.

#### 5.

Remove the lower attachment and loosen the upper attachment for the rear subframe.

#### 6.

Raise the motorcycle so it will be more space between the wheel and the mud guard.

#### 7.

Loosen the upper and lower shock absorber attachments.

#### 8.

Lift the rear subframe upwards and remove the original shock absorber.

### NOTE!

Before installing the Öhlins shock absorber:

- Clean the vehicle thoroughly
- Adjust the length of the shock absorber (check the headlight angle after adjusting the length!)

#### 9.

Install the ÖHLINS shock absorber: Install the Öhlins shock absorber with the reservoir pointing at the rear. The hose must go between the upper and lower attachments for the rear subframe, before taking it down. Do not tighten yet.

10. Install the reservoir with the supplied brackets according to figure. Make sure that the hoses doesn't get any damages.

11. Lower your bike slightly and tighten all screws.

### NOTE!

Make sure that all screws are tightened to the correct torque and that nothing fouls or restricts movement of the shock absorber when the suspension is being fully compressed or extended.

12. Reinstall every part in reverse order.

## HOW TO INSTALL

