

10

Loosen the triangle link from the rear swing attachment. Loosen the lower shock absorber bracket. Let the triangle link still be attached to the frame.

11

Loosen the upper shock absorber attachment and remove it upwards and take it out to the left side of the motorcycle.

12

Position the Öhlins shock absorber from the left and down into the rear swing. Fit first the upper bracket, then attach it to the triangle link. Attach the triangle link to the pull rods.

NOTE!

Make sure that all bolts are tightened to the correct torque and that nothing fouls the shock absorber when the suspension is being fully compressed or extended. See the Workshop handbook of the motorcycle for correct readings

13

Mount the hydraulic preloader to the silencer bracket with supplied bolt (MC6S 8x50) Fit the hose and fix it with the supplied tie raps.

15

Reassemble the parts removed from the motorcycle.

14

Continue your work according to the Owners Manual, section adjustments.

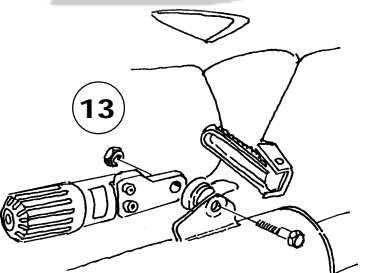
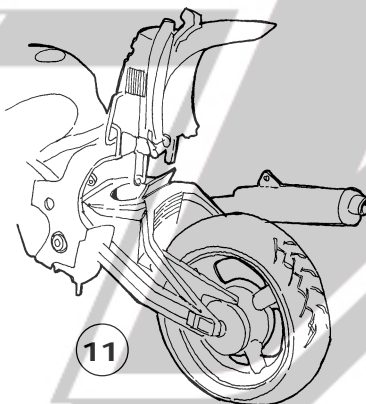
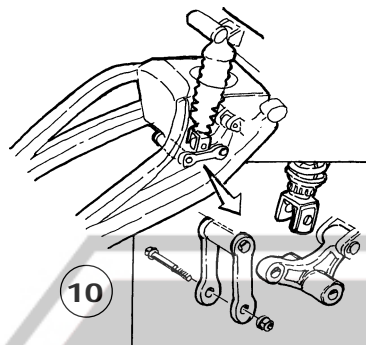

Mounting instructions

SU 841 - SUZUKI GSX 1300 R Hayabusa

Kit contents

| | | |
|----------------------------|----------|---|
| Shock absorber Type 46PRCS | SU841 | |
| Sticker Öhlins | 00192-01 | 2 |
| Bolt MC6S 8x50 | 01046-25 | 1 |
| Tie-rap l=188 | 00231-01 | 3 |
| Sticker Memo Notes | 01180-01 | 1 |
| Owners manual | | 1 |

Set-up data

| | |
|------------------------|-------|
| Length | 330 |
| Stroke | 72 mm |
| Preload spring | 12 mm |
| Compression adjustment | 10 |
| Rebound adjustment | 12 |

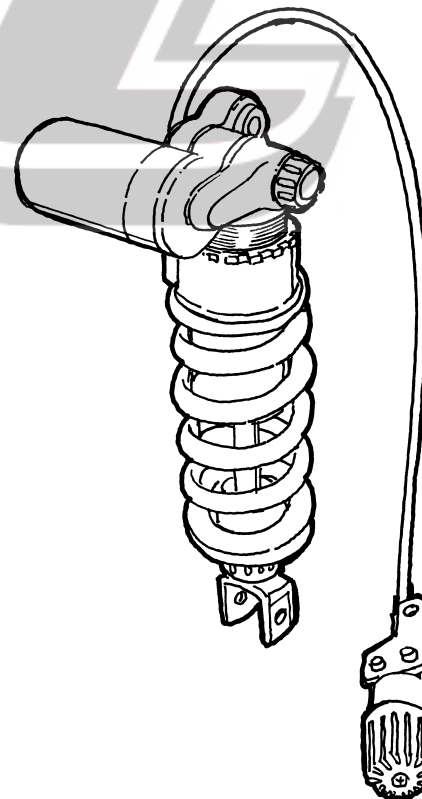

Traction, handling,
comfort and safety



Öhlins Racing AB, Box 722, S-194 27 Upplands Väsby, Sweden.
Phone +46 8 590 025 00, fax +46 8 590 025 80.

SU 841, ISSUED 99 03 08



Safety signals

Important information concerning safety is distinguished in this manual by the following notations



The Beware sign means:
Pay attention!
Your safety is at risk.

⚠ WARNING!

Failure to follow Warning text could result in **serious or fatal injury** to anyone working with, inspecting or using the suspension, or to bystanders.

CAUTION!

Caution indicates special precautions that must be taken to avoid damage to the suspension.

NOTE!

This indicates information that is of importance with regard to procedures

Kit contents

Before installing the shock absorber kit, please check the contents, listed on the front page of this instruction. If anything is missing, contact your Öhlins dealer.

NOTE!

During storage and transportation, especially at high ambient temperature, the oil and grease used for assembling may run out inside the packing and damage the expanded polystyrene packing material. This is not unusual and is in no way detrimental to the shock absorber.

Before you start

⚠ WARNING!

Installing a shock absorber, that is not approved by the motorcycle manufacturer, may affect the stability of your motorcycle. Öhlins Racing AB can't be held responsible for any personal injury or damage whatsoever which may occur after fitting the shock absorber.

Öhlins Racing AB can not be held responsible for any damage whatsoever to spare parts, or injury to persons, if the instructions for servicing and maintenance are not followed exactly. Similarly, the guarantees relating to performance and reliability will become null and void if the instructions are not adhered to.

⚠ WARNING!

Please study the mounting instructions and the owner's and workshop manuals thoroughly before handling this shock absorber kit.

⚠ WARNING!

When installing the Öhlins shock absorber the motorcycle workshop manual must be at hand.

NOTE!

Öhlins products are subject to continual improvement and development in design and quality. Consequently, although these instructions include the most up-to-date information available at the time of printing, there may be minor differences between your suspension and this manual. Please consult your Öhlins dealer if you have any questions concerning the manual.

Mounting Instructions

1

Put the motorcycle on a stand so that the rear wheel is clear of the ground. Make sure it is fixed so it will not fall over.

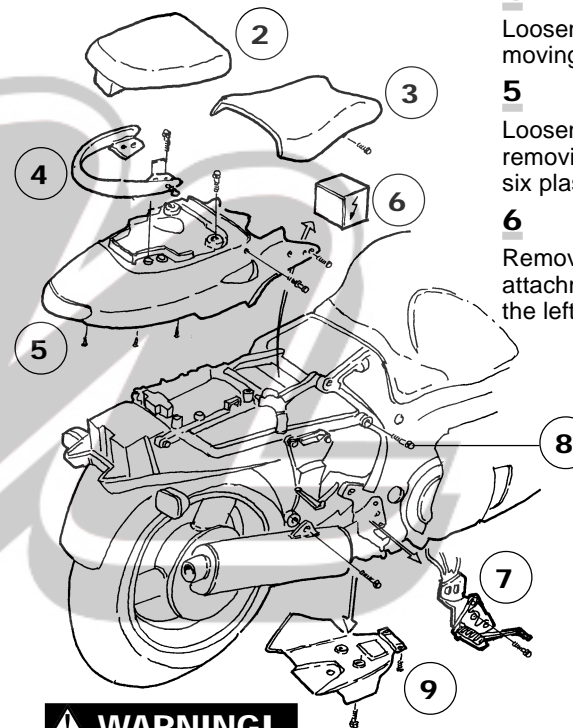

⚠ WARNING!

1. It's advisable to have an Öhlins dealer or other qualified person to fit your shock absorber.
2. Instructions in the motorcycle workshop manual are to be followed when changing the shock absorber.
3. When working on the motorcycle it must be securely supported to prevent it from falling over.

NOTE!

When removing the shock absorber it's necessary to make a considerably lift the rear end of the motorcycle. This must be made by a steady lifting device, able to lift at least 200 kg.

2

Open the rear seat lock and remove the seat.

3

Loosen the two bolts holding the front seat and remove it.

4

Loosen the passenger handle bar by removing the four bolts.

5

Loosen and remove the rear end cover by removing the six attachment bolts and the six plastic fasteners.

6

Remove the battery. Remove the bolt and attachment holding the electrical wires on the left side.

7

Loosen the right side foot rest bracket by removing the three bolts. Let it hang loose in the brake hoses.

8

Loosen the Rear frame bolts. Remove the lower ones and turn the rear frame up as far as possible.

9

Loosen the lower cover plate under the swing.

NOTE!

Check that the brake reservoir or electrical wires not fouls the lift of the rear frame.

© Öhlins Racing AB.
All rights reserved.

Any reprinting or unauthorized use without the written permission of Öhlins Racing AB is prohibited.
Printed in Sweden.