

# Adjustments

## ⚠ Warning!

Before riding, always make sure that the basic settings made by Öhlins are according to recommended Set-up Data. Read about adjustments and setting up in the Öhlins Owner's Manual before you make any adjustments. Contact an Öhlins dealer if you have any questions about setting up the shock absorber.

Öhlins Shock Absorber S46DR1LS SU 813

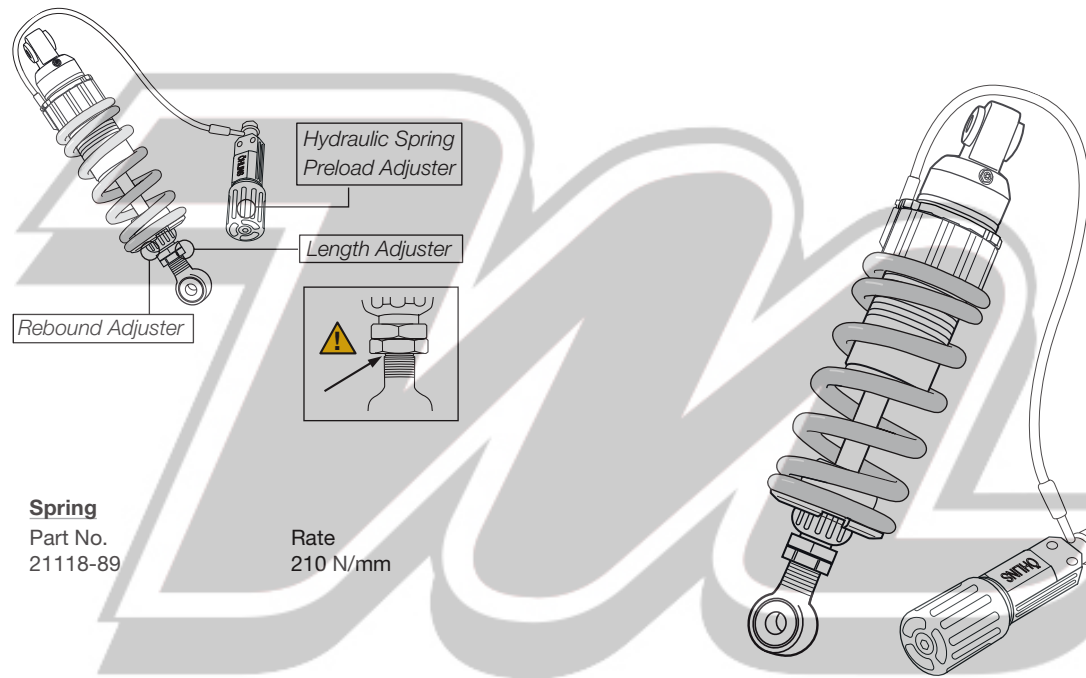

# Set-up Data

## Recommended setting

Spring Preload	12 mm
Rebound	16 clicks
Length	323.5 <sup>+0</sup> / <sub>-12</sub>
Length Adjuster Lock Nut	
Tightening torque	40 Nm

## Spring

Part No.	Rate
21118-89	210 N/mm

Before installing this product, check the contents of the kit. If anything is missing, please contact your nearest Öhlins dealer.

## Kit Contents

	Part No.	Pcs.
Shock abs. S46DR1LS	SU 813	1
Bracket	20029-01	1
Screw MC6S	01046-01	2
Sticker transp/black	00191-13	2
Sticker transp/white	00191-20	2
Memo Notes Sticker	01180-01	1
Owner's Manual	07241-02	1

Please note that during storage and transportation, especially at high ambient temperature, some of the oil and grease used for assembling may leak and stain the packaging. This is in no way detrimental to the product, wipe off the excessive oil/grease with a cloth.

## ⚠ Warning!

Before installing this product, read the Öhlins Owner's Manual. The shock absorber is an important part of your vehicle and may affect the stability of your vehicle.

Öhlins products are subject to continuous improvement and development, therefore, although these instructions include the most up-to-date information available at the time of printing, minor updates may occur.

To find the latest information contact your Öhlins distributor. Please consult your Öhlins dealer if you have any questions regarding the contents in this document.

Part no. SU\_813\_0  
Issued 2008-08-28



# Shock Absorber for Suzuki C1800R SU 813

## Mounting Instructions

© Öhlins Racing AB. All rights reserved.  
Any reprinting or unauthorized use without the written permission of Öhlins Racing AB is prohibited.

Öhlins Racing AB  
Box 722  
S-194 27 Upplands Väsby, Sweden  
Phone +46 8 590 025 00  
fax +46 8 590 025 80



[www.ohlins.com](http://www.ohlins.com)



## ⚠ Warning!

It is advisable to have an Öhlins dealer install the shock absorber.

When installing, consult your Vehicle Service Manual.

### 1

Put the motorcycle on a workstand so that the rear wheel barely touches the ground.

## ⚠ Warning!

Make sure that the vehicle is securely supported so that it will not tip.

### 2

Remove the shock absorber cover.

### 3

Remove the cover and side panels.

### 4

Remove the original shock absorber.

## 👁 Note!

Before installing the Öhlins shock absorber:

- clean the vehicle thoroughly
  - adjust the length of the shock absorber
- Check the headlight angle after adjusting the length of the shock absorber!

VEHICLE SERVICE MANUAL

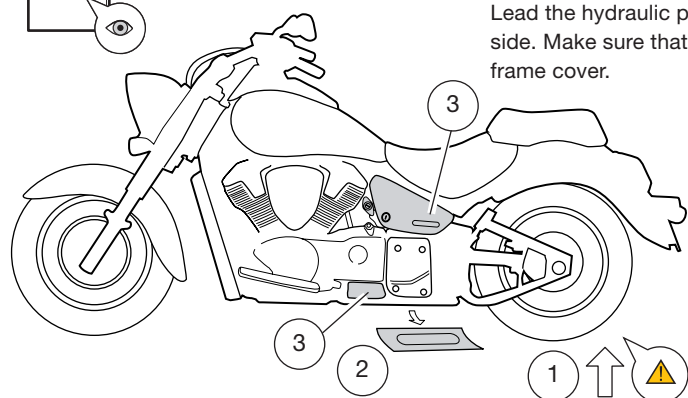

### 5

Install the Öhlins shock absorber, with the oil filling screw at the top and towards the front. Lead the hydraulic preload adjuster to the right side of the vehicle and leave it for now.

5 View from the left side

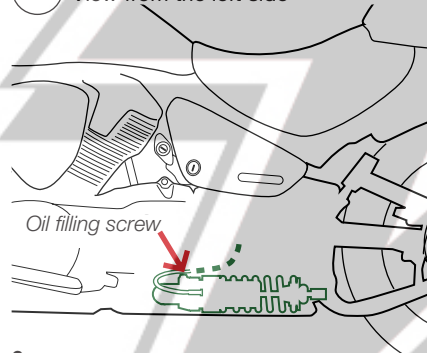

### 6

Fasten the front and the rear attachments. Do not tighten yet.

## 👁 Note!

Lower the motorcycle so that the shock absorber is slightly compressed, before tightening the screws.

### 7

Tighten the front and the rear attachments. Remove the ignition lock.

### 8

Lead the hydraulic preload adjuster to the left side. Make sure that the hose runs inside the frame cover.

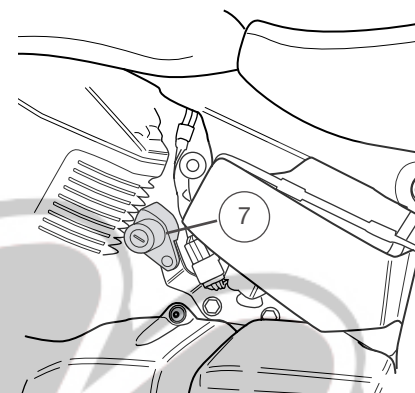

View from the right side

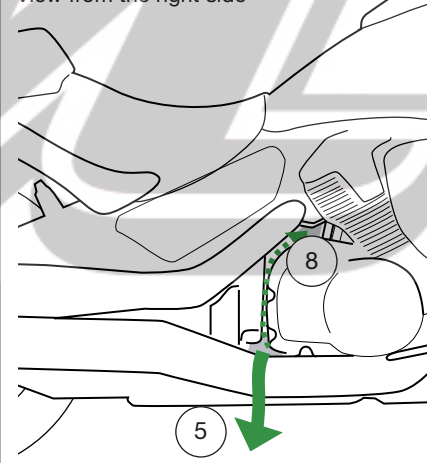

### 9

Fasten the bracket, provided in this kit, to the hydraulic preload adjuster.

### 10

Fasten the hydraulic preload adjuster with the bracket to the engine cover screw.

## 👋 Caution!

Make sure that the hydraulic preload adjuster hose runs in soft bends. Also check that it does not come in contact with the exhaust pipe or any sharp edges.

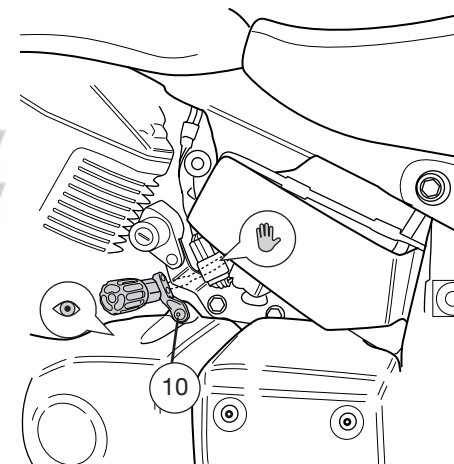
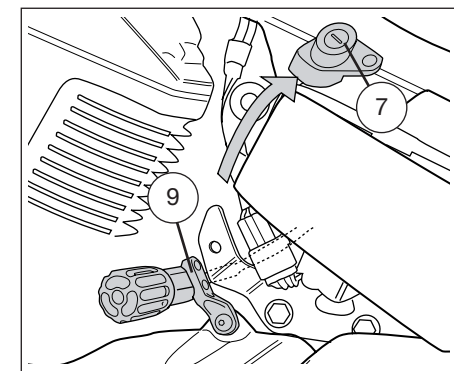

## 👁 Note!

Make sure that the distance between the engine cover and the hydraulic preload adjuster is big enough so that you can adjust the preload.

### 11

Make sure that all removed parts are reinstalled in the same way they were before the installation of the Öhlins shock absorber.

## 👋 Caution!

Make sure that all screws are tightened to the correct torque and that nothing fouls or restricts movement of the shock absorber when the suspension is fully compressed or extended.