

Owners Manual

Mounting instructions Öhlins shock absorber kit MG 127 for Moto Guzzi V11 sport

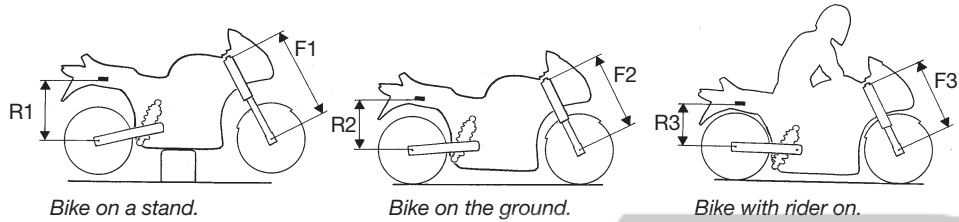

Setup data

Shock absorber length	286 mm
Shock absorber stroke	70 mm
Spring preload	15 mm
Rebound damping adjuster	14 clicks
Compression damping adjuster	12 clicks

Checking sag and ride height

Front suspension

- F1. Bike on a stand with the suspension fully extended =
- F2. Bike on the ground without rider =
- F3. Bike on the ground with rider =

Free sag $F1 - F2 = \dots\dots\dots$

Ride height $F1 - F3 = \dots\dots\dots$

Rear suspension

- R1. Bike on a stand with the suspension fully extended =
- R2. Bike on the ground without rider =
- R3. Bike on the ground with rider =

Free sag $R1 - R2 = \dots\dots\dots$

Ride height $R1 - R3 = \dots\dots\dots$

NOTE!

*If ride height is higher than recommended, softer spring/springs must be used.
If ride height is lower than recommended, harder spring/springs must be used.
Contact your Öhlins dealer for advice.*



Öhlins shock absorber 46 HRCS

Your new Öhlins shock absorber features the following adjustments:

- Compression damping adjustment
- Rebound damping adjustment
- Hydraulic spring preload adjustment

Compression damping:

Adjustments are made on top of the reservoir. Low speed adjustments: Slotted centre screw. High speed adjustments: Hexagon screw.

Rebound damping

Adjuster wheel on the piston shaft above the end bracket.

Hydraulic spring preload

Adjustments are made by turning the knob on the hydraulic adjuster. Clockwise for harder adjustment, counter clockwise to release the preload.

When delivered the Öhlins shock absorber is dialed to recommended settings for the specific brand and make of the motorcycle. If you have changed the setting check like this:

The adjusters have a normal right hand tread. Turn clockwise to fully closed. Turn counter clockwise to open and count the clicks until you reach the recommended number of clicks.

Do not use too much force, delicate sealing surfaces can be damaged. Do use fingers only.



Safety signals

Important information concerning safety is distinguished in this manual by the following notations:



**The Safety alert symbol means:
Caution! Your safety is involved.**

⚠ WARNING!

Failure to follow warning instructions could result in severe or fatal injury to anyone working with, inspecting or using the suspension, or to bystanders.

CAUTION!

Caution indicates that special precautions must be taken to avoid damage to the suspension.

NOTE!

This indicates information that is of importance with regard to procedures.

Before installation

Öhlins Racing AB can not be held responsible for any damage whatsoever to shock absorber or vehicle, or injury to persons, if the instructions for fitting and maintenance are not followed exactly.

Similarly, the warranty will become null and void if the instructions are not adhered to.

⚠ WARNING!

1. Installing a shock absorber, that is not approved by the vehicle manufacturer, may affect the stability of your vehicle. Öhlins Racing AB cannot be held responsible for any personal injury or damage whatsoever that may occur after fitting the shock absorber. Contact an Öhlins dealer or other qualified person for advice.

2. Please study and make certain that you fully understand all the mounting instructions and the owners manuals before handling this shock absorber kit. If you have any questions regarding proper installation procedures, contact an Öhlins dealer or other qualified person.

3. The vehicle service manual must be referred to when installing the Öhlins shock absorber

Öhlins products are subject to continual improvement and development. Consequently, although these instructions include the most up-to-date information available at the time of printing, there may be minor differences between your suspension and this manual. Please consult your Öhlins dealer if you have any questions with regard to the contents of the manual.

NOTE!

During storage and transportation, especially at high ambient temperature, the oil and grease used for assembling may run out inside the packing and damage the expanded polystyrene packing material. This is not unusual and is in no way detrimental to the shock absorber.

Kit contents

Before installing the shock absorber, please check the contents of the kit, listed on the front page of this instruction. If anything is missing, contact your Öhlins dealer.

Description	Pcs.	Part No.
Shock absorber	1	MG 127
Washer	1	00426-02
Tie rap	2	00231-01
Sticker Öhlins	2	00192-01
Sticker memo notes	1	01180-01
Owners manual	1	

Mounting instruction

1

Put the motorcycle on the centre stand.

⚠ WARNING!

1. It's advisable to have an Öhlins dealer or other qualified person to fit your shock absorber.
2. Instructions in the vehicle service manual are to be followed when changing the shock absorber.
3. When working on a lifted vehicle it must be securely supported to prevent it from falling.

2

Remove the seat, by unlocking it and remove the rear plastic cover (6 screws).

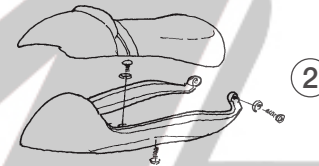

3

Loosen and remove the fuel line (left side) and return line (right side) from the fuel tank. Loosen the air hose from the underside of the tank. Loosen the electrical connection and remove the tank by lifting it rearwards up.

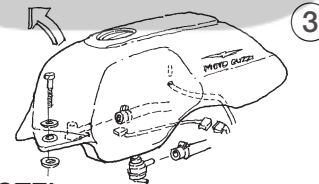

NOTE!

It is advisable to fit a stopping device into the fuel lines to avoid petrol waste

4

Remove the air filter unit by loosening the attachment screws (4), the intake hoses from the injection units and loosen the hose end the electrical connection

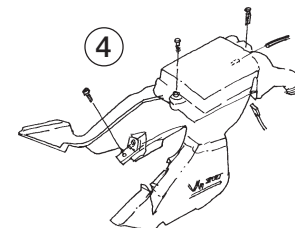

5

Loosen the original shock absorber from the rear and forward attachments.

6

Attach the Öhlins shock absorber in reverse order. Use the standard bolts. The gas reservoir is positioned in the same bracket as the original reservoir.

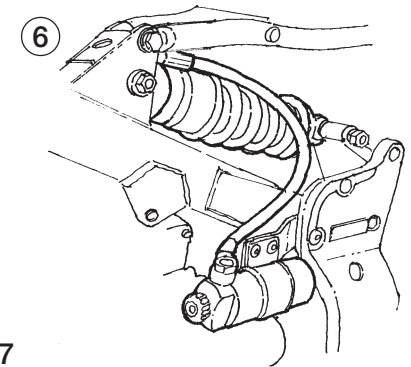

7

The hydraulic preload adjuster is to be attached to the silencer bracket on the right side of the motorcycle. Use the original bolts and the washer provided so the bracket will be in line with the frame. Let the hose go in soft turns on the inside of the frame and attach it with the tie rap.

7

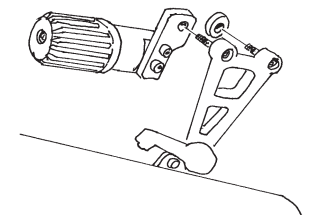

8

Put the air filter unit back and attach it to the injection units. Remember to refit the hose and the electrical connection.

9

Refit the cover behind the reservoir and put the fuel tank back. Connect the fuel lines and the electrical connection. And fix the fuel tank with the original bolt.

10

Refit the rear cover and the seat.

11

Continue your work according to the Owners Manual