

## ADJUSTMENTS

### 1 Spring Preload

Turn the hydraulic adjuster knob to set the spring preload. Turn clockwise to *increase* the preload and turn counter clockwise to *decrease*.

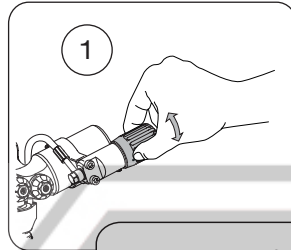

### 2 Compression Damping

Adjust by turning the gold knob labelled "COMP" on the cylinder head (1). Or, use a 14 mm socket T-bar and turn the hexagon nut on the adjuster knob (2). Turn clockwise to increase damping, turn counter clockwise to decrease.

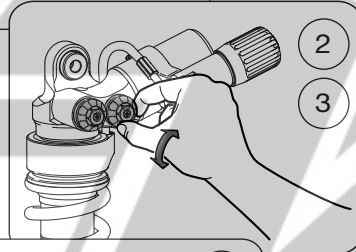

### 3 Rebound Damping

Adjust by turning the black knob labelled "REB" on the cylinder head (1). Or, use a 14 mm socket T-bar and turn the hexagon nut on the adjuster knob (2). Turn clockwise to *increase* damping, turn counter clockwise to *decrease* damping.

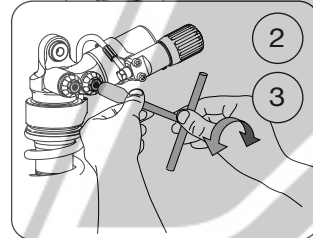

### NOTE!

When delivered the Öhlins shock absorber is dialed to the recommended settings for the specific vehicle model. If you have changed the setting, reset according to the following:

The adjuster has a right hand thread. Turn the adjuster clockwise to fully closed (pos. zero [0]). Turn counter clockwise to open and count the clicks until you reach the recommended number. See **Set-up Data**.

### CAUTION!

Do not use force, delicate sealing surfaces can be damaged. Handtighten only.

### 4 Length Adjustment

We advise to remove the shock absorber from the vehicle before adjusting the length. Use two 24 mm wrenches. Hold the upper nut with one hand and at the same time loosen the lock nut (lower nut). Turn the end eye/bracket to the desired length. Tightening torque 40 Nm.

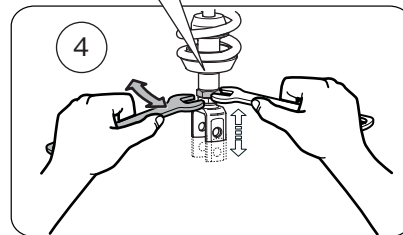
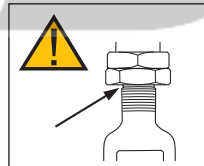

### WARNING!

Remember to lock the lock nut after adjusting the length.

### WARNING!

The adjustable end eye/bracket must not be threaded out more than that the groove is fully visible beneath the lock nut. This is maximum length. After adjusting, make sure that the lock nut is tightened.

# Mounting Instruction

WITH SET-UP DATA

## SHOCK ABSORBER KA789 for Kawasaki ZX6R

Before installing this shock absorber, check the contents of the kit listed below. If anything is missing, please contact your nearest Öhlins dealer.

### Kit Contents:

	Part No.	Pcs.
Shock absorber	KA789	1
Tie-wrap	00231-01	3
Washer	00153-01	1
Nut M8	00430-05	1
Screw M8x35	00432-01	1
Öhlins Sticker	00192-01	2
Memo Notes Sticker	01180-01	1
Owner's Manual	07242-01	1

During storage and transportation, especially at high ambient temperature, some of the oil and grease used for assembling may leak and stain the packaging. This is in no way detrimental to the product, wipe off the excessive oil/grease with a cloth.

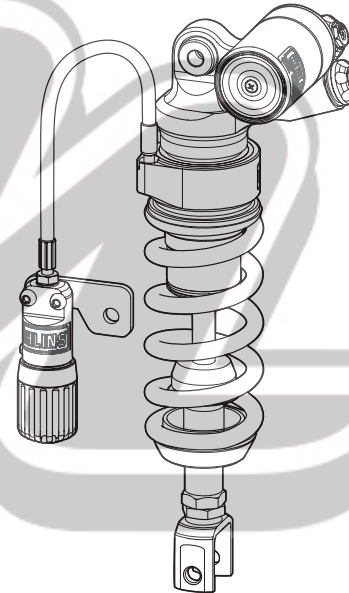

### Set-up Data

Spring preload	13 mm
Compression	12 clicks
Rebound damping	13 clicks

Shock absorber length	340 $^{+6}$ mm
Stroke	67 mm
Spring	21040-31 (95 N/mm)
Free spring length	160 $^{-3}$ mm

Before installing this product, read the Öhlins Owner's Manual!



## HOW TO INSTALL

### ⚠ WARNING!

It is advisable to have an Öhlins dealer install the shock absorber.

1

Put the motorcycle on a workstand so that the rear wheel barely touches the ground.

### ⚠ WARNING!

Make sure the vehicle is securely supported so that it will not tip.

2

Remove the lower covers.

3

Remove the lower and the upper screws of the original shock absorber.

### ⚠ WARNING!

Do not remove the original ride height washers!

4

Remove the original shock absorber from the left side of the vehicle.

### NOTE!

Recommendation! Before installing the Öhlins shock absorber:

- Clean the vehicle thoroughly
- Adjust the length of the shock absorber (check the headlight angle after adjusting the length!)

5

Install the Öhlins shock absorber. First, fasten the upper screw, then the lower. Use the original screws, do not tighten yet.

### NOTE!

Lower the motorcycle so that the shock absorber is slightly compressed, before tightening the screws.

6

Tighten the upper and the lower screws.

7

Reinstall the lower covers.

8

Install the hydraulic preload adjuster to the left passenger foot peg rear attachment point. Replace the original screw with the enclosed screw. Fasten the hose with the tie-raps provided in this kit.

### NOTE!

Make sure that nothing interferes with the hose and the adjuster when the rear wheel suspension is fully extended/compressed.

## HOW TO INSTALL

9

Read more about the shock absorber and its settings in your Öhlins Owner's Manual.

### ⚠ WARNING!

Make sure that all screws are tightened to the correct torque and that nothing fouls or restricts movement of the shock absorber when the suspension is fully compressed or extended.

### NOTE!

Before riding, always ensure that the basic settings made by Öhlins are intact.

