

ADJUSTMENTS

1 Spring Preload

Turn the hydraulic adjuster knob to set the spring preload. Turn clockwise to *increase* the preload and turn counter clockwise to *decrease*.

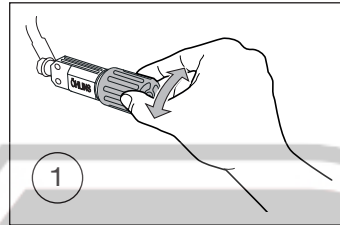

2 Compression Damping

Adjust on top of the reservoir.
High speed: Turn the blue hexagon screw.
Low speed: Turn the slotted centre screw.
Turn clockwise to *increase* damping, turn counter clockwise to *decrease*.

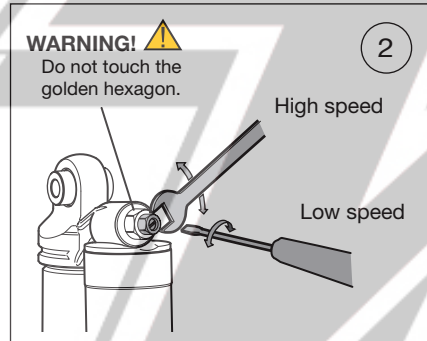

3 Rebound Damping

Turn the wheel on the piston shaft above the end eye/ bracket. Turn clockwise to *increase* damping, turn counter clockwise to *decrease*.

NOTE!

When delivered the Öhlins shock absorber is dialed to the recommended settings for the specific vehicle model. If you have changed the setting, reset according to the following:

The adjuster has a right hand thread. Turn the adjuster clockwise to fully closed (pos. zero [0]). Turn counter clockwise to open and count the clicks until you reach the recommended number. See **Set-up Data**.

CAUTION!

Do not use force, delicate sealing surfaces can be damaged. Handtighten only.

4 Length Adjustment

We advise to remove the shock absorber from the vehicle before adjusting the length. Use two 24 mm wrenches. Hold the upper nut with one hand and at the same time loosen the lock nut (lower nut). Turn the end eye/bracket to the desired length. Tightening torque 40 Nm.

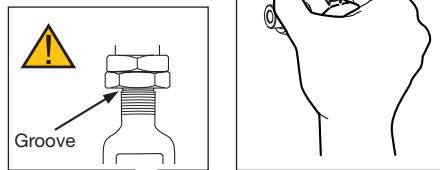

WARNING!

Remember to lock the lock nut after adjusting the length.

WARNING!

The adjustable end eye/bracket must not be threaded out more than that the groove is fully visible beneath the lock nut. This is maximum length. After adjusting, make sure that the lock nut is tightened.

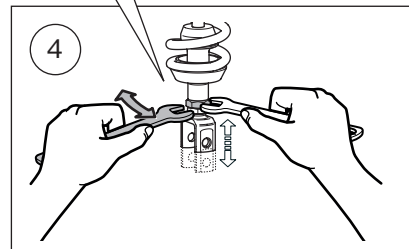

Mounting Instruction

WITH SET-UP DATA

SHOCK ABSORBER KA734 for Kawasaki Z1000 -07 Rear

Before installing this shock absorber, check the contents of the kit listed below. If anything is missing, please contact your nearest Öhlins dealer.

Kit Contents:

	Part No.	Pcs.
Shock absorber	KA734	1
Washer	00426-04	2
Nut M6	00430-02	1
Screw M6x25	05404-06	1
Öhlins Sticker	00192-01	2
Memo Notes Sticker	01180-01	1
Owner's Manual		1

During storage and transportation, especially at high ambient temperature, some of the oil and grease used for assembling may leak and stain the packaging. This is in no way detrimental to the product, wipe off the excessive oil/grease with a cloth.

Set-up Data

Spring preload	8 mm
Rebound damping	16 clicks
Compression damping <i>High speed</i>	35 clicks
Compression damping <i>Low speed</i>	15 clicks

Shock absorber length	332,5 ⁺¹² ₀ mm
Stroke	67 mm
Spring	01091-34 (100 N/mm)
Free spring length	160 mm

Before installing this product, read the Öhlins Owner's Manual!



Öhlins Racing AB, Box 722, S-194 27 Upplands Väsby, Sweden.
Phone +46 8 590 025 00 Fax +46 8 590 025 80
www.ohlins.com

HOW TO INSTALL

⚠ WARNING!

It is advisable to have an Öhlins dealer install the shock absorber.

1

Put the motorcycle on a workstand so that the rear wheel barely touches the ground.

⚠ WARNING!

Make sure the vehicle is securely supported so that it will not tip.

2

Loosen the lower attachment of the original shock absorber and the upper attachment of the pull link.

3

Let the pull link hang loose.

4

Loosen the upper attachment of the original shock absorber and remove the original shock absorber downwards.

NOTE!

Recommendation! Before installing the Öhlins shock absorber:

- Clean the vehicle thoroughly
- Adjust the length of the shock absorber (check the headlight angle after adjusting the length!)

5

Install the Öhlins shock absorber:
Lead the hydraulic preload adjuster and let it hang out on the left side of the vehicle. Install the new shock absorber in reverse order. Do not tighten yet.

NOTE!

Lower the motorcycle so that the shock absorber is slightly compressed, before tightening the screws.

6

Tighten the upper and the lower attachments of the shock absorber and the upper pull link attachment.

7

Install the hydraulic spring preload adjuster on the frame on the left side of the vehicle according to figure. Use the enclosed screw, washers and nut.

NOTE!

Make sure that nothing interferes with the hose and the adjuster when the rear wheel suspension is fully extended/compressed.

NOTE!

Before riding, always ensure that the basic settings made by Öhlins are intact.

⚠ WARNING!

Make sure that all screws are tightened to the correct torque and that nothing fouls or restricts movement of the shock absorber when the suspension is fully compressed or extended.

8

Read more about the shock absorber and its settings in your Öhlins Owner's Manual.

HOW TO INSTALL

