

ADJUSTMENTS

Always ensure that the basic settings made by Öhlins are intact.

- 1 **Spring Preload**
Turn the knob on the hydraulic preload adjuster to set the spring preload. Turn clockwise to increase the preload, turn counter clockwise to decrease.

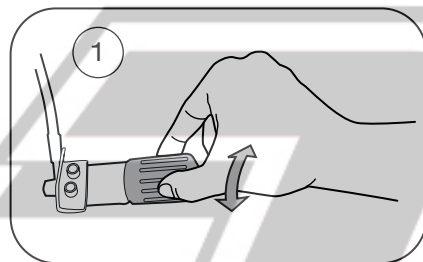

- 2 **Rebound**
Turn the wheel on the piston shaft above the end eye/bracket. Turn clockwise to increase damping, turn counter clockwise to decrease.

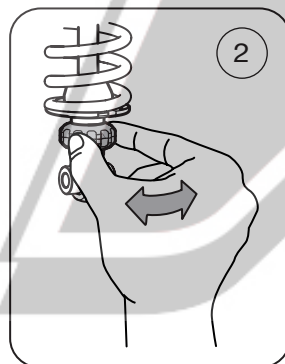

Mounting Instruction

WITH SET-UP DATA

Shock absorber HO809
Honda CBF 600SA 2007-2008

Before installing this shock absorber, check the contents of the kit listed below. If anything is missing, please contact your nearest Öhlins dealer.

Kit Contents:

	Art. No.	Pcs
Shock absorber	HO809	1
Tie-rod	00231-01	2
Sticker "ÖHLINS"	00192-01	2
Sticker "Memo notes"	01180-01	1
Owners manual		1

Set-up data:

Shock absorber length	310 mm
Stroke	45,5 mm
Spring preload	10 mm
Spring free length	170 mm, 200 N/mm
Rebound adjustment	16 clicks

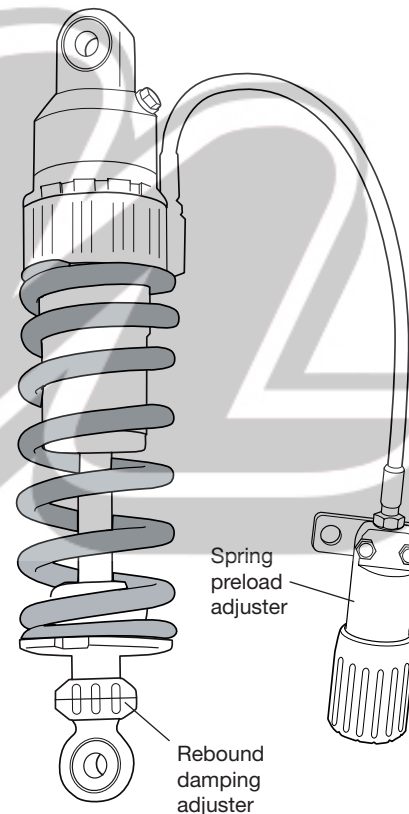

During storage and transportation, especially at high ambient temperature, some of the oil and grease used for assembling may leak and stain the packaging. This is in no way detrimental to the product, wipe off the excessive oil/grease with a cloth.

Before installing this product, read the Öhlins Owner's Manual!

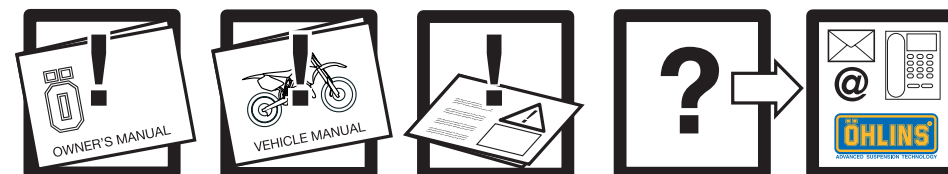

© Öhlins Racing AB. All rights reserved.
Any reprinting or unauthorized use without the written permission of Öhlins Racing AB is prohibited.
Printed in Sweden.



Mounting Instruction HO809 2008-05-28.
This instruction and other documents can be downloaded from www.ohlins.com

HOW TO INSTALL

⚠ WARNING!

It is advisable to have an Öhlins dealer to install the shock absorber. Refer to your vehicle service manual when installing this product.

1. Put the bike on a workstand so that the rear wheel is off the ground and so that you safely can work on it.

⚠ WARNING!

Make sure the vehicle is securely supported so that it will not tip.

2. Remove the seats and left side cover.

3. Remove the shock mounting bolts and remove the standard shock absorber.

NOTE!

Before installing the Öhlins shock absorber:

- Clean the vehicle thoroughly
- Adjust the length of the shock absorber (check the headlight angle after adjusting the length!)

4. Put the Öhlins shock absorber in place with the preload adjuster on the right side of the bike.

5. Reinstall the shock mounting bolts.

6. Put the bike on the ground so that the rear wheel is loaded; tighten shock bolts to the correct torque according to the Honda specification cards.

7. Fit the preload adjuster on the right side at the silencer bracket according to figure.

⚠ WARNING!

Make sure that the hydraulic preload adjuster hose runs in soft bends. Also check that it does not come in contact with the exhaust pipe or any sharp edges.

8. Check that all bolts are tightened and that there are no clearance problems when the rear suspension is fully extended or compressed.

NOTE!

Make sure that all screws are tightened to the correct torque and that nothing fouls or restricts movement of the shock absorber when the suspension is being fully compressed or extended.

HOW TO INSTALL

