

Note!

Before installing this product, check the contents of the kit. If anything is missing, please contact an Öhlins dealer

Kit Contents

Description	Part No	Pcs
Shock absorber	HO 611	1
Clamp bracket reservoir	03102-15	1
Bracket support	60006-13	1
Cable tie	60231-01	1
Screw M6x12	01046-36	2
Screw M6x14	00382-16	1
Screw M6x45	01046-62	2
Washer 6.3/10/1.2	60426-04	1
Sticker Öhlins	00192-01	2
Sticker Öhlins	01185-01	2
Sticker Öhlins	01185-04	2
C-spanner	60710-01	2
Owner's manual	07241-02	1
Alternative component		
Spring 110 N/mm	60282-06	1

Note!

Please note that this image is a general representation of the product and may differ slightly from your product.

Note!

Please note that during storage and transportation, especially at high ambient temperature, some of the oil and grease used for assembling may leak and stain the packaging. This is in no way detrimental to the product, wipe off the excessive oil/grease with a cloth.

Warning!

Before installing this product, read the Öhlins Owner's Manual. The shock absorber is an important part of your vehicle and will affect the stability.

Shock Absorber for HONDA MSX 125 SF-2016

HO 611

Mounting Instructions



MOUNTING INSTRUCTIONS

⚠ Warning!

It is advisable to have an Öhlins dealer install the shock absorber.

⚠ Warning!

If working on a raised vehicle, ensure it is securely supported so that it will not tip over.

👁 Note!

Before mounting this product clean the vehicle thoroughly.

👁 Note!

When working on this product, always see the Vehicle Service Manual for vehicle specific procedures and important data.

1

Put the motorcycle on a work stand so that the rear wheel barely touches the ground. Make sure the motorcycle is in a stable position.

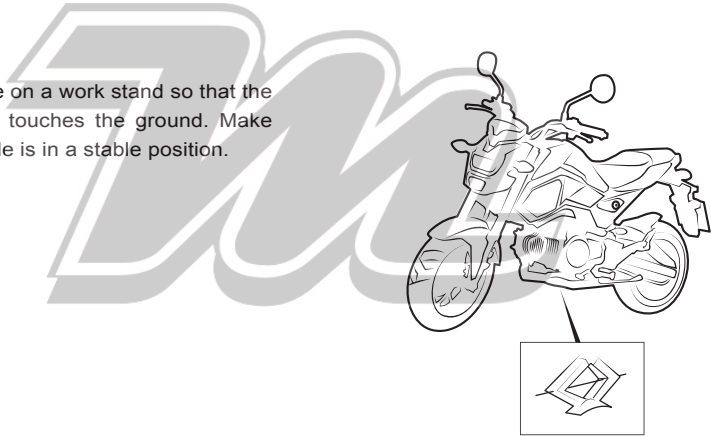

2

Remove the passenger seat by unlocking it with ignition key. Then loosening the screws (1),(2),(3) for remove the rear hugger.

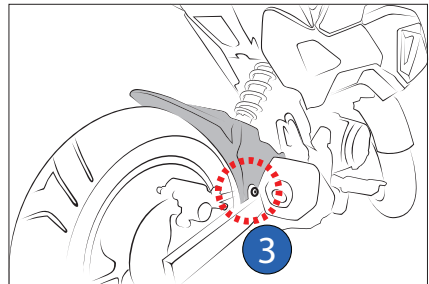
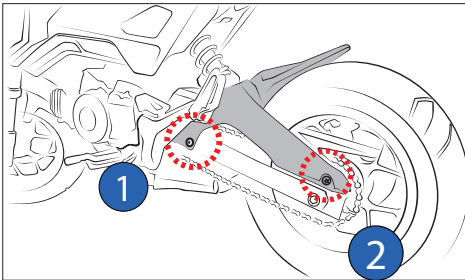

MOUNTING INSTRUCTIONS

3.

Loosen the bolts (1) (2) the screws (3) (4) (5) (6) and pull the locating pins (7) (8) out of the rubber grommets and remove the tail fending.

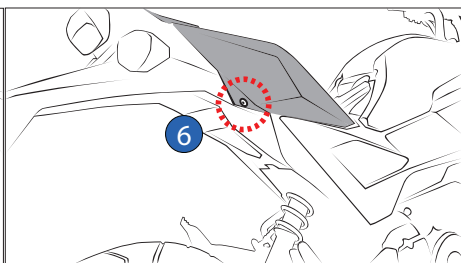
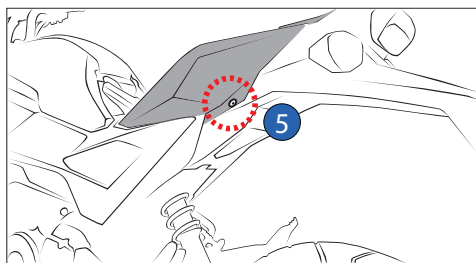
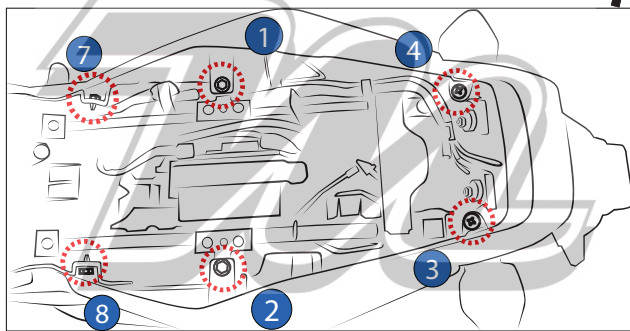
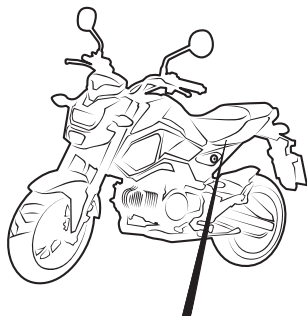

MOUNTING INSTRUCTIONS

4.

Loosen the screws (1) (2) (3) (4) (5) and take off the push clips (6) (7) then remove the plastic fearing

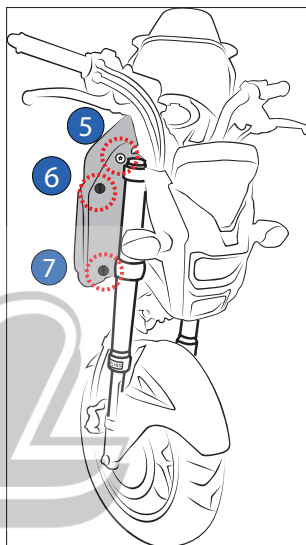
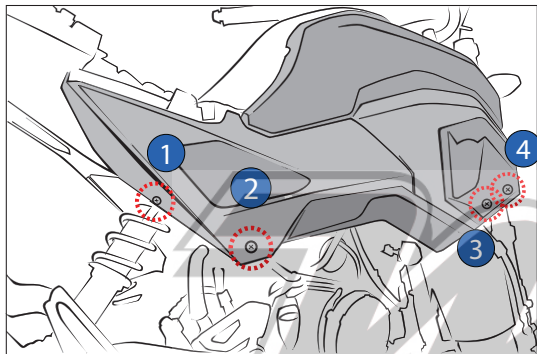

5.

Remove the standard shock absorber by loosening the top and bottom mounting bolts (1) (2).

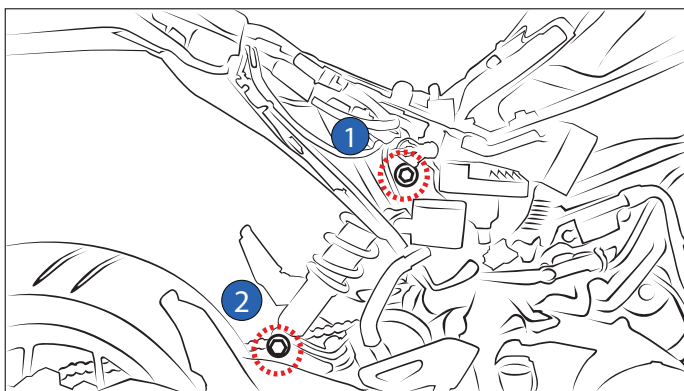

MOUNTING INSTRUCTIONS

6.

Install the Öhlins shock absorber with the hose pointing forward and tighten the mounting bolts at the torque value as specified in the vehicle service manual.

7.

Install the clamp bracket to the reservoir bracket by using the screws 01046-36 (2x)

8.

Slide the reservoir into the clamp bracket. Do not tighten yet.

9.

Install the bracket support to the crankcase by using the screws 01046-62 (1) (2) and the washer 00426-07 (one for each screw)

10.

Place the reservoir in a position with the hose not touching any movable part of the motorcycle then tighten the clamp bracket

Note!

Use the cable tie (60231-01) to clamp the hose for avoid not touch any sharp edges

Note!

Lower the vehicle so that the suspension is slightly compressed before tightening the screws.

Caution!

Ensure that all screws are tightened to the correct torque and that nothing fouls or restricts movement of the shock absorber when the suspension is fully compressed or extended.

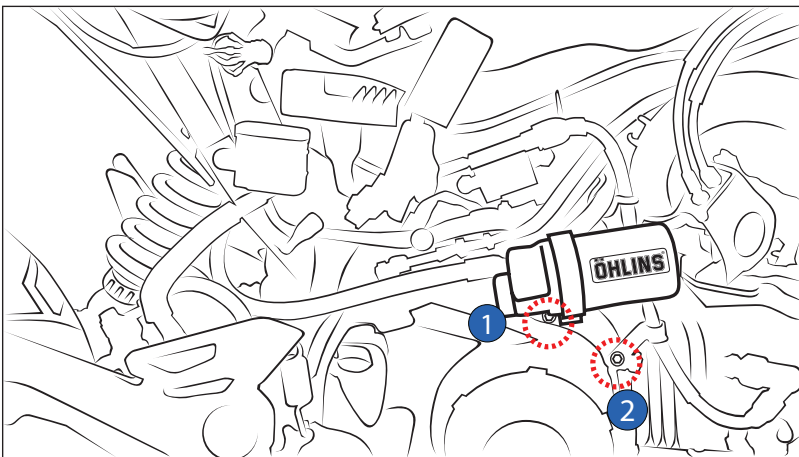

TM

TM

ADJUSTMENTS

⚠ Warning!

Before riding, always make sure that the basic settings made by Öhlins are according to recommended Set-up Data. Read about adjustments and setting up in the Öhlins Owner's Manual before you make any adjustments. Contact an Öhlins dealer if you have any questions about setting up.

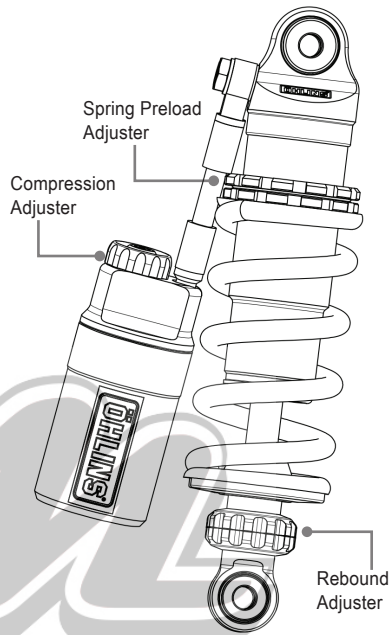

SET-UP DATA

Recommended set-up

Spring Preload	7 mm
Rebound adjuster	8 Clicks
Compression adjuster.....	14 Clicks

Shock absorber data

Length	244 mm
Stroke	43 mm

Spring

Part No	60281-08	60282-06
Free spring length	135 mm	135 mm
Spring rate.....	100 N/mm	110 N/mm
Preload adj. range.....	[0-16] mm	[0-14] mm

Rider's weight below 80 kg

Rider's weight above 80 kg

👁 Note!

It is advisable to have an Öhlins dealer replace the spring.

👁 Öhlins products are subject to continuous improvement and development, therefore, although these instructions include the most up-to-date information available at the time of printing, minor updates may occur.

To find the latest information contact an Öhlins distributor. Please contact Öhlins if you have any questions regarding the contents in this document.

Part no. MI_HO611_EN_0
Issued 2016-06-06

© Öhlins Racing AB. All rights reserved. Any reprinting or unauthorized use without the written permission of Öhlins Racing AB is prohibited.

Öhlins Racing AB
Box 722
SE-194 27 Upplands Väsby, Sweden
Phone +46 8 590 025 00
fax +46 8 590 025 80



www.ohlins.com