

Set-up data

Shock absorber length 304 ± 11.5 mm
Shock absorber stroke 53.5 mm

Spring pre-load 10 mm
Compression damping 10 clicks
Rebound damping 15 clicks

Adjustments

This Öhlins shock absorber features:

1. Spring pre-load adjuster

Adjust by turning the rings on the shock absorber body. Use the C-spanner provided in this kit.

2. Compression damping adjuster

Adjust by turning the adjuster knob on top of the reservoir. *Handtighten only.*

3. Rebound damping adjuster

Adjust by turning the wheel on the piston shaft above the end bracket. *Handtighten only.*

4. Length adjuster

Adjust by turning the end bracket. Tighten the lock nut to lock the position.

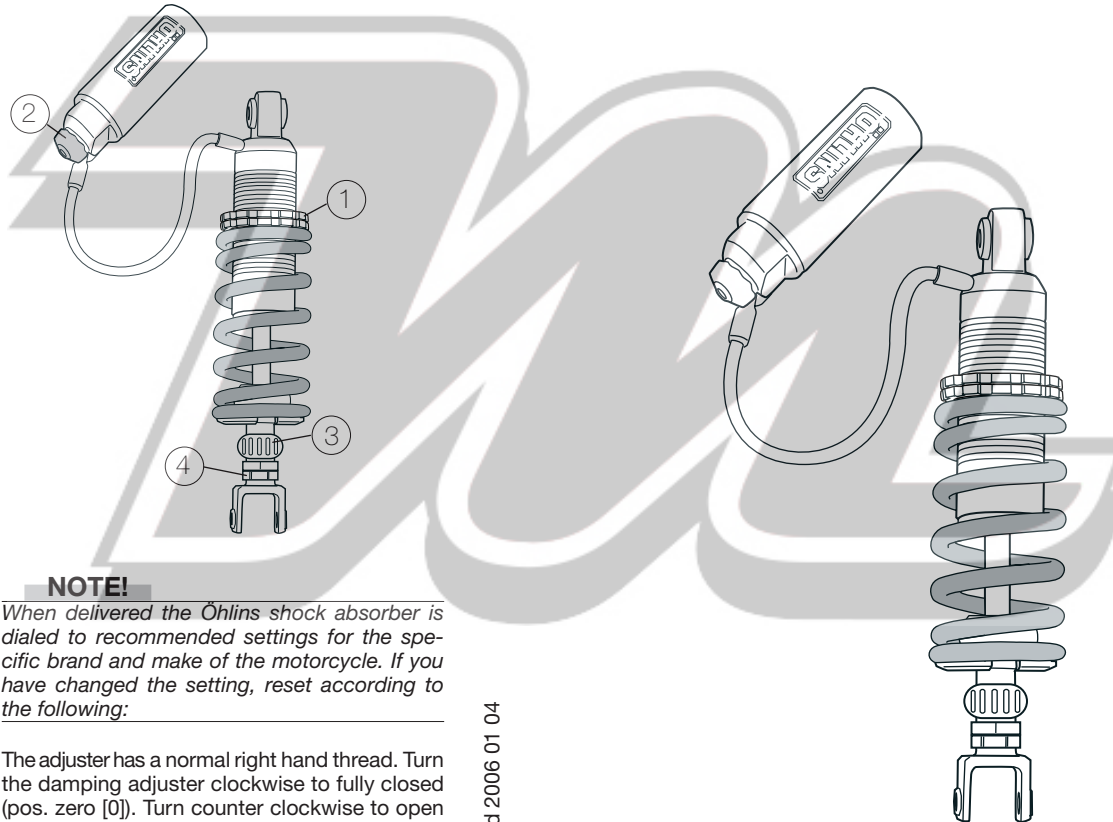

NOTE!

When delivered the Öhlins shock absorber is dialed to recommended settings for the specific brand and make of the motorcycle. If you have changed the setting, reset according to the following:

The adjuster has a normal right hand thread. Turn the damping adjuster clockwise to fully closed (pos. zero [0]). Turn counter clockwise to open and count the clicks until you reach the recommended number. **See Set-up data above.**

CAUTION!

Do not use too much force, delicate sealing surfaces can be damaged.

HO 541, issued 2006 01 04

Mounting Instructions

Öhlins shock absorber kit HO 541
for Honda Hornet 600

Kit Contents

Before installing the shock absorber, please check the contents of the kit. If anything is missing, please contact your Öhlins dealer.

Shock absorber	HO 541 (1)
Washer	00153-04 (1)
Hose clamp	00643-02 (2)
Screw MC6S	01046-16 (1)
Reservoir bracket	01085-04 (1)
Spacer	03105-01 (1)
C-spanner single	00710-02 (1)
Sticker "ÖHLINS"	00192-01 (2)
Sticker "Memo notes"	01180-01 (1)
Öhlins Owners manual	(1)

Before Installing

Öhlins Racing AB cannot be held responsible for any damage to shock absorber or vehicle, or injury to persons, if the instructions for fitting and maintenance are not followed exactly.

Similarly, the warranty will become null and void if the instructions are not adhered to.

Öhlins products are subject to continuous improvement and development. Consequently, although these instructions include the most up-to-date information available at the time of printing, there may be minor differences between your shock absorber and this manual. Please consult your Öhlins dealer if you have any questions regarding the contents of this manual.

4

Maximum length when the groove is visible.

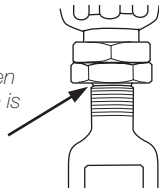

WARNING!

The adjustable end eye/bracket must not be threaded out more than the groove is fully visible beneath the lock nut. After adjusting, make sure that the lock nut is tightened.



Öhlins Racing AB, Box 722, S-194 27 Upplands Väsby, Sweden.
Phone +46 8 590 025 00. Fax +46 8 590 025 80.

www.ohlins.com

© Öhlins Racing AB. All rights reserved. Any reprinting or unauthorized use without the written permission of Öhlins Racing AB is prohibited. Printed in Sweden.



Safety Signals

Important information concerning safety is distinguished in this manual by the following notations:



The Safety alert symbol means: Attention! Your safety is involved.

WARNING!

Failure to follow these warning instructions could result in **severe or fatal injury** to anyone working with, inspecting or using the shock absorber, or to bystanders.

CAUTION!

Caution indicates that special precautions must be taken to avoid damage to the shock absorber.

NOTE!

Indicates information that is of importance regarding mounting procedures.

WARNING!

1. Installing a shock absorber, that is not approved by the vehicle manufacturer, may affect the stability of your vehicle. Öhlins Racing AB cannot be held responsible for any personal injury or damage that may occur after fitting the shock absorber. Contact an Öhlins dealer or other qualified person for advice.

2. Please study and make certain that you fully understand all the mounting instructions and the owner's manual before handling this shock absorber kit. If you have any questions regarding proper installation procedures, contact an Öhlins dealer or other qualified person.

3. The vehicle service manual must be referred to when installing the Öhlins shock absorber

NOTE!

During storage and transportation, especially at high ambient temperature, the oil and grease used for assembling may run out inside the packing and damage the expanded polystyrene packing material. This is not unusual and is in no way detrimental to the shock absorber.

Mounting Instructions

WARNING!

1. It is advisable to have an Öhlins dealer or other qualified person install the shock absorber.
2. Follow the instructions in the vehicle service manual when changing the shock absorber.
3. When working on a raised vehicle, make sure that it is securely supported to prevent it from falling.

1

Put the motorcycle on a workstand so that the rear wheel is off the ground. **Make sure the vehicle is securely supported so that it will not fall over.**

2

Remove the seat.

3

Remove the original shock absorber.

4

Install the Öhlins shock absorber in the same position as the original unit. Fasten the upper and the lower attachments.

5

Remove the screw to the expansion vessel. Install the reservoir bracket into the hole. Place the spacer between the bracket and the expansion vessel. Install the bracket with the screw and washer. **See figure.**

6

Install the reservoir with the hose clamps according to the figure.

7

Install the seat to the original position. Make sure that all screws are tightened before test riding your motorcycle.

NOTE!

Make sure that all screws are tightened to the correct torque and that nothing fouls or restricts movement of the shock absorber when the suspension is being fully compressed or extended.

8

Check sag and ride height. See Set-up Data on the last page of this manual. Read more about the Öhlins shock absorber in your Öhlins Owner's manual.

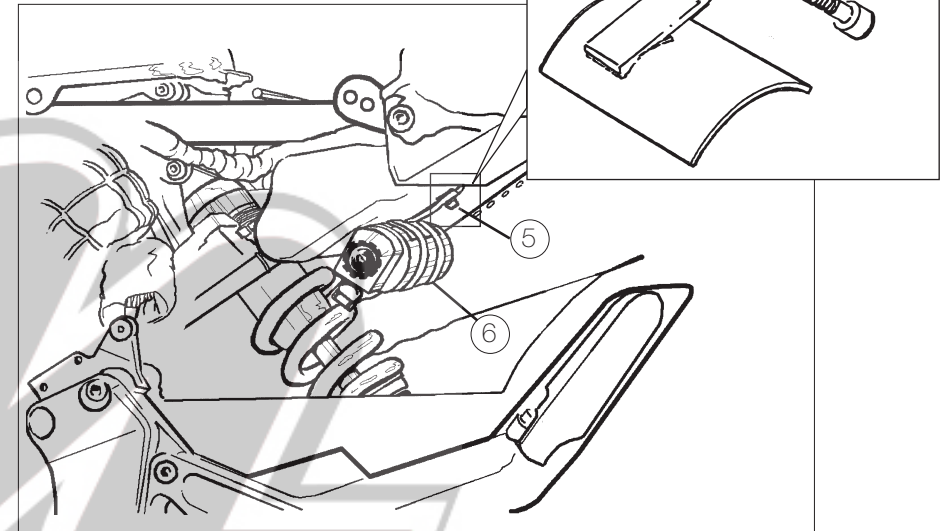

Check sag and ride height

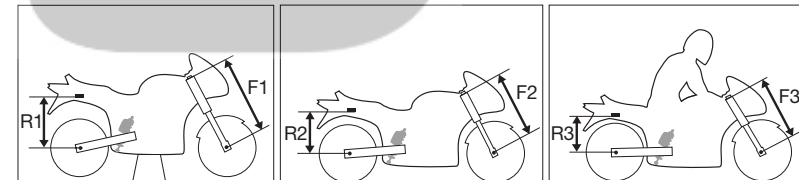

Bike on a stand

Bike on the ground

Bike with rider on

NOTE!

Read more about sag and ride height and different settings in your Öhlins Owner's manual.

Front suspension

- F1. Bike on a stand with the suspension fully extended =
- F2. Bike on the ground without rider =
- F3. Bike on the ground with rider =
- Free sag F1 - F2 =
- Ride height F1 - F3 =

Rear suspension

- R1. Bike on a stand with the suspension fully extended =
- R2. Bike on the ground without rider =
- R3. Bike on the ground with rider =
- Free sag R1 - R2 =
- Ride height R1 - R3 =