

Mounting Instructions

Öhlins shock absorber kit HA 594
for Husqvarna TC450/250 2005

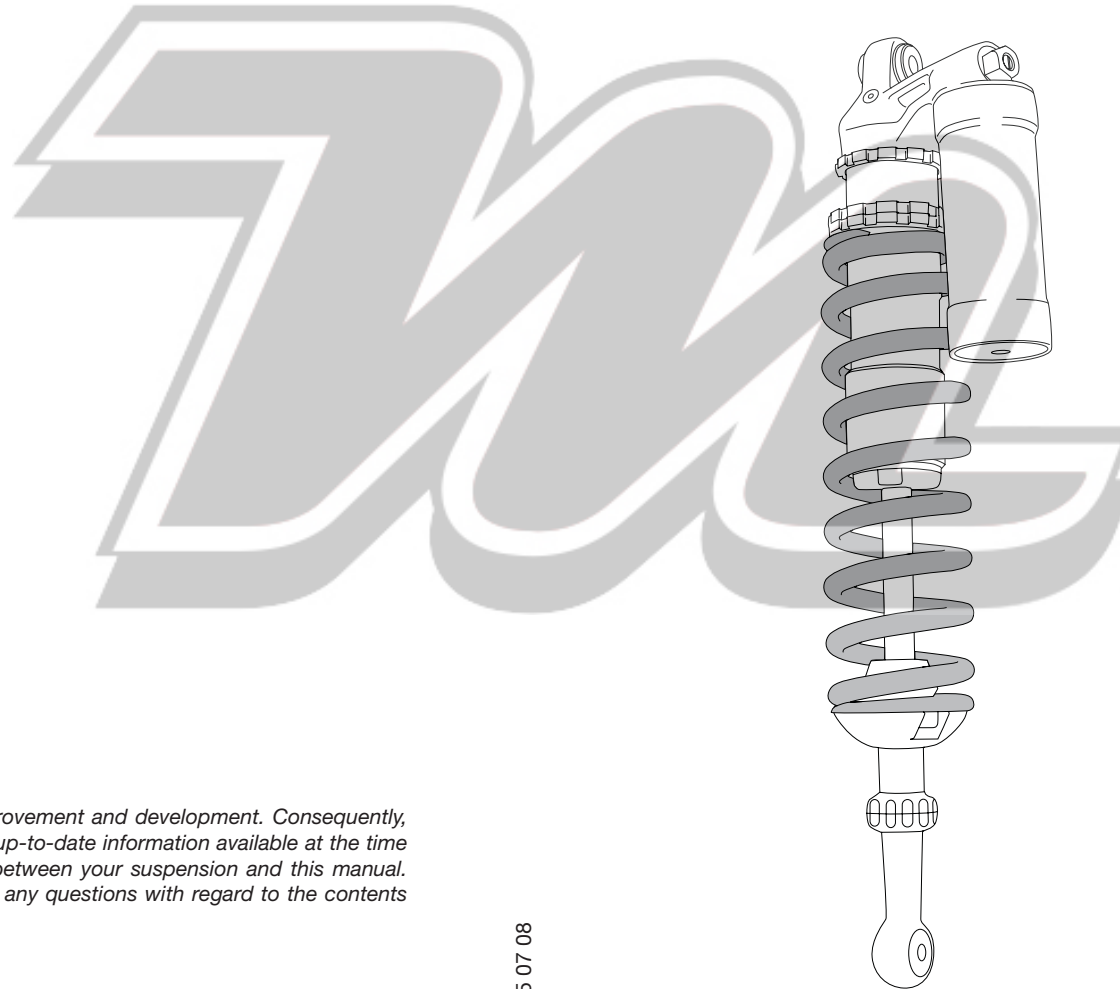

Kit Contents

Before installing the shock absorber, please check the contents of the kit. If anything is missing, please contact your Öhlins dealer.

Description	Pcs.	Part No.
Shock absorber 46PRXW	1	HA 594
Spring clip	1	00629-01
C-spanner	1	00710-02
Sticker Öhlins	2	00197-01
Sticker memo notes	1	01180-01
Owners manual	1	

Before installing

Öhlins Racing AB cannot be held responsible for any damage to shock absorber or vehicle, or injury to persons, if the instructions for fitting and maintenance are not followed exactly.

Similarly, the warranty will become null and void if the instructions are not adhered to.

Öhlins products are subject to continual improvement and development. Consequently, although these instructions include the most up-to-date information available at the time of printing, there may be minor differences between your suspension and this manual. Please consult your Öhlins dealer if you have any questions with regard to the contents of the manual.



Öhlins Racing AB, Box 722, S-194 27 Upplands Väsby, Sweden.
Phone +46 8 590 025 00. Fax +46 8 590 025 80.
www.ohlins.com

HA 594, issued 05 07 08

© Öhlins Racing AB. All rights reserved. Any reprinting or unauthorized use without the written permission of Öhlins Racing AB is prohibited. Printed in Sweden.



Safety Signals

Important information concerning safety is distinguished in this manual by the following notations:



The Safety alert symbol means:
Attention! Your safety is involved.

WARNING!

Failure to follow warning instructions could result in **severe or fatal injury** to anyone working with, inspecting or using the suspension, or to bystanders.

CAUTION!

Caution indicates that special precautions must be taken to avoid damage to the suspension.

NOTE!

This indicates information that is of importance with regard to procedures.

WARNING!

1. Installing a shock absorber, that is not approved by the vehicle manufacturer, may affect the stability of your vehicle. Öhlins Racing AB cannot be held responsible for any personal injury or damage that may occur after fitting the shock absorber. Contact an Öhlins dealer or other qualified person for advice.

2. Please study and make certain that you fully understand all the mounting instructions and the owner's manual before handling this shock absorber kit. If you have any questions regarding proper installation procedures, contact an Öhlins dealer or other qualified person.

3. The vehicle service manual must be referred to when installing the Öhlins shock absorber

NOTE!

During storage and transportation, especially at high ambient temperature, the oil and grease used for assembling may run out inside the packing and damage the expanded polystyrene packing material. This is not unusual and is in no way detrimental to the shock absorber.

Recommended spring

	Spring part. No.	Spring rate N/mm
TC 250	596-09	50
TC 450	596-10	52

NOTE!

If ride height is higher than recommended, softer spring/springs must be used.
If ride height is lower than recommended, harder spring/springs must be used.
Contact your Öhlins dealer for advice.

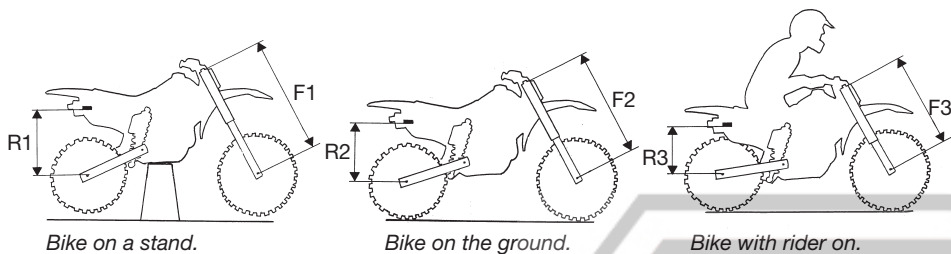

Setup data

Length	459 mm
Stroke	132 mm
Rebound adjustment	25 clicks
Compression adjustment	15 clicks
High speed comp. adj	1½ turns
Free sag, rear	30±5 mm
Ride height, rear	95±5 mm
Front fork adjustment	std.
Recommended fork springs	std.

Checking sag and ride height

Front suspension

- F1. Bike on a stand with the suspension fully extended =
- F2. Bike on the ground without rider =
- F3. Bike on the ground with rider =

Free sag F1 - F2 =

Ride height F1 - F3 =

Rear suspension

- R1. Bike on a stand with the suspension fully extended =
- R2. Bike on the ground without rider =
- R3. Bike on the ground with rider =

Free sag R1 - R2 =

Ride height R1 - R3 =

NOTE!

Make notes when the correct spring is mounted and sag and ride height is adjusted.

Spring pre-load _____mm

Notes

.....

Mounting Instructions - Step 1

Assembly of Shock Absorber with spring separately supplied

⚠ WARNING!

It is advisable to have an Öhlins dealer or other qualified person to fit your shock absorber.

Instructions in the vehicle service manual are to be followed when changing the shock absorber.

When working on a lifted vehicle make sure it is securely supported to prevent it from falling.

1
 Make sure that all components listed on the front page of this manual under "Kit contents" are included.

2
 Measure the free length of the spring.

3
 Fit the spring clip, turn the shock absorber so the spring rests against the spring platform and turn the rings (lock nut and spring platform) so they touch the upper surface of the spring.

4
 With a C-spanner, turn the upper spring platform approximately 8 laps (10 mm) clockwise to pre-load the spring before fitting the shock absorber to the motorcycle.

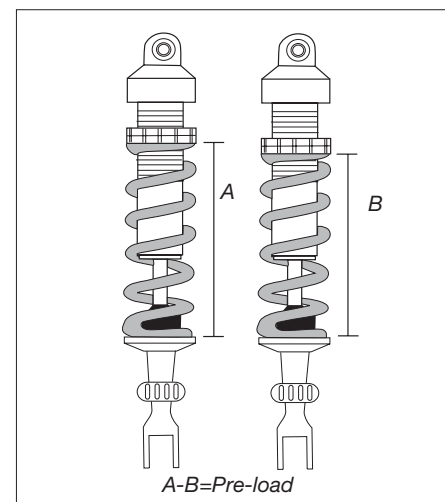
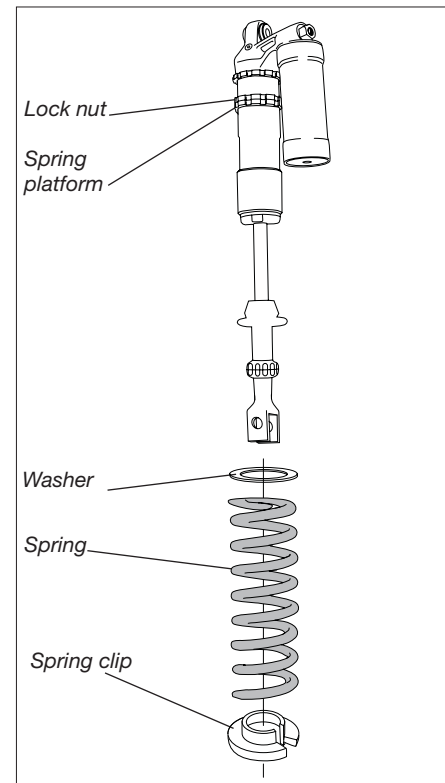

Mounting Instructions - Step 2

Mounting the Shock Absorber

⚠ WARNING!

It is advisable to have an Öhlins dealer or other qualified person to fit your shock absorber.

Instructions in the vehicle service manual are to be followed when changing the shock absorber.

When working on a lifted vehicle make sure it is securely supported to prevent it from falling.

1

Put the motorcycle on a stand so the rear wheel has ground clearance. Make sure it is steadily positioned and will not fall over.

2

Remove the seat by loosening the rear attachment screws.

3

Loosen the rear frame and the hose clamp from the air filter. Disconnect electrical wires. Remove the whole unit with air filter and muffler.

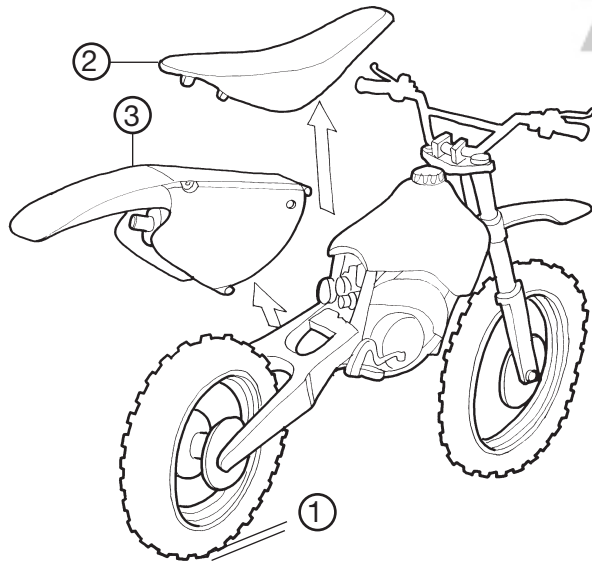

4

Loosen the lower and the upper attachment of the original shock absorber and remove it.

5

Fit the Öhlins shock absorber in the same way as the original unit. Fasten it by using the two original screws.

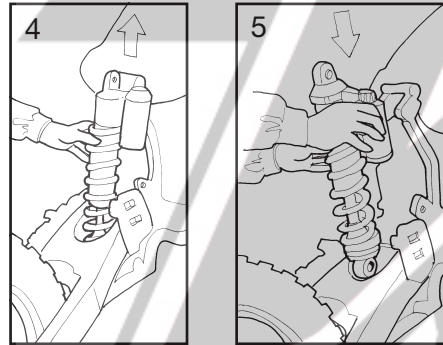

6

Place the seat support and seat back in position and fasten them.

7

Continue your work according to the Owner's Manual.

NOTE!

Make sure that all bolts are tightened to the correct torque and that nothing fouls or restricts movement of the shock absorber when the suspension is being fully compressed or extended.

Adjustments

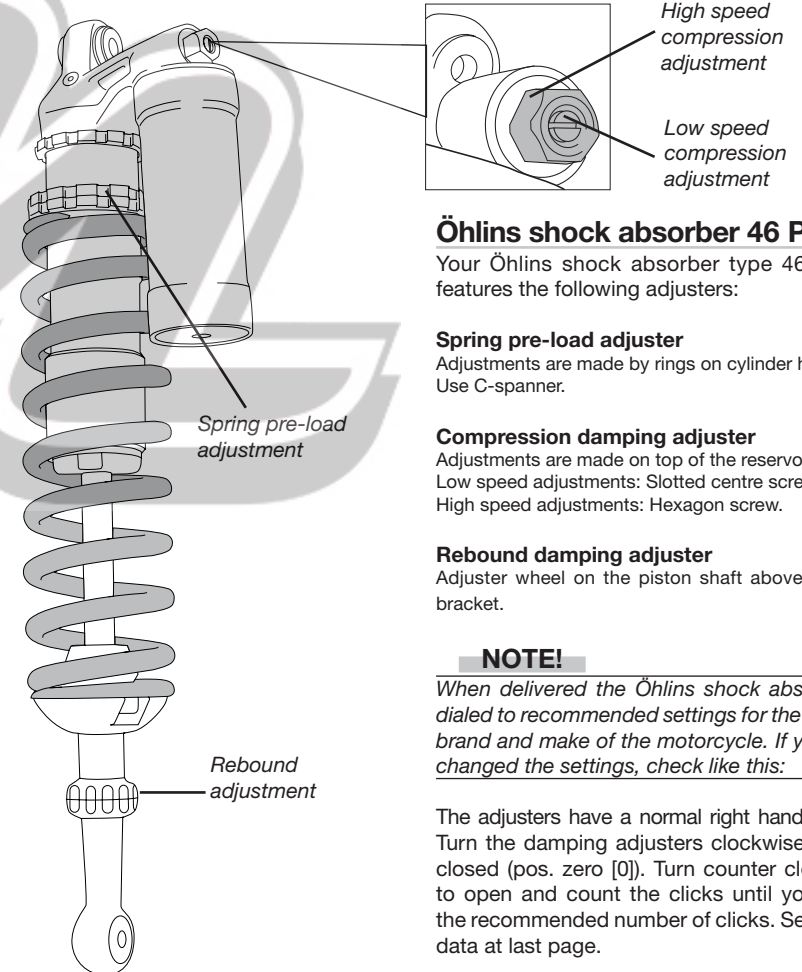

Öhlins shock absorber 46 PRXW

Your Öhlins shock absorber type 46 PRXW features the following adjusters:

Spring pre-load adjuster

Adjustments are made by rings on cylinder house. Use C-spanner.

Compression damping adjuster

Adjustments are made on top of the reservoir. Low speed adjustments: Slotted centre screw. High speed adjustments: Hexagon screw.

Rebound damping adjuster

Adjuster wheel on the piston shaft above the end bracket.

NOTE!

When delivered the Öhlins shock absorber is dialed to recommended settings for the specific brand and make of the motorcycle. If you have changed the settings, check like this:

The adjusters have a normal right hand thread. Turn the damping adjusters clockwise to fully closed (pos. zero [0]). Turn counter clockwise to open and count the clicks until you reach the recommended number of clicks. See Setup data at last page.

CAUTION!

Do not use too much force, delicate sealing surfaces can be damaged.