

Adjustments

⚠ Warning!

Before riding, always make sure that the basic settings made by Öhlins are according to recommended Set-up Data. Read about adjustments and setting up in the Öhlins Owner's Manual before you make any adjustments. Contact an Öhlins dealer if you have any questions about setting up the shock absorber.

Compression and Rebound Adjuster

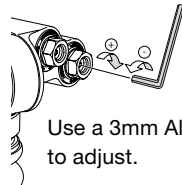

Use a 3mm Allen key to adjust.

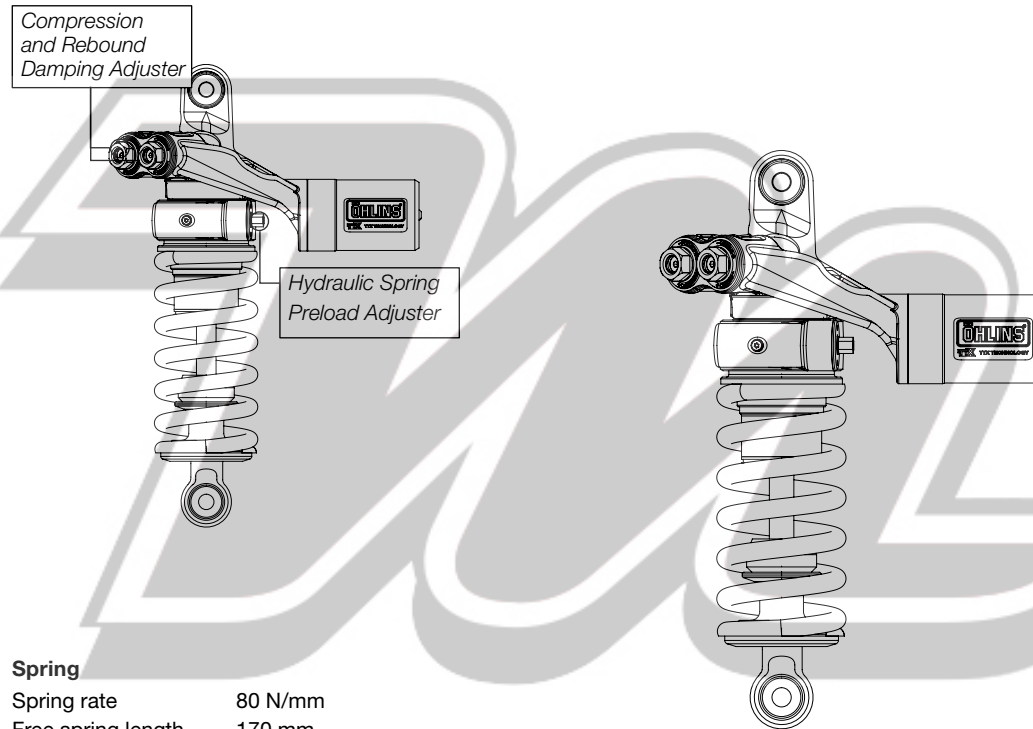

Before installing this product, check the contents of the kit. If anything is missing, please contact your nearest Öhlins dealer.

Kit Contents

| | Part No. | Pcs. |
|--------------------|----------|------|
| Shock absorber | DU816 | 1 |
| Öhlins Sticker | 00192-01 | 2 |
| Memo Notes Sticker | 01180-01 | 1 |
| Owner's Manual | 07242-01 | 1 |

Please note that during storage and transportation, especially at high ambient temperature, some of the oil and grease used for assembling may leak and stain the packaging. This is in no way detrimental to the product, wipe off the excessive oil/grease with a cloth.

⚠ Warning!

Before installing this product, read the Öhlins Owner's Manual. The shock absorber is an important part of your vehicle and may affect the stability of your vehicle.

Set-up Data

Recommended Set-up

| | |
|-----------------|-----------|
| Spring preload | 26 mm |
| Rebound damping | 14 clicks |
| Compr. damping | 14 clicks |

Shock Absorber Data

| | |
|-----------------------|----------|
| Shock absorber length | 294,5 mm |
| Stroke | 60 mm |

Spring

| | |
|--------------------|---------|
| Spring rate | 80 N/mm |
| Free spring length | 170 mm |

👁 Öhlins products are subject to continuous improvement and development, therefore, although these instructions include the most up-to-date information available at the time of printing, minor updates may occur.

To find the latest information contact your Öhlins distributor. Please consult your Öhlins dealer if you have any questions regarding the contents in this document.

Part no. DU816_1
Issued 2011-01-21



© Öhlins Racing AB. All rights reserved. Any reprinting or unauthorized use without the written permission of Öhlins Racing AB is prohibited.

Öhlins Racing AB
Box 722
S-194 27 Upplands Väsby, Sweden
Phone +46 8 590 025 00
fax +46 8 590 025 80



www.ohlins.com

Shock Absorber for Ducati Street Fighter DU 816

Mounting Instructions



⚠ Warning!

It is advisable to have an Öhlins dealer install the shock absorber.

When installing, consult your Vehicle Service Manual.

1
Put the motorcycle on a stand so that the rear wheel barely touches the ground.

⚠ Warning!

Make sure the vehicle is securely supported so that it will not tip.

2
Loosen the left foot peg and leave it for now.

3
Remove the rubber plug and loosen the lower mount for the original shock absorber.

4
Loosen the upper linkage rocker centre mounting screw in the frame.

5
Raise the rear end of the bike more, so that you can access the bolt that connects the rocker to the swing arm connection rod and loosen that bolt.

6
Loosen the upper shock mounting bolt in the rocker arm.

7
Loosen the silencers and rear part of the exhaust system from its brackets, it should not be necessary to remove them, although it can be necessary on some bikes depending on exhaust system.

8
Raise the rear of the bike so that the swing arm extends as much as possible. Be careful and check so that nothing is stretched bent or squeezed.

9
Remove the original shock absorber backwards with the upper end first.

👁 Note!

Before installing the Öhlins shock absorber clean the vehicle thoroughly.

10
Install the Öhlins shock absorber and all other parts removed in reverse order.

👁 Note!

Lower the motorcycle so that the shock absorber is slightly compressed, before tightening the screws.

11

Make sure that all removed and loosened parts are reinstalled in the same way they were before you started the installation.

👉 Caution!

Make sure that all screws are tightened to the correct torque and that nothing fouls or restricts movement of the shock absorber when the suspension is fully compressed or extended.

