

Adjustments

⚠ Warning!

Before riding, always make sure that the basic settings made by Öhlins are according to recommended Set-up Data. Read about adjustments and setting up in the Öhlins Owner's Manual before you make any adjustments. Contact an Öhlins dealer if you have any questions about setting up the shock absorber.

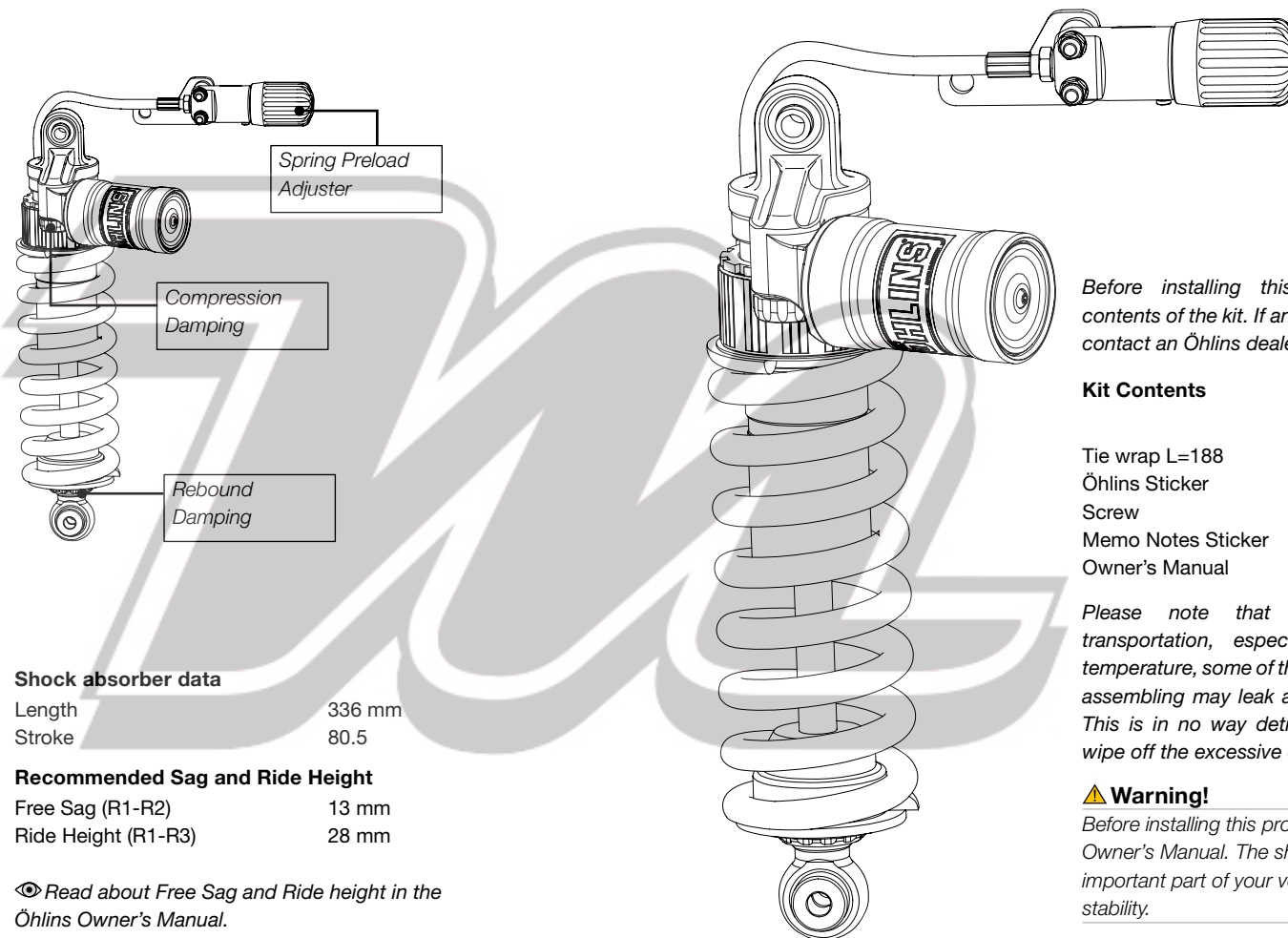

Before installing this product, check the contents of the kit. If anything is missing, please contact an Öhlins dealer.

Kit Contents

	Part No.	Pcs.
Tie wrap L=188	00231-01	2
Öhlins Sticker	00192-01	2
Screw	01046-11	1
Memo Notes Sticker	01180-01	1
Owner's Manual	07241-02	1

Please note that during storage and transportation, especially at high ambient temperature, some of the oil and grease used for assembling may leak and stain the packaging. This is in no way detrimental to the product, wipe off the excessive oil/grease with a cloth.

⚠ Warning!

Before installing this product, read the Öhlins Owner's Manual. The shock absorber is an important part of your vehicle and will affect the stability.

Set-up Data

Recommended set-up

Rebound	17 clicks
Compression	12 clicks
Spring Preload	17 mm
Spring Rate	115 N/mm
Spring; Free length	220 mm

Shock absorber data

Length	336 mm
Stroke	80.5

Recommended Sag and Ride Height

Free Sag (R1-R2)	13 mm
Ride Height (R1-R3)	28 mm

👁 Read about Free Sag and Ride height in the Öhlins Owner's Manual.

👁 Öhlins products are subject to continuous improvement and development, therefore, although these instructions include the most up-to-date information available at the time of printing, minor updates may occur.

To find the latest information contact your Öhlins distributor. Please consult your Öhlins dealer if you have any questions regarding the contents in this document.

Part no. BM908_1
Issued 2011-10-26



© Öhlins Racing AB. All rights reserved. Any reprinting or unauthorized use without the written permission of Öhlins Racing AB is prohibited.

Öhlins Racing AB
Box 722
S-194 27 Upplands Väsby, Sweden
Phone +46 8 590 025 00
fax +46 8 590 025 80



www.ohlins.com

Shock Absorber for BMW K1300GT - Rear **BM 908**

Mounting Instructions



⚠ Warning!

It is advisable to have an Öhlins dealer install the shock absorber.

When installing, read the Vehicle Service Manual.

1
Put the motorcycle on a workstand so that the rear wheel barely touches the ground. The swing arm must be free so that the suspension is unloaded.

⚠ Warning!

Make sure the vehicle is securely supported so that it will not tip.

2
Remove the seat.

3
Remove the side covers on the left side of the bike.

4
Remove the passenger handles and rear side covers on both sides.

5
Remove the footrest bracket on the left side of the bike.

6
Loosen the upper oil return hose clamp at the oil tank.

7
Loosen the rear brake fluid reservoir and hose clamps for the hose.

8
Loosen without removing the mounting bolts to the right footrest bracket.

9
Remove the mounting screws for the oil tank in the rear frame.

10
Remove the upper and lower shock mounting bolts.

11
If the bike is equipped with ESA, disconnect the connectors to the shock absorber.

12
Remove the mounting bolts for the rear frame. Loosen the wire harness enough to lift the rear frame so that you can access the shock absorber unit.

👁 Note!

We recommend you to get some help to hold the rear frame during this part of the work.

13
Push the oil tank rearwards carefully without stretching or bending the hoses too much.

14
Remove the standard shock absorber to the left.

👁 Note!

Before installing the Öhlins shock absorber clean the vehicle thoroughly.

15
Install the Öhlins shock with the preload adjuster on the right side.

👁 Note!

Lower the motorcycle so that the shock absorber is slightly compressed, before tightening the screws.

16
Assemble everything in reverse order.

17
Install the preload adjuster at the silencer bracket with the supplied screw.

18
Make sure that all removed parts are reinstalled in the same way as they were before the installation of the Öhlins shock absorber.

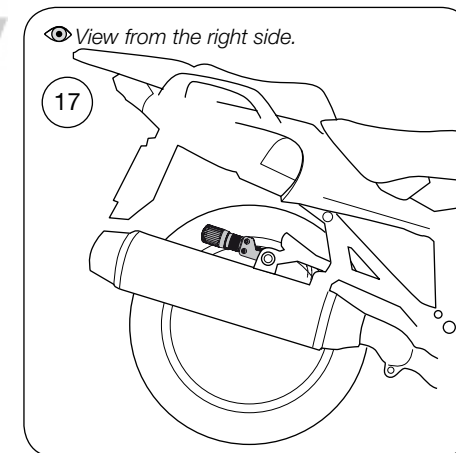
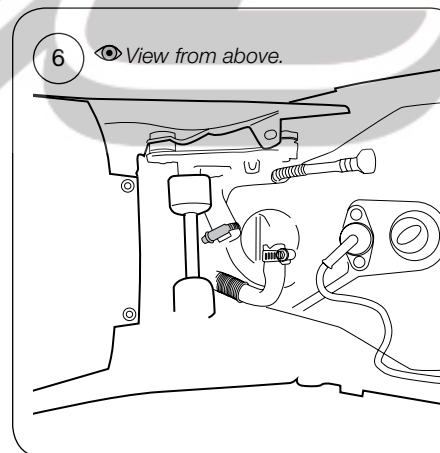
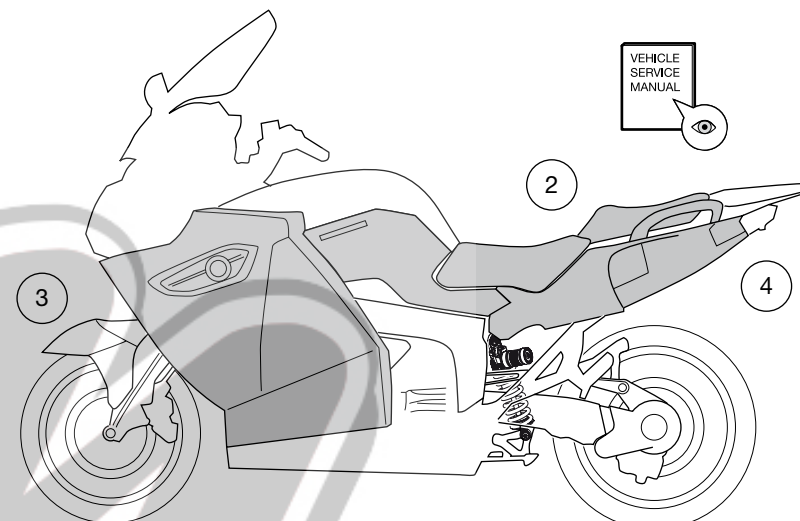

👉 Caution!

Make sure that all screws are tightened to the correct torque and that nothing fouls or restricts movement of the shock absorber when the suspension is fully compressed or extended.