

Adjustments

⚠ Warning!

Before riding, always make sure that the basic settings made by Öhlins are according to recommended Set-up Data. Read about adjustments and setting up in the Öhlins Owner's Manual before you make any adjustments. Contact an Öhlins dealer if you have any questions about setting up the shock absorber.

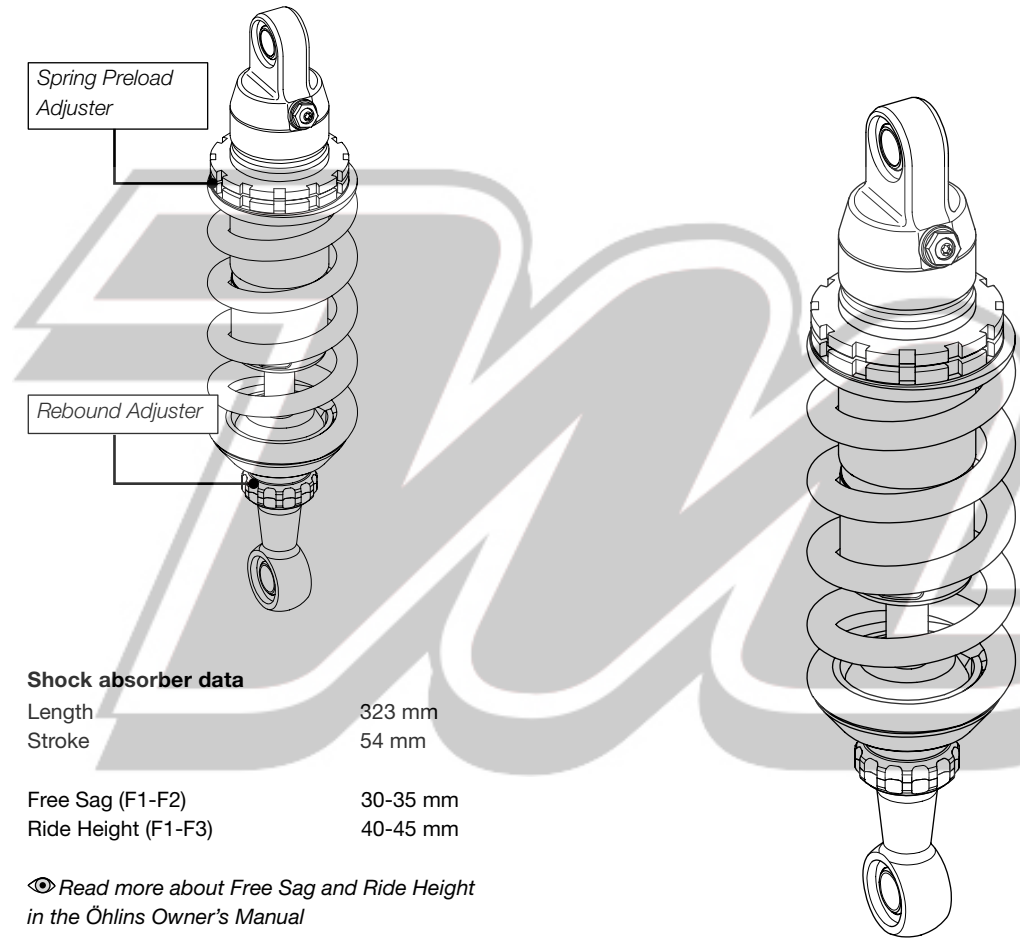

Before installing this product, check the contents of the kit. If anything is missing, please contact an Öhlins dealer.

Kit Contents

	Part No.	Pcs.
Shock abs.	BM 906	1
C-spanner	00710-02	1
Öhlins Sticker	00192-01	2
Memo Notes Sticker	01180-01	1
Owner's Manual	07241-02	1

Please note that during storage and transportation, especially at high ambient temperature, some of the oil and grease used for assembling may leak and stain the packaging. This is in no way detrimental to the product, wipe off the excessive oil/grease with a cloth.

⚠ Warning!

Before installing this product, read the Öhlins Owner's Manual. The shock absorber is an important part of your vehicle and will affect the stability.

Set-up Data

Recommended set-up

Rebound	14 clicks
Spring Preload	5 mm

Shock absorber data

Length	323 mm
Stroke	54 mm
Free Sag (F1-F2)	30-35 mm
Ride Height (F1-F3)	40-45 mm

👁 Read more about Free Sag and Ride Height in the Öhlins Owner's Manual

👁 Öhlins products are subject to continuous improvement and development, therefore, although these instructions include the most up-to-date information available at the time of printing, minor updates may occur.

To find the latest information contact your Öhlins distributor. Please consult your Öhlins dealer if you have any questions regarding the contents in this document.

Part no. BM906_2
Issued 2009-04-28



Shock Absorber for BMW K1300 R/S/GT - front

BM 906

Mounting Instructions

© Öhlins Racing AB. All rights reserved. Any reprinting or unauthorized use without the written permission of Öhlins Racing AB is prohibited.

Öhlins Racing AB
Box 722
S-194 27 Upplands Väsby, Sweden
Phone +46 8 590 025 00
fax +46 8 590 025 80



www.ohlins.com



How to install

⚠ Warning!

It is advisable to have an Öhlins dealer install the shock absorber.

When installing, consult your Vehicle Service Manual.

1

Remove the lower fairing, the side fairings, and the tank covers.

👁 Note!

Note the different lengths of the screws. Make sure to put them in their original positions when reassembling.

👁 Note!

K 1300 R and GT only: The tank cover and the side and front fairings only need to be removed on the right side of the motorcycle.

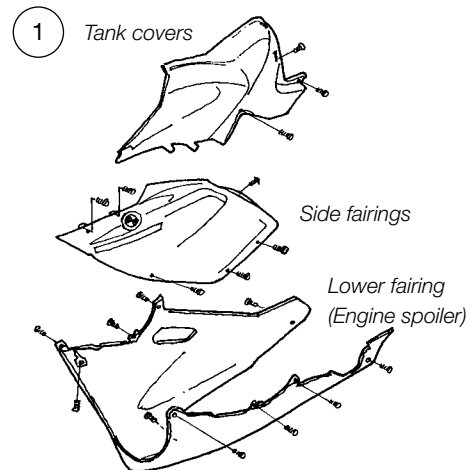

2

Put the motorcycle on a workstand so that the rear wheel barely touches the ground.

⚠ Warning!

Make sure the vehicle is securely supported so that it will not tip.

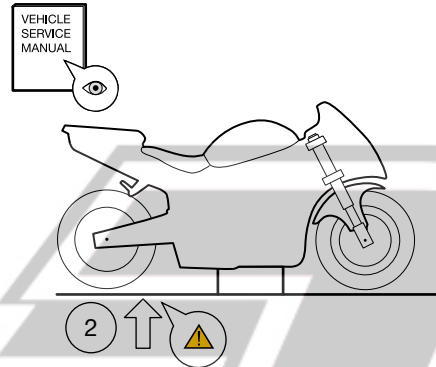

3

Remove the air duct on the right side of the motorcycle.

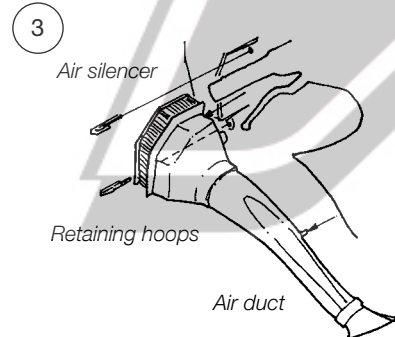

4

Motorcycle equipped with ESA: Remove the cabling from the original shock absorber.

5

Loosen the nut and divide the lower ball joint at the lower link arm. Use an allen key to secure the ball joint.

6

Loosen the radiator, but do not remove it, so that the shock absorber can be removed.

7

Loosen the lower bracket of the original shock absorber. Then, loosen the upper attachment and remove the original shock absorber.

How to install

👁 Note!

Lower the motorcycle so that the shock absorber is slightly compressed, before tightening the screws.

9

Tighten the upper and the lower attachments.

10

Rejoin the ball joint and the link arm. Reinstall the air duct, side and lower fairings. Make sure that all removed parts are reinstalled in the same way as they were before the installation of the Öhlins shock absorber.

👁 Caution!

Make sure that all screws are tightened to the correct torque and that nothing fouls or restricts movement of the shock absorber when the suspension is fully compressed or extended.

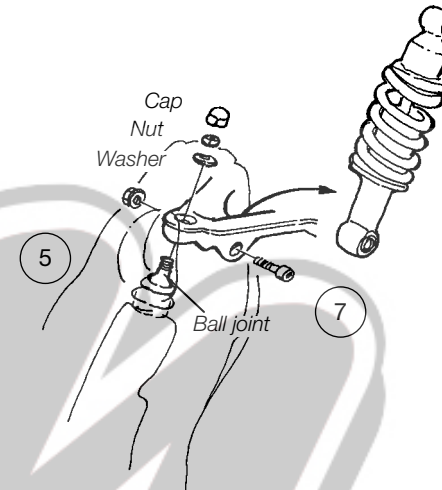

👁 Note!

Before installing the Öhlins shock absorber clean the vehicle thoroughly.

8

Install the Öhlins Shock Absorber. Install the upper attachment first. Do not tighten the attachments yet.