

Reinstall the seat and lock it. Close the toolbox lid. Make sure that all removed parts are reinstalled in the same way that they were before installing the Öhlins shock absorber.

**NOTE!**

Make sure that all screws are tightened to the correct torque and that nothing fouls or restricts movement of the shock absorber when the suspension is being fully compressed or extended.

**ADJUSTMENTS**

Always ensure that the basic settings made by Öhlins are intact.

**1 Spring Preload**

Turn the Hydraulic Adjuster knob to set the spring preload. Turn clockwise to increase the preload, turn counter clockwise to decrease.

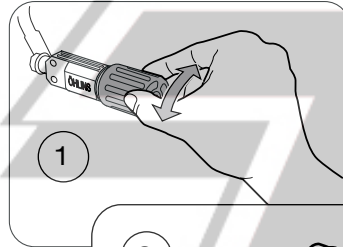
**2 Compression**

Adjust by turning the knob on top of the reservoir. Turn clockwise to increase damping, turn counter clockwise to decrease.

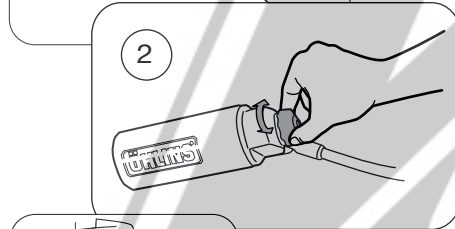
**3 Rebound**

Turn the wheel on the piston shaft above the end eye/ bracket. Turn clockwise to increase damping, turn counter clockwise to decrease.

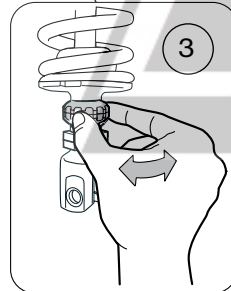
**SET-UP DATA****Recommendations:**

Spring preload	15 mm
Rebound damping	14 clicks
Compression damping	12 clicks

**Data:**

Total length	328,5 mm
Stroke	60,5 mm

**Recommended Sag and Ride Height**

F1 - F2:	40-50 mm
F1 - F3:	55-65 mm
R1 - R2:	20-30 mm
R1 - R3:	55-65 mm

👁️ Read more about sag and ride height in the Öhlins Owner's Manual.

© Öhlins Racing AB. All rights reserved. Any reprinting or unauthorized use without the written permission of Öhlins Racing AB is prohibited. Printed in Sweden.



Mounting Instruction BM750\_2 Issued 20090706  
These instructions and other documents can be downloaded from [www.ohlins.com](http://www.ohlins.com)

# Mounting Instruction

WITH SET-UP DATA

**SHOCK ABSORBER BM750**  
for BMW F 650 GS

Before installing this shock absorber, check the contents of the kit listed below. If anything is missing, please contact your nearest Öhlins dealer.

**Kit Contents:**

	Part no.	Pcs.
Shock absorber	BM 750	1
Tie wrap	00231-01	2
Öhlins Sticker	00192-01	2
Memo Notes	01180-01	1
Owner's Manual	07251-02	1

During storage and transportation, especially at high ambient temperature, the oil and grease used for assembling may leak inside the packing and damage the expanded polystyrene packing material. This is not unusual and is in no way detrimental to the shock absorber.



Before installing this product, read the Öhlins Owner's Manual!



Öhlins Racing AB, Box 722, S-194 27 Upplands Väsby, Sweden.  
Phone +46 8 590 025 00 Fax +46 8 590 025 80  
[www.ohlins.com](http://www.ohlins.com)

## HOW TO INSTALL

### ⚠ WARNING!

It is advisable to have an Öhlins dealer install your Öhlins shock absorber.

1

Put the motorcycle on a workstand so that the front wheel barely touches the ground. Make sure that the swing arm is free so that the suspension is unloaded.

### ⚠ WARNING!

Make sure the vehicle is securely supported so that it will not tip.

2

Open the toolbox. Use a T-handle to loosen the seat and remove it.

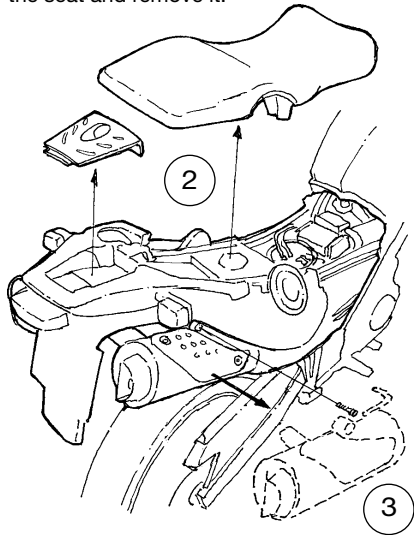

3

Loosen the screw to the right silencer bracket and remove the right silencer carefully.

4

Loosen the exhaust pipe with a 15 mm key and remove the left silencer by pulling it towards the rear.

5

Loosen the brake fluid reservoir on the right side and leave it hanging.

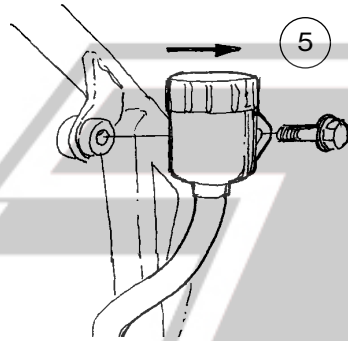

6

Remove the control box and all electric connections (4 pcs) and let the loose wiring hang out to the right side of the motorcycle.

### ⚠ WARNING!

When removing the fuel tank it must be empty, or contain very small amount of fuel. If not, it may flow over when the connections are loosened.

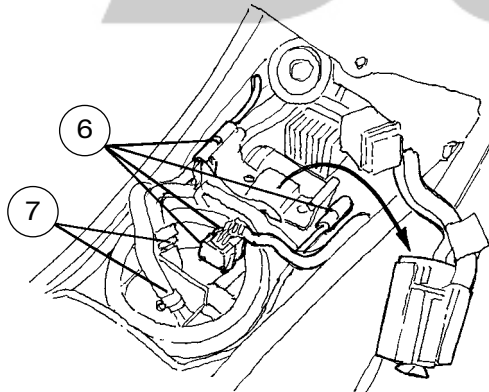

7

Loosen the two fuel lines.

8

Loosen the four [4] bolts holding the rear subframe unit.

9

Lift the rear unit towards the back and up, remove it from the motorcycle.

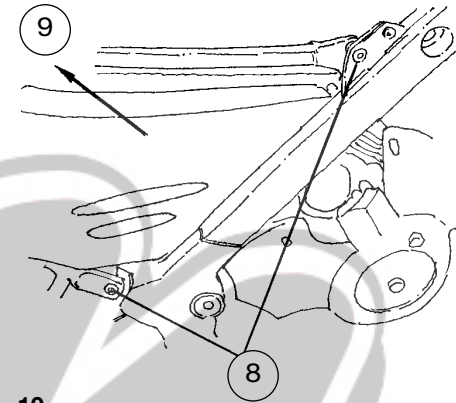

10

Remove the plastic cover for the front sprocket. Remove the original reservoir.

11

Loosen and remove the original hydraulic preload adjuster and bracket.

12

Loosen the lower bracket of the right droplink, pull it toward the back until you can reach the lower attachment of the shock absorber.

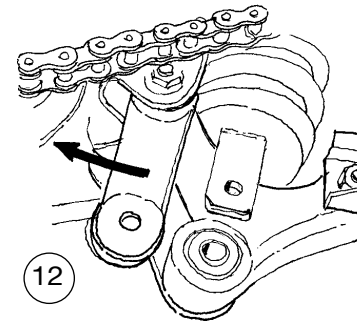

13

Loosen the lower attachment of the original shock absorber from the triangle link.

14

Loosen the upper attachment of the original shock absorber and remove it by lifting it up.

### NOTE!

Recommendation: Before installing the Öhlins shock absorber clean the vehicle thoroughly.

15

Install the Öhlins shock absorber in reverse order. Start with the lower attachment.

16

Install the upper attachment. Bring the droplink back into position and install the pivot bolt and nut.

### NOTE!

Lower the motorcycle so that the shock absorber is compressed 1 mm, before tightening the screws.

17

Install the reservoir and the preload adjuster into the original bracket.

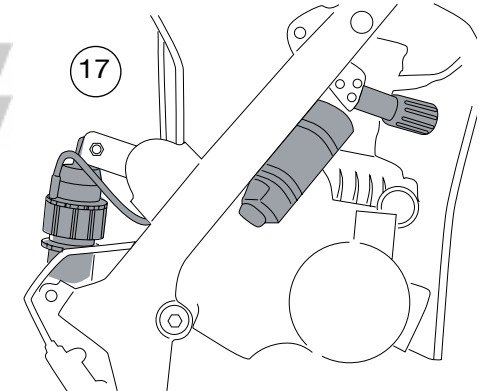

18

Reinstall the fuel tank and tighten the bolts. Reinstall the fuel lines, electrical connections and the control box.

19

Put the brake fluid reservoir back in position.

20

Reinstall the left and right silencer.