

#### Set-up data

Shock absorber length	319 mm
Shock absorber stroke	82 mm
Spring pre-load	9 mm

#### NOTE!

Read more about sag and ride height and different settings in your Öhlins Owner's manual.

#### Adjustments

##### Spring pre-load adjuster

Adjust by turning the rings on the cylinder house. Use a C-spanner. Turn clockwise for harder adjustment, turn counter clockwise to release the pre-load.

#### NOTE!

When delivered the Öhlins shock absorber is dialed to recommended settings for the specific brand and make of the vehicle.

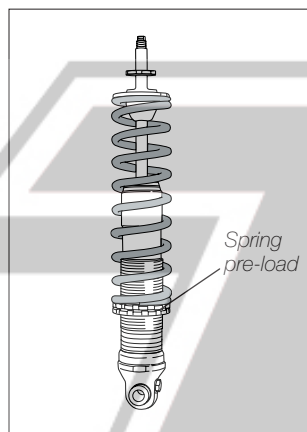

# Mounting Instructions

Öhlins shock absorber kit BM 540  
for BMW K1200LT - front

#### Kit Contents

Before installing the shock absorber, please check the contents of the kit. If anything is missing, please contact your Öhlins dealer.

Description	Article no.
Shock absorber DRS	BM 540 (1)
C-spanner	00710-01 (1)
Sticker Öhlins	00192-01 (2)
Sticker memo notes	01180-01 (1)
Öhlins Owner's manual	(1)

#### Before Installing

Öhlins Racing AB cannot be held responsible for any damage to shock absorber or vehicle, or injury to persons, if the instructions for fitting and maintenance are not followed exactly.

Similarly, the warranty will become null and void if the instructions are not adhered to.

Öhlins products are subject to continuous improvement and development. Consequently, although these instructions include the most up-to-date information available at the time of printing, there may be minor differences between your shock absorber and this manual. Please consult your Öhlins dealer if you have any questions regarding the contents of this manual.

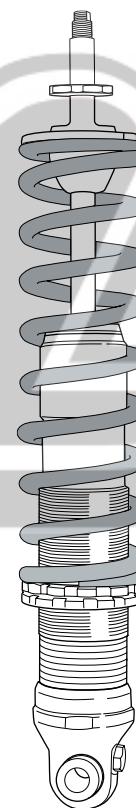

BM 540, issued 2005 11 30



Öhlins Racing AB, Box 722, S-194 27 Upplands Väsby, Sweden.  
Phone +46 8 590 025 00. Fax +46 8 590 025 80.

[www.ohlins.com](http://www.ohlins.com)

© Öhlins Racing AB. All rights reserved. Any reprinting or unauthorized use without the written permission of Öhlins Racing AB is prohibited. Printed in Sweden.



## Safety Signals

Important information concerning safety is distinguished in this manual by the following notations:



The Safety alert symbol means: Attention! Your safety is involved.

### WARNING!

Failure to follow these warning instructions could result in **severe or fatal injury** to anyone working with, inspecting or using the shock absorber, or to bystanders.

### CAUTION!

Caution indicates that special precautions must be taken to avoid damage to the shock absorber.

### NOTE!

Indicates information that is of importance regarding mounting procedures.

### WARNING!

1. Installing a shock absorber, that is not approved by the vehicle manufacturer, may affect the stability of your vehicle. Öhlins Racing AB cannot be held responsible for any personal injury or damage that may occur after fitting the shock absorber. Contact an Öhlins dealer or other qualified person for advice.

2. Please study and make certain that you fully understand all the mounting instructions and the owner's manual before handling this shock absorber kit. If you have any questions regarding proper installation procedures, contact an Öhlins dealer or other qualified person.

3. The vehicle service manual must be referred to when installing the Öhlins shock absorber

### NOTE!

During storage and transportation, especially at high ambient temperature, the oil and grease used for assembling may run out inside the packing and damage the expanded polystyrene packing material. This is not unusual and is in no way detrimental to the shock absorber.

## Mounting Instructions

### WARNING!

1. It is advisable to have an Öhlins dealer or other qualified person install the shock absorber.
2. Follow the instructions in the vehicle service manual when changing the shock absorber.
3. When working on a raised vehicle, make sure that it is securely supported to prevent it from falling.

1

Put the motorcycle on a workstand so that the rear wheel is off the ground. **Make sure the vehicle is securely supported so that it will not fall over.**

2

Remove the small cover in front of the seat. Loosen the fuel tank covers so that the upper cover can be moved to the side.

3

Loosen the upper covers around the steering handlebar and the ignition lock.

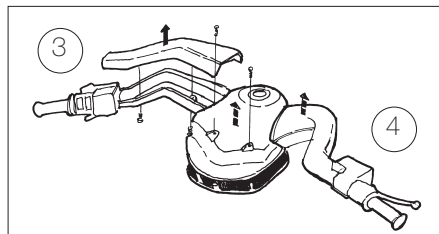
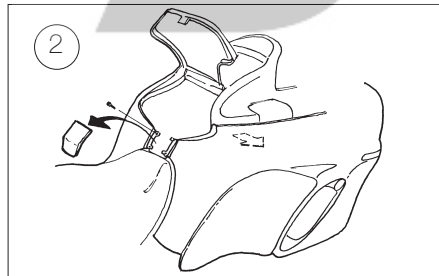

4 Loosen the rubber boot and move it to the side.

5

Loosen the upper attachment nut of the original shock absorber. Use a 15 mm wrench and an allen key to hold the shaft.

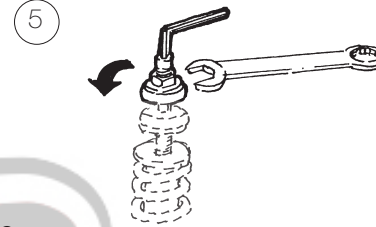

6

Loosen the lower attachment bolt of the original shock absorber.

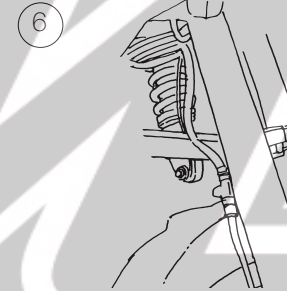

7

Remove the original shock absorber by lifting it upwards and take it out forwards with the bottom first.

### NOTE!

Remove the upper bushings first to make the job easier. You might need to loosen the front brake calipers and the brake hose brackets.

8

Install the Öhlins shock absorber in the same way as the original unit. Put in the upper end of the shock absorber and then the lower end.

9

Reattach the upper rubber bushing and the original washers and nuts.

10

Attach the upper end of the shock absorber, then the lower end. Use the original bolts, make sure to secure them.

### NOTE!

Make sure that all bolts are tightened to the correct torque and that nothing fouls or restricts movement of the shock absorber when the suspension is being fully compressed or extended.

11

Reassemble the motorcycle by reattaching the covers in reversed order.

12

Read more about your shock absorber in the Öhlins owner's manual.

## Check sag and ride height

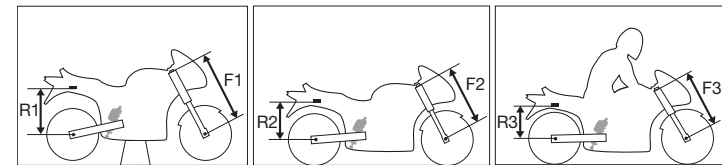

Bike on a stand

Bike on the ground

Bike with rider on

### Front suspension

F1. Bike on a stand with the suspension fully extended = .....

F2. Bike on the ground without rider = .....

F3. Bike on the ground with rider = .....

Free sag F1 - F2 = .....  
Recommended: 25 - 30 mm

Ride height F1 - F3 = .....  
Recommended: 35 - 40 mm

### Rear suspension

R1. Bike on a stand with the suspension fully extended = .....

R2. Bike on the ground without rider = .....

R3. Bike on the ground with rider = .....

Free sag R1 - R2 = .....  
Recommended: 7 - 12 mm

Ride height R1 - R3 = .....  
Recommended: 25 - 35 mm