



Yamaha YZF R6 (2003 - 2005)

Slip-On Exhaust System

Akrapovic Slip-On Exhaust System

for the Yamaha YZF R6 (2003 - 2005)

The R6 is an elegant warrior, with sharper lines which will catch the attention of even the less interested onlookers. We have developed an Akrapovic SLIP-ON aftermarket component which will elegantly replace the stock muffler. Your R6 will get a face-lift, a throatier sound and of course a performance upgrade as well. The elegance of the Akrapovic SLIP-ON package will please those riders who are relatively satisfied with the stock characteristics of the R6, except for the bulky stock muffler. You also get increased performance and a high-tech approach to both production and materials selection. For 2005, the R6 delivers more power than the 2004 model.

NOTE: Slip-On system with the HEXAGONAL muffler is also available for the 2004-2005 Yamaha YZF R6. Performance is identical to the oval muffler.

PERFORMANCE

Measurements of the Akrapovic SLIP-ON system on the YAMAHA YZF R6 (without muffler):

Power & Torque: the Akrapovic SLIP-ON system is not designed to pull the absolute maximum out of the engine; we have other systems in our range which will do that. However, even with this first-level component you will receive a boost in power. It starts around 3000 rpm and stays higher than the stock curve all the way to the top of the rpm range. With the Akrapovic SLIP-ON system you get an extra 1.8 HP at 13200 rpm, which puts 109.7 HP into the rear wheel of your Yamaha.

We managed to increase the torque from 2800 to 4000 rpm, after which the Akrapovic torque curve is identical to the stock curve until 4800 rpm. Above that, the Akrapovic curve exceeds the stock figures all the way to the top of the range.

CONFIGURATION

The SLIP-ON system is an exhaust system configuration made of two main parts: a muffler and a link-pipe. The link pipe connects to the stock header assembly. It is cylindrical and made of high-quality stainless steel. We also offer a titanium link pipe as an option. It is connected to both the header assembly and the muffler with sleeve joint connections held together with silicon-shielded tensioning springs. In addition to the springs, a metal clamp, which is included in the Akrapovic SLIP-ON kit, is used to attach the link pipe to the header assembly. The muffler for the SLIP-ON system is the familiar Akrapovic oval. In order to satisfy our customers' aesthetic demands, we offer two versions of the outer sleeve. You can order either the black cross-hatched pattern of carbon-fiber or the metallic sheen of titanium. No matter what your choice is, it will affect only the appearance of the exhaust system, while the performance of both options is identical. The metal parts on the interior of the muffler are made entirely of titanium, which keeps the weight to a minimum. The muffler is attached to the stock chassis hanging bracket with the renowned Akrapovic carbon-fiber clamp.

| | PERFORMANCE | | |
|--|---|---|--|
| | stock | AKRAPOVIC | max. increased power |
| max. rear wheel power HP / rpm (measured on Dynojet ATV) | 104.6 / 12700 (03-04) 107.9 / 13100 (2005) | 106.4 / 12700 (03-04) 109.7 / 13200 (2005) | 3 / 7900 (03-04) 1.6 / 13300 (2005) |

| | CONFIGURATION | | |
|------------|---------------|-----------|--|
| | header tubes | collector | link pipe |
| material | - | - | STAINLESS STEEL TITANIUM (optional) |
| tube shape | - | - | CYLINDRICAL |

| | | | |
|-------------------------------------|--|--|--|
| interference crossover tubes | - | lambda sensor | - |
| header tube inner sleeves | - | header tube flanges | - |
| header tubes - collector connection | - | collector / header tube - link pipe connection | SLEEVE JOINT + SILICON SHIELDED SPRING + METAL CLAMP |
| link pipe - muffler connection | SLEEVE JOINT + SILICON SHIELDED SPRING | muffler inlet cap / outlet cap | TITANIUM / TITANIUM CARBON-FIBER (hexagonal) |
| muffler metal interior | TITANIUM | muffler outer sleeve | TITANIUM / CARBON-FIBER |
| muffler clamp | CARBON-FIBER ROAD | muffler bracket | - |
| muffler insert | EU | - | heat shield |
| | US | - | catalytic converter |

| | ADDITIONAL DATA | | | | |
|---|---------------------------------|----------------|--------------------|--------------|------------------|
| | stock | AKRAPOVIC | | difference | |
| weight comparison (kg) | 3.70 | S.S. link pipe | TITANIUM link pipe | stock - S.S. | stock - titanium |
| | | 2.00 | - | 1.70 | - |
| noise measurements (dB / rpm) | stock | | AKRAPOVIC | | |
| | 92 / 6500 | | 99.3 / 6500 | | |
| possibility of periodic service without removing A.E.S. | oil | | oil filter | | |
| | YES | | YES | | |
| legal for street use | NO / YES (street legal version) | | | | |

Technical specifications of Akrapovic exhaust systems and related products subject to change without notice.

Product code: 105519 (S-Y6SO3-ZC), 105519 (S-Y6SO3-ZT) hexagonal
100448 (S-Y6SO3-C), 100449 (S-Y6SO3-T)

Akrapovic Slip-On Exhaust System for the Yamaha YZF R6 (2003 - 2005)



CARBON-FIBER
MUFFLER CLAMP

Road
Program

Product code: 105519 (S-Y6SO3-ZC), 105519 (S-Y6SO3-ZT) hexagonal

Akrapovic Slip-On Exhaust System for the Yamaha YZF R6 (2003 - 2005)



Akrapovic Exhaust System Technology copyright 2006, all rights reserved

Road
Program

Product code: 105519 (S-Y6SO3-ZC), 105519 (S-Y6SO3-ZT) hexagonal

Akrapovic Slip-On Exhaust System for the Yamaha YZF R6 (2003 - 2005)



Akrapovic Exhaust System Technology copyright 2006, all rights reserved

Road Program

Product code: 105519 (S-Y6SO3-ZC), 105519 (S-Y6SO3-ZT) hexagonal

Akrapovic Slip-On Exhaust System

for the Yamaha YZF R6 (2003 - 2005)

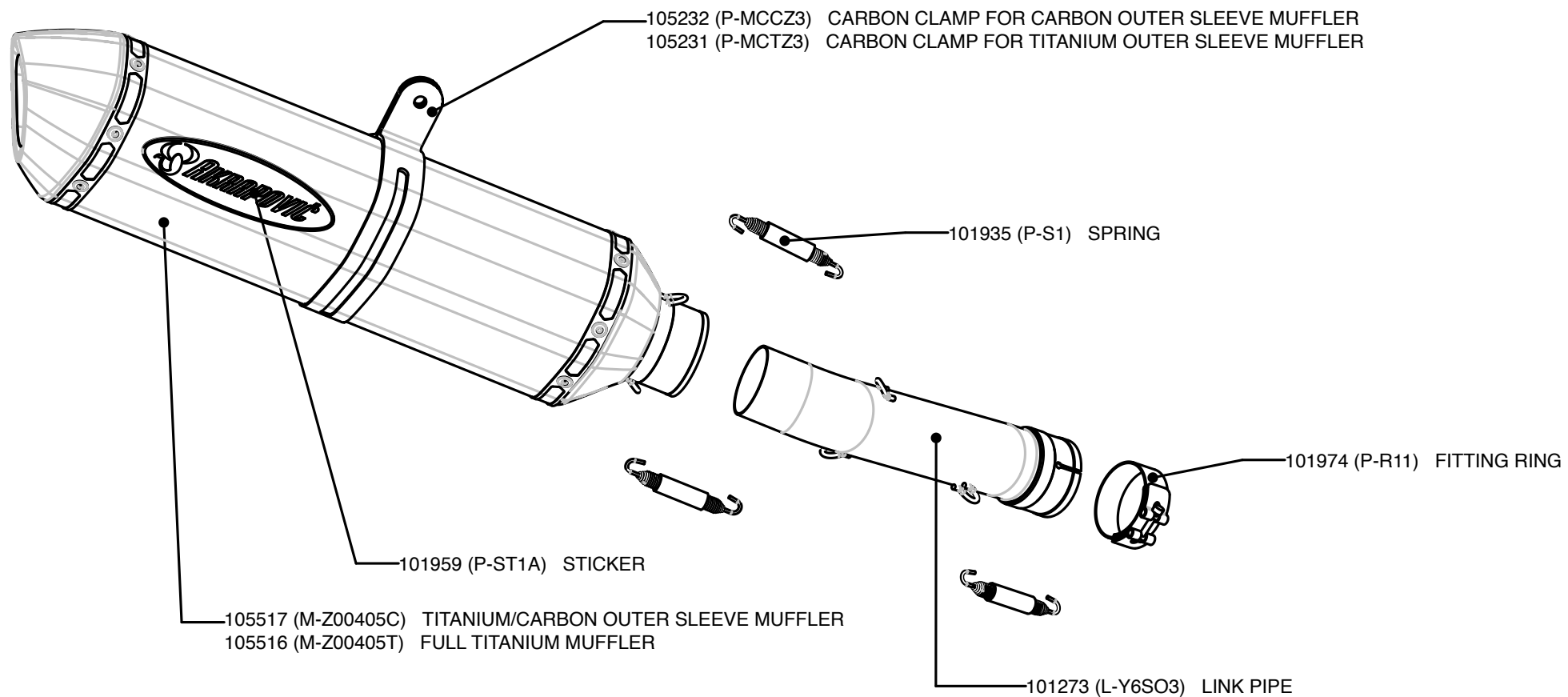

Akrapovic Exhaust System Technology copyright 2006, all rights reserved

Road Program

Product code: 105519 (S-Y6SO3-ZC), 105519 (S-Y6SO3-ZT) hexagonal

Akrapovic Slip-On Exhaust System for the Yamaha YZF R6 (2003 - 2005)



CARBON-FIBER
MUFFLER CLAMP

Product code: 100448 (S-Y6SO3-C), 100449 (S-Y6SO3-T)

Akrapovic Slip-On Exhaust System for the Yamaha YZF R6 (2003 - 2005)



Akrapovic Exhaust System Technology copyright 2006, all rights reserved

Road Program

Product code: 100448 (S-Y6SO3-C), 100449 (S-Y6SO3-T)

Akrapovic Slip-On Exhaust System for the Yamaha YZF R6 (2003 - 2005)



Akrapovic Exhaust System Technology copyright 2006, all rights reserved

Road Program

Product code: 100448 (S-Y6SO3-C), 100449 (S-Y6SO3-T)

Akrapovic Slip-On Exhaust System for the Yamaha YZF R6 (2003 - 2005)

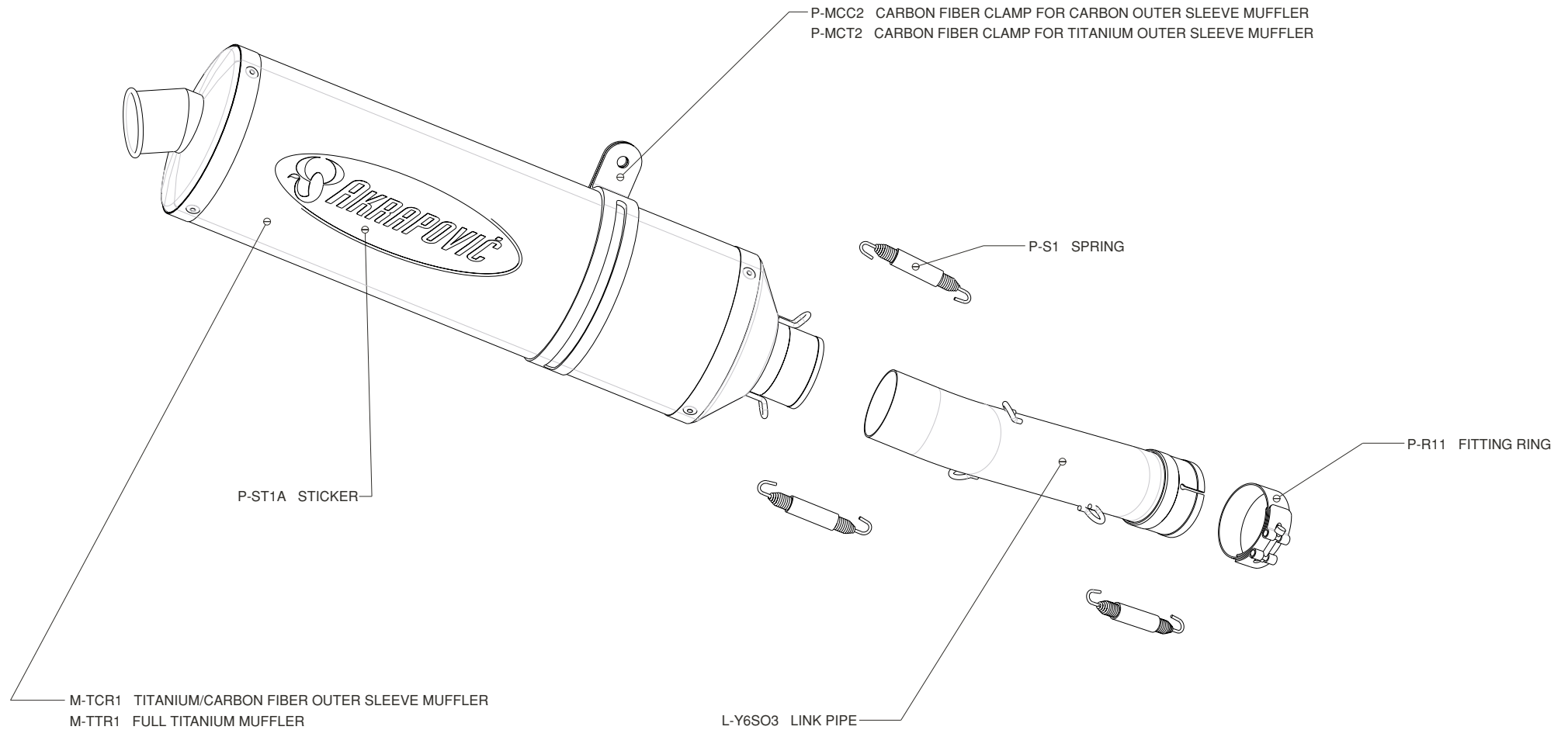

Akrapovic Exhaust System Technology copyright 2006, all rights reserved

Road Program

Product code: 100448 (S-Y6SO3-C), 100449 (S-Y6SO3-T)

Akrapovic Slip-On Exhaust System for the Yamaha YZF R6 (2003 - 2005)

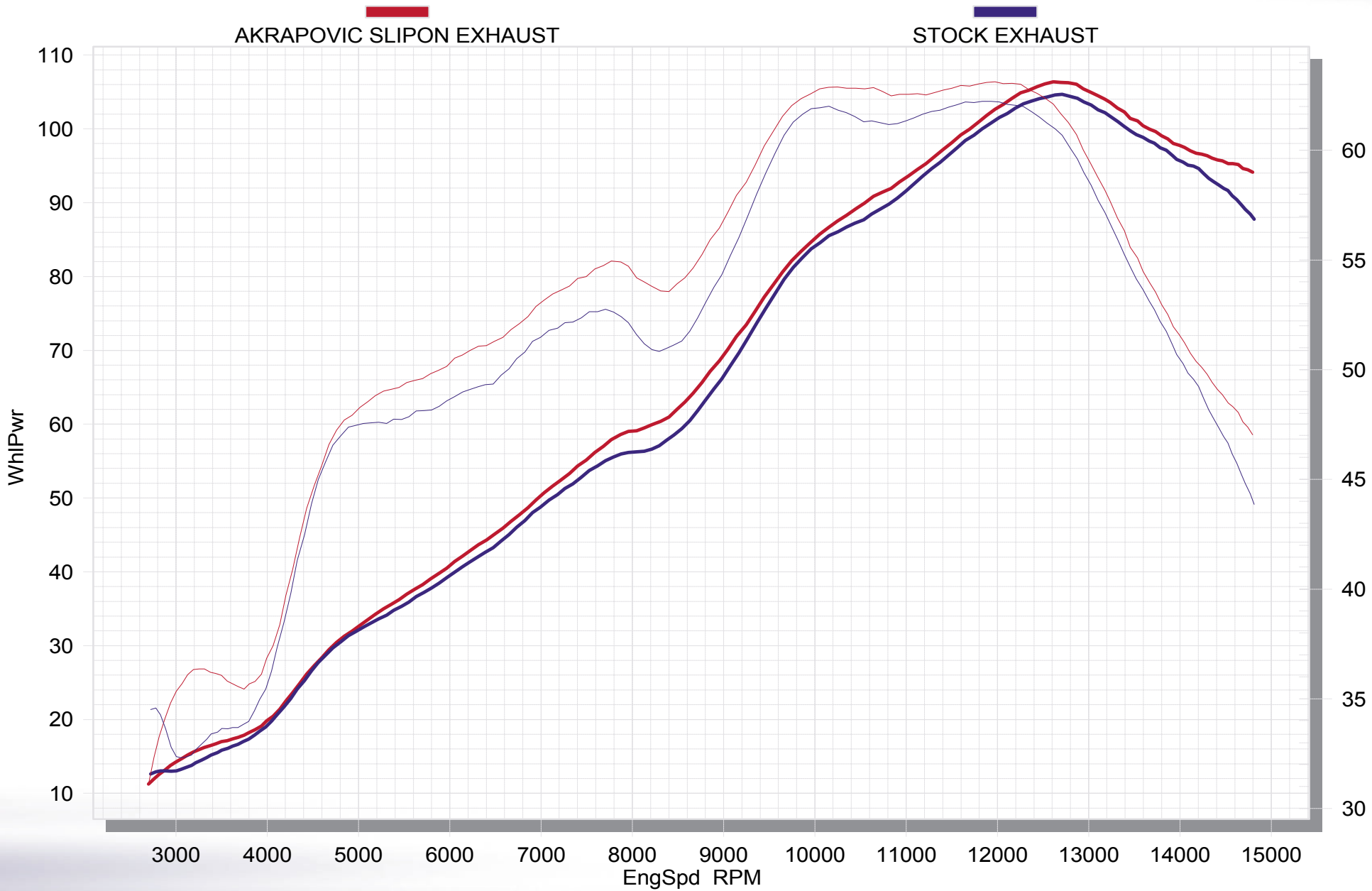

Road Program

Product code: 105519 (S-Y6SO3-ZC), 105519 (S-Y6SO3-ZT) hexagonal
100448 (S-Y6SO3-C), 100449 (S-Y6SO3-T)



Akrapovic Exhaust System Technology copyright 2006, all rights reserved