



Suzuki RM-Z 250 (2007)

Racing & Evolution Exhaust System

# Akrapovic Racing & Evolution Exhaust System

for the Suzuki RM-Z 250 (2007)

The Akrapovic Racing and Evolution systems with the ultra-modern HEXAGONAL muffler look great on the RMZ. And since these systems are designed for riders who expect maximum performance from their exhaust systems, the visual enhancement is matched by the performance increase. They are designed for two markets: for the European and non-US other markets they come with a built-in noise damper, and for the American market they come with an approved spark arrester.

## PERFORMANCE

Measurements of the Akrapovic EVOLUTION system on the SUZUKI RM-Z 250 (without muffler insert):

Power & Torque: both the Racing and the Evolution (they differ only in the choice of tubing materials) are an excellent match with the Suzuki engine. The complete exhaust system offers increased power and torque throughout the rpm range. At 11300 rpm we measured 34.9 HP.

## CONFIGURATION

The Akrapovic Racing and Evolution systems for the 2007 Suzuki RM-Z 250 are composed of a conical header tube attached to a conical link pipe with a sleeve joint, which is secured with a silicon-shielded spring. The systems differ only in their selection of tubing materials. The Racing uses stainless steel tubes, and the Evolution titanium. The link pipe is welded to the muffler.

The muffler is the HEXAGONAL design, with a titanium (Evolution) / stainless steel (Racing) inlet cap, titanium (Evolution) / stainless steel (Racing) perforated inner sleeve and titanium outer sleeve (both versions), and a carbon-fiber outlet cap (both versions). The muffler is attached to the frame using an Akrapovic offroad carbon-fiber clamp.

For the Racing version either the stock heat shield or the optional Akrapovic carbon-fiber heat shield can be mounted on the header tube. The Evolution is equipped with the carbon-fiber heat shield as standard equipment. The muffler is designed for two markets: for the European and other non-US markets it comes with a built-in noise damper, and for the American market it comes with an approved spark arrester.

	PERFORMANCE		
	stock	AKRAPOVIC	max. increased power
max. rear wheel power HP / rpm (measured on Dynojet ATV)	34.5 / 11700	34.9 / 11300	1.7 / 7000

	CONFIGURATION		
	header tubes	collector	link pipe
material	TITANIUM (Evolution) STAINLESS STEEL (Racing)	-	TITANIUM (Evolution) STAINLESS STEEL (Racing)
tube shape	CONICAL	-	CONICAL
interference crossover tubes	-	lambda sensor	-
header tube inner sleeves	S.S. CNC MACHINED	header tube flanges	S.S. LASER CUT
header tubes - collector connection	-	collector / header tube - link pipe connection	SLEEVE JOINT + SILICON SHIELDED SPRING
link pipe - muffler connection	WELDED	muffler inlet cap / outlet cap	TITANIUM (Evolution) STAINLESS STEEL (Racing) / CARBON-FIBER
muffler metal interior	TITANIUM (Evolution) STAINLESS STEEL (Racing)	muffler outer sleeve	TITANIUM
muffler clamp	CARBON-FIBER OFF ROAD	muffler bracket	-
muffler insert	EU	NOISE DAMPER	CARBON-FIBER (Evolution) (optional - Racing)
	US	SPARK ARRESTER	

	ADDITIONAL DATA				
	stock	AKRAPOVIC		difference	
weight comparison (kg)	3.49	RACING	EVOLUTION	stock - RACING	stock - EVOLUTION
		2.73	2.15	0.76	1.34
noise measurements (dB / rpm)	stock		AKRAPOVIC		
	96 / 5000		96 / 5000		
possibility of periodic service without removing A.E.S.	oil		oil filter		
	YES		YES		
legal for street use	NO				

Technical specifications of Akrapovic exhaust systems and related products subject to change without notice.

Product code: 106536 (S-S2MR1-QT), 106535 (S-S2MET1-QT)  
106538 (S-S2MR1-QTA), 106537 (S-S2MET1-QTA) US market

# Akrapovic Racing & Evolution Exhaust System

for the Suzuki RM-Z 250 (2007)



CARBON-FIBER  
MUFFLER CLAMP

Off-Road  
Program

Product code: 106536 (S-S2MR1-QT), 106535 (S-S2MET1-QT)  
106538 (S-S2MR1-QTA), 106537 (S-S2MET1-QTA) US market

# Akrapovic Racing & Evolution Exhaust System for the Suzuki RM-Z 250 (2007)



Akrapovic Exhaust System Technology copyright 2006, all rights reserved

Off-Road  
Program

Product code: 106536 (S-S2MR1-QT), 106535 (S-S2MET1-QT)  
106538 (S-S2MR1-QTA), 106537 (S-S2MET1-QTA) US market

# Akrapovic Racing & Evolution Exhaust System for the Suzuki RM-Z 250 (2007)



Akrapovic Exhaust System Technology copyright 2006, all rights reserved

Off-Road  
Program

Product code: 106536 (S-S2MR1-QT), 106535 (S-S2MET1-QT)  
106538 (S-S2MR1-QTA), 106537 (S-S2MET1-QTA) US market

# Akrapovic Racing & Evolution Exhaust System

for the Suzuki RM-Z 250 (2007)

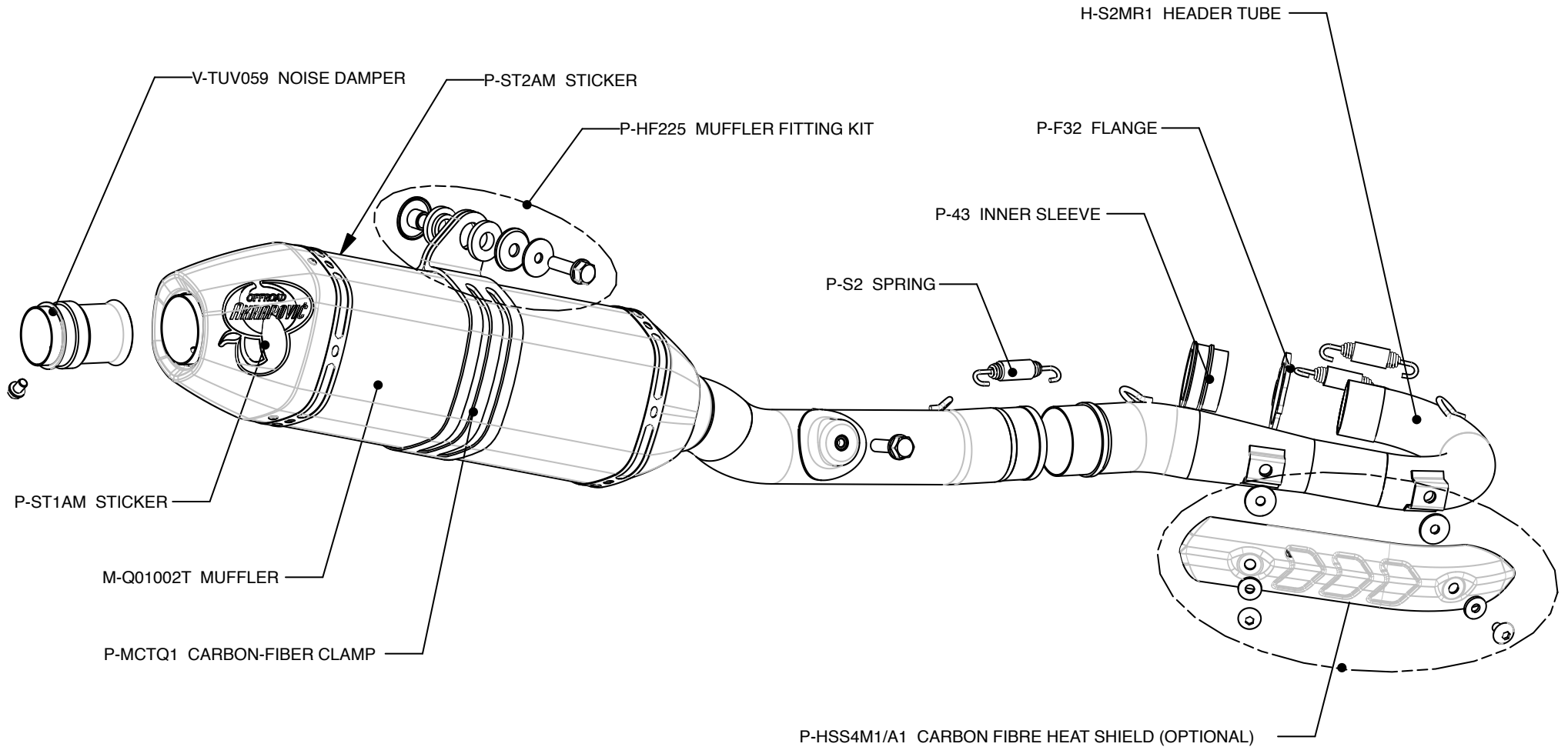

Akrapovic Exhaust System Technology copyright 2006, all rights reserved

Off-Road Program

Product code: 106538 (S-S2MR1-QTA) US market



# Akrapovic Racing & Evolution Exhaust System

for the Suzuki RM-Z 250 (2007)

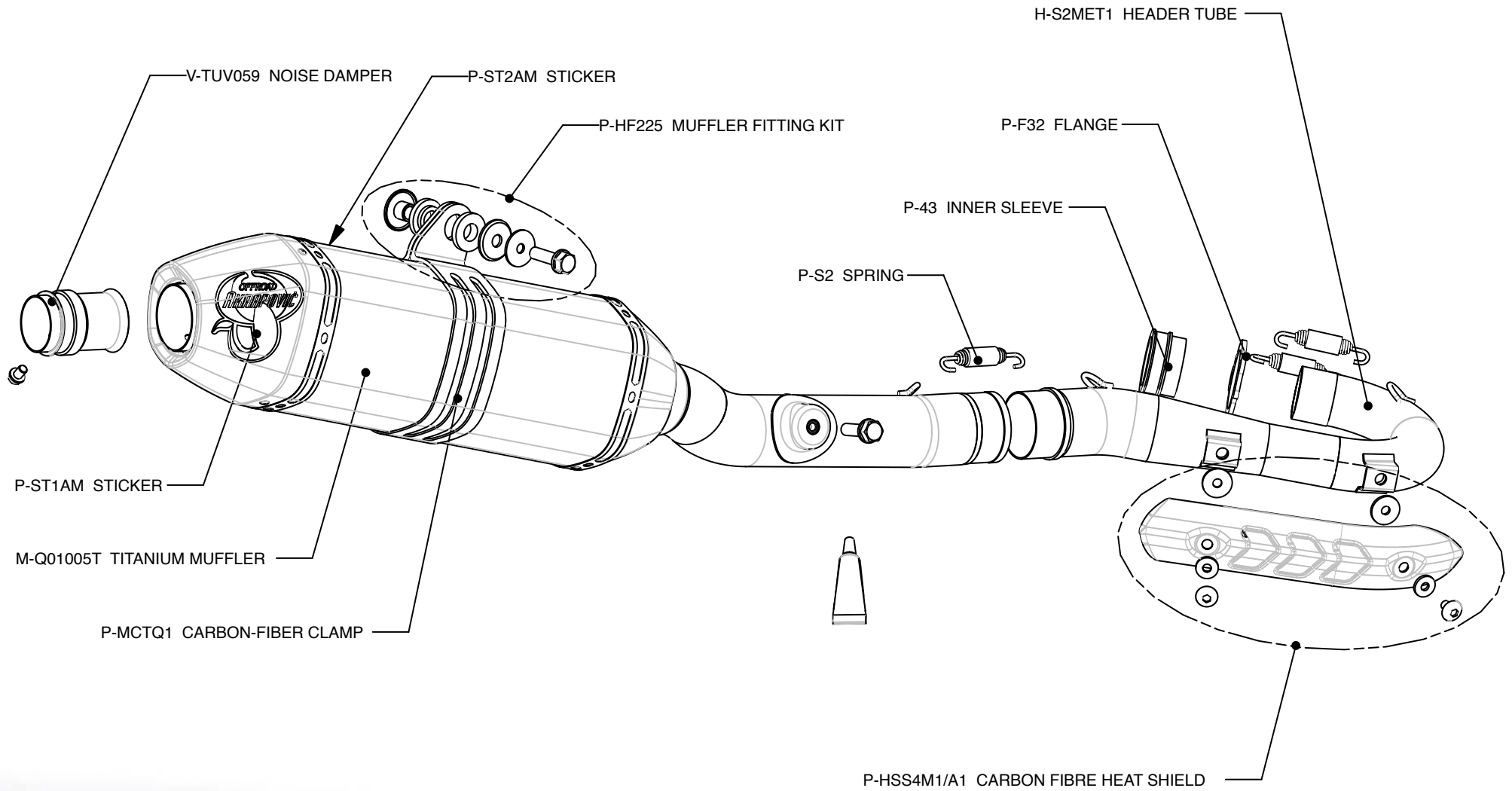

Akrapovic Exhaust System Technology copyright 2006, all rights reserved

Off-Road Program

Product code: 106535 (S-S2MET1-QT)



# Akrapovic Racing & Evolution Exhaust System

for the Suzuki RM-Z 250 (2007)

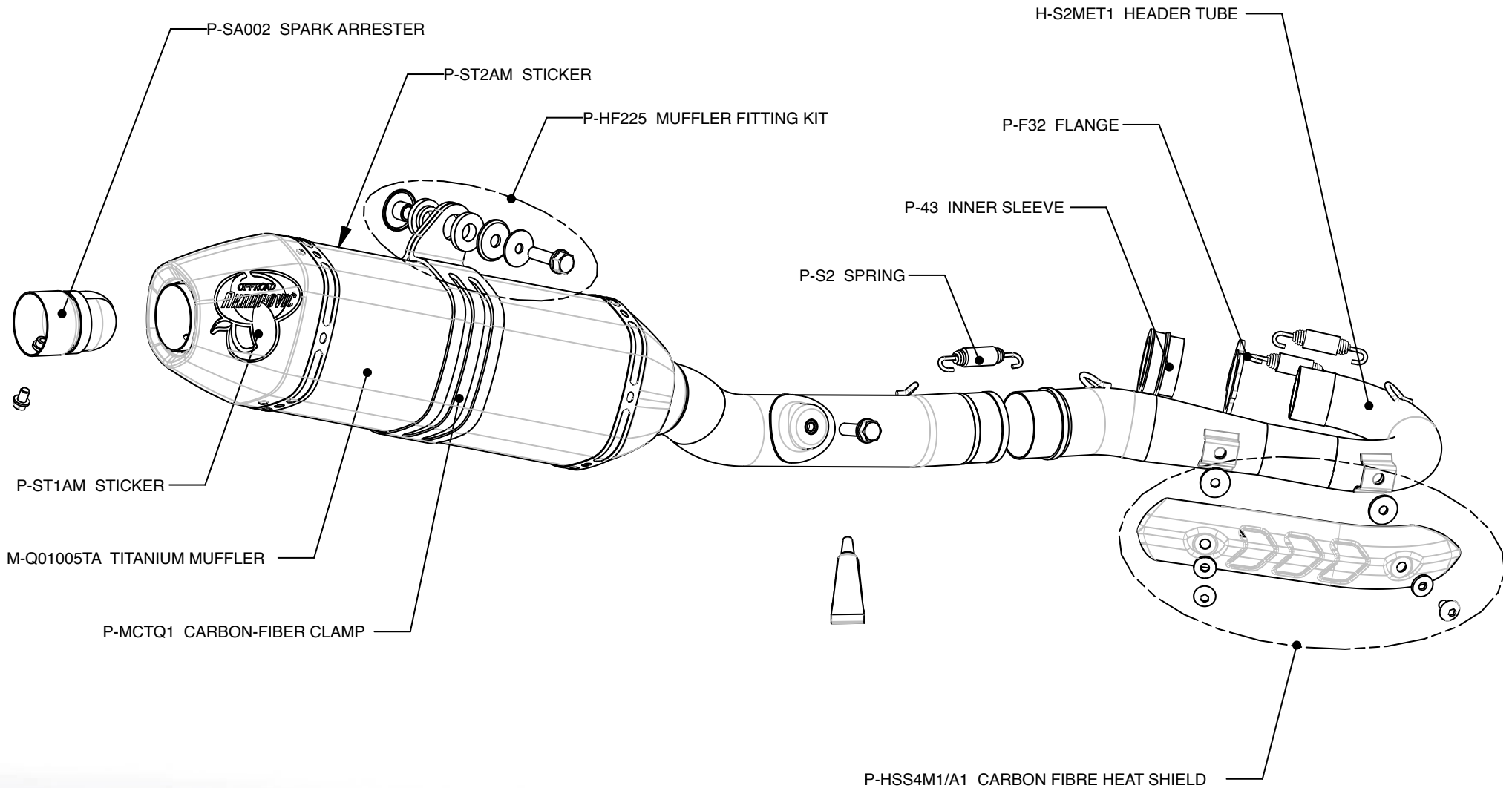

Akrapovic Exhaust System Technology copyright 2006, all rights reserved

Off-Road Program

Product code: 106537 (S-S2MET1-QTA) US market



# Akrapovic Racing & Evolution Exhaust System

for the Suzuki RM-Z 250 (2007)

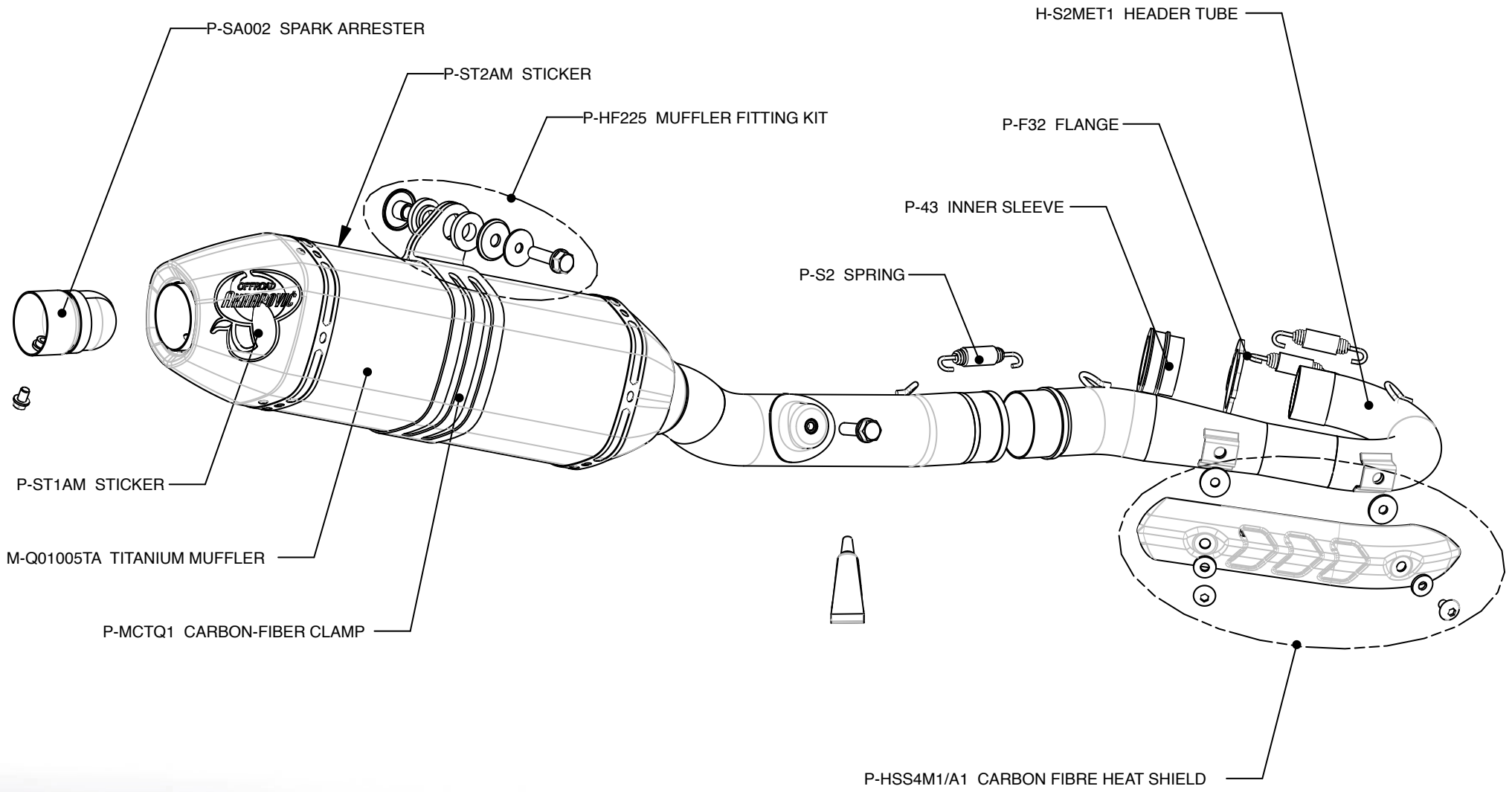

Off-Road Program

Product code: 106536 (S-S2MR1-QT), 106535 (S-S2MET1-QT)  
106538 (S-S2MR1-QTA), 106537 (S-S2MET1-QTA) US market



Akrapovic Exhaust System Technology copyright 2006, all rights reserved

# Akrapovic Racing & Evolution Exhaust System

for the Suzuki RM-Z 250 (2007)

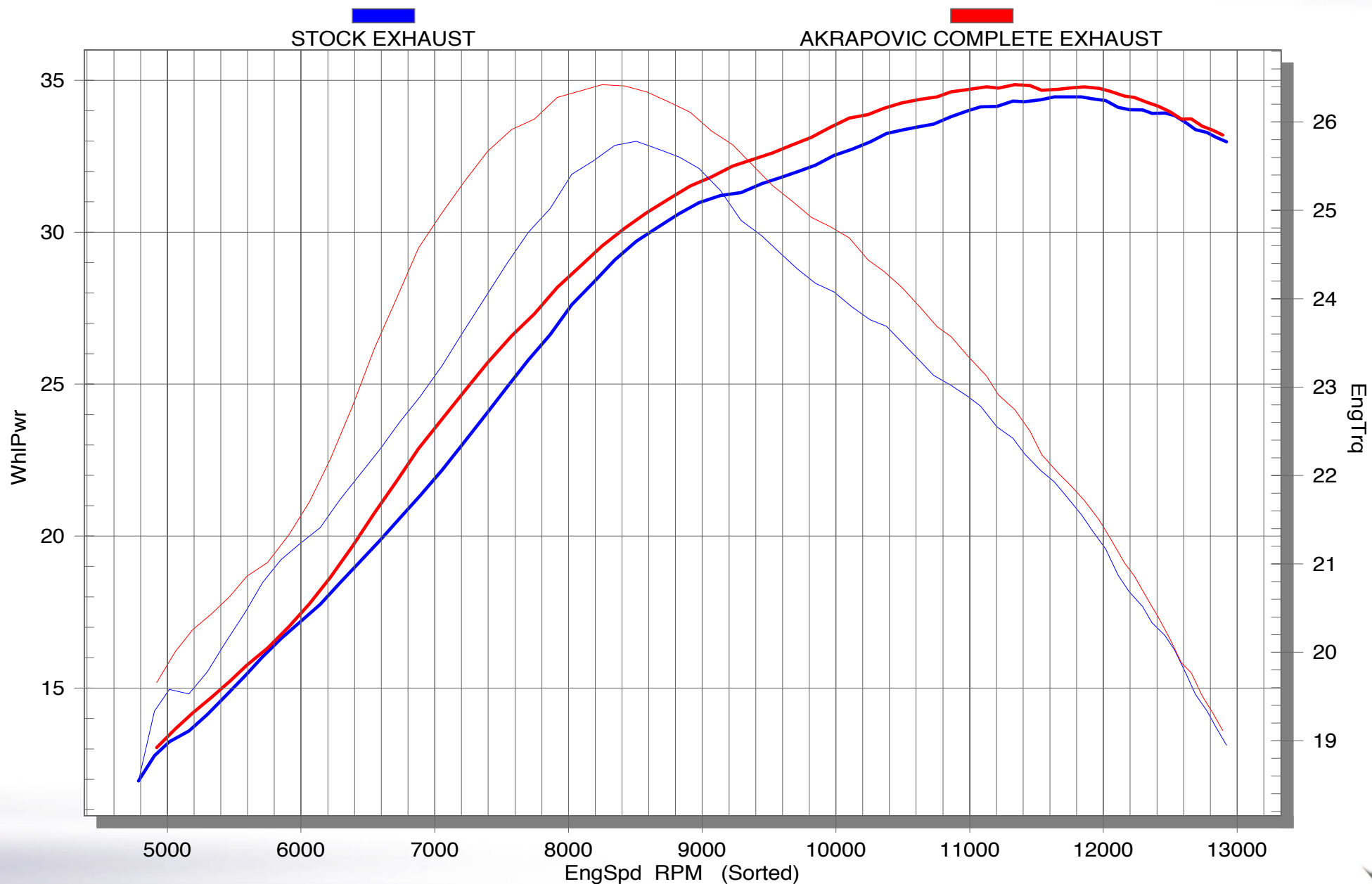

Off-Road Program

Product code: 106536 (S-S2MR1-QT), 106535 (S-S2MET1-QT)  
106538 (S-S2MR1-QTA), 106537 (S-S2MET1-QTA) US market

