



Suzuki GSX-R 750 (2006)

Racing & Evolution Exhaust System

Akrapovic Racing & Evolution Exhaust System

for the suzuki GSX-R 750 (2006)

The Akrapovic Racing and Evolution systems are designed for riders who expect the maximum from their exhaust system and know how to take advantage of it. The Racing and Evolution systems make the Suzuki substantially more responsive, and the HEXAGONAL muffler also provides a visual modification. The Street Legal versions conform to all regulations for street use.

PERFORMANCE

Measurements of the Akrapovic EVOLUTION system on the SUZUKI GSX-R 750 (without muffler insert):

Power & Torque: the Akrapovic Racing and Evolution systems increase the responsiveness of the Suzuki and fill out the power and torque curves. The increase in torque starts already at around 3000 rpm, while the power curve increase starts around 5400 rpm and leads all the way to the top of the range. At 13400 rpm we measured a massive 143 HP.

CONFIGURATION

The Racing and Evolution systems differ only in the selection of tubing materials. The Racing is made of stainless steel, and the Evolution is made of titanium. Both systems have conical tubes, cylindrical collectors, and a conical link pipe. All of the system components are attached with sleeve joints secured with silicon-shielded springs. The header tubes come with interference crossover tubes, and the systems also include a fitting for attaching a lambda sensor. The HEXAGONAL muffler is definitely the most eye-catching element of the system. It is made of a titanium inlet cap and perforated inner sleeve, while the outlet cap is made of carbon fiber. The outer sleeve is available in either titanium or carbon fiber. The muffler is attached to the frame using an Akrapovic carbon fiber clamp and carbon fiber bracket. The Street Legal version comes with an approved noise damper, and conforms to all regulations for street use. Both systems are available with an optional catalytic converter.

	PERFORMANCE		
	stock	AKRAPOVIC	max. increased power
max. rear wheel power HP / rpm (measured on SuperFlow Cycle Dyn)	136.2 / 13200	143.1 / 13400	7.7 / 13400

	CONFIGURATION		
	header tubes	collector	link pipe
material	STAINLESS STEEL (Racing) TITANIUM (Evolution)	STAINLESS STEEL (Racing) TITANIUM (Evolution)	STAINLESS STEEL (Racing) TITANIUM (Evolution)
tube shape	CONICAL	CYLINDRICAL	CONICAL

interference crossover tubes	YES	lambda sensor	YES
header tube inner sleeves	S.S. CNC MACHINED	header tube flanges	ALU CNC MACHINED
header tubes - collector connection	SLEEVE JOINT + SILICON SHIELDED SPRING	collector / header tube - link pipe connection	SLEEVE JOINT + SILICON SHIELDED SPRING
link pipe - muffler connection	SLEEVE JOINT + SILICON SHIELDED SPRING	muffler inlet cap / outlet cap	TITANIUM / CARBON-FIBER
muffler metal interior	TITANIUM	muffler outer sleeve	TITANIUM / CARBON-FIBER
muffler clamp	CARBON-FIBER	muffler bracket	CARBON-FIBER
muffler insert	EU	NOISE DAMPER	-
	US	-	catalytic converter

	ADDITIONAL DATA				
	stock	AKRAPOVIC		difference	
		RACING	EVOLUTION	stock - RACING	stock - EVOLUTION
weight comparison (kg)	9.90	4.93	3.69	4.97	6.21

noise measurements (dB / rpm)	stock	AKRAPOVIC
	100 / 6750	100 / 6750 (Street Legal version) 102 / 6750 (open)
possibility of periodic service without removing A.E.S.	oil	oil filter
	YES	YES
legal for street use	YES (Street Legal version)	

Technical specifications of Akrapovic exhaust systems and related products subject to change without notice.

Product code: S-S7R6L-ZC, S-S7RL-ZT (racing)
S-S7R6L-HZC, S-S7RL-HZT (racing homologated),
S-S7RFT6TL-ZC, S-S7RFT6TL-ZT (evolution),
S-S7RFT6TL-HZC, S-S7RFT6TL-HZT (evolution homologated)

Akrapovic Exhaust System for the Suzuki GSX-R 750 (2006)



Akrapovic Exhaust System Technology copyright 2006. all rights reserved

Road
Program

Akrapovic Exhaust System for the Suzuki GSX-R 750 (2006)



Akrapovic Exhaust System Technology copyright 2006. all rights reserved

Road Program

Akrapovic Racing & Evolution Exhaust System

for the suzuki GSX-R 750 (2006)

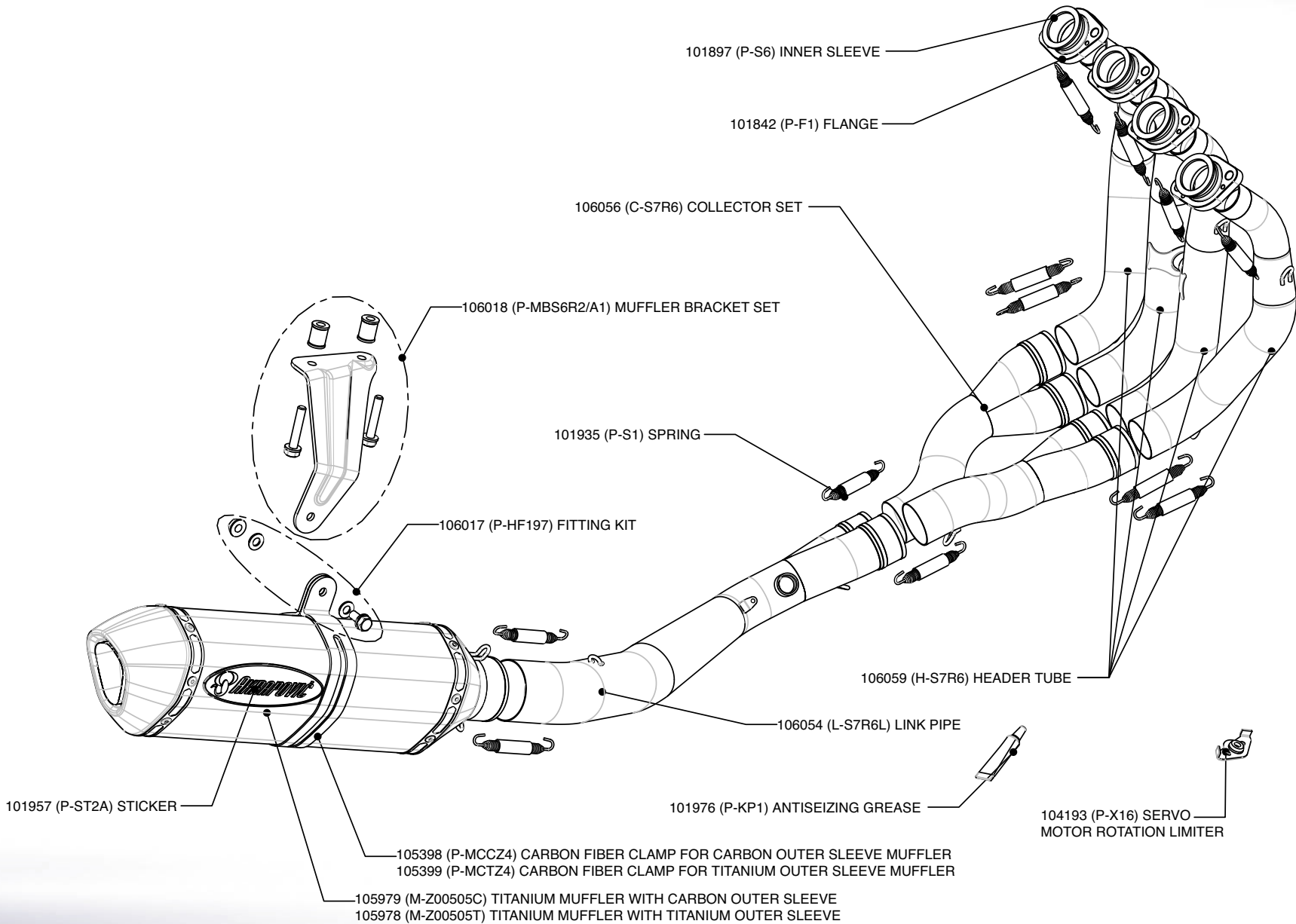

Product code: S-S7R6L-ZC, S-S7RL-ZT (racing)

Akrapovic Racing & Evolution Exhaust System

for the suzuki GSX-R 750 (2006)

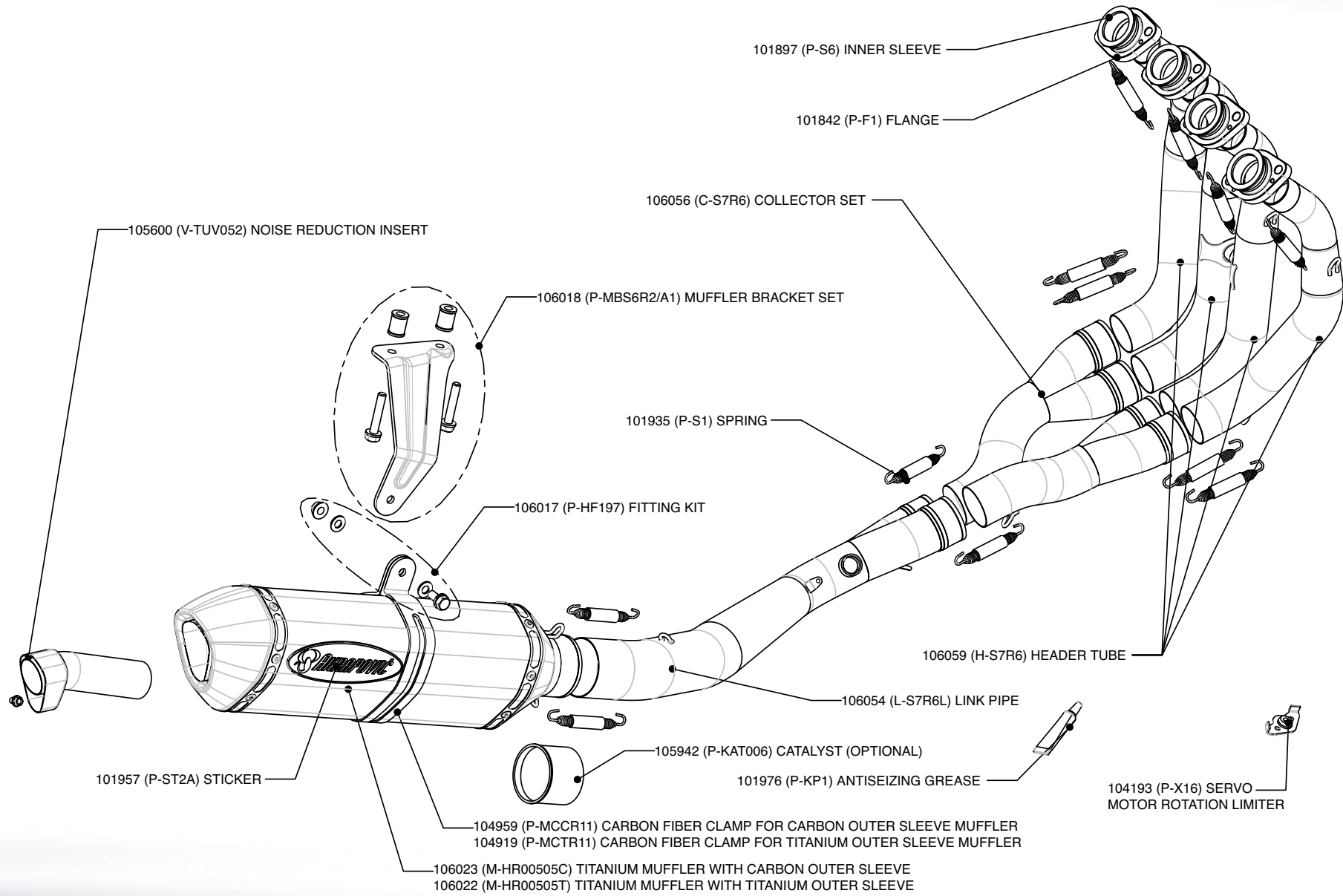

Road Program

Product code: S-S7R6L-HZC, S-S7RL-HZT (racing homologated)

Akrapovic Racing & Evolution Exhaust System

for the suzuki GSX-R 750 (2006)

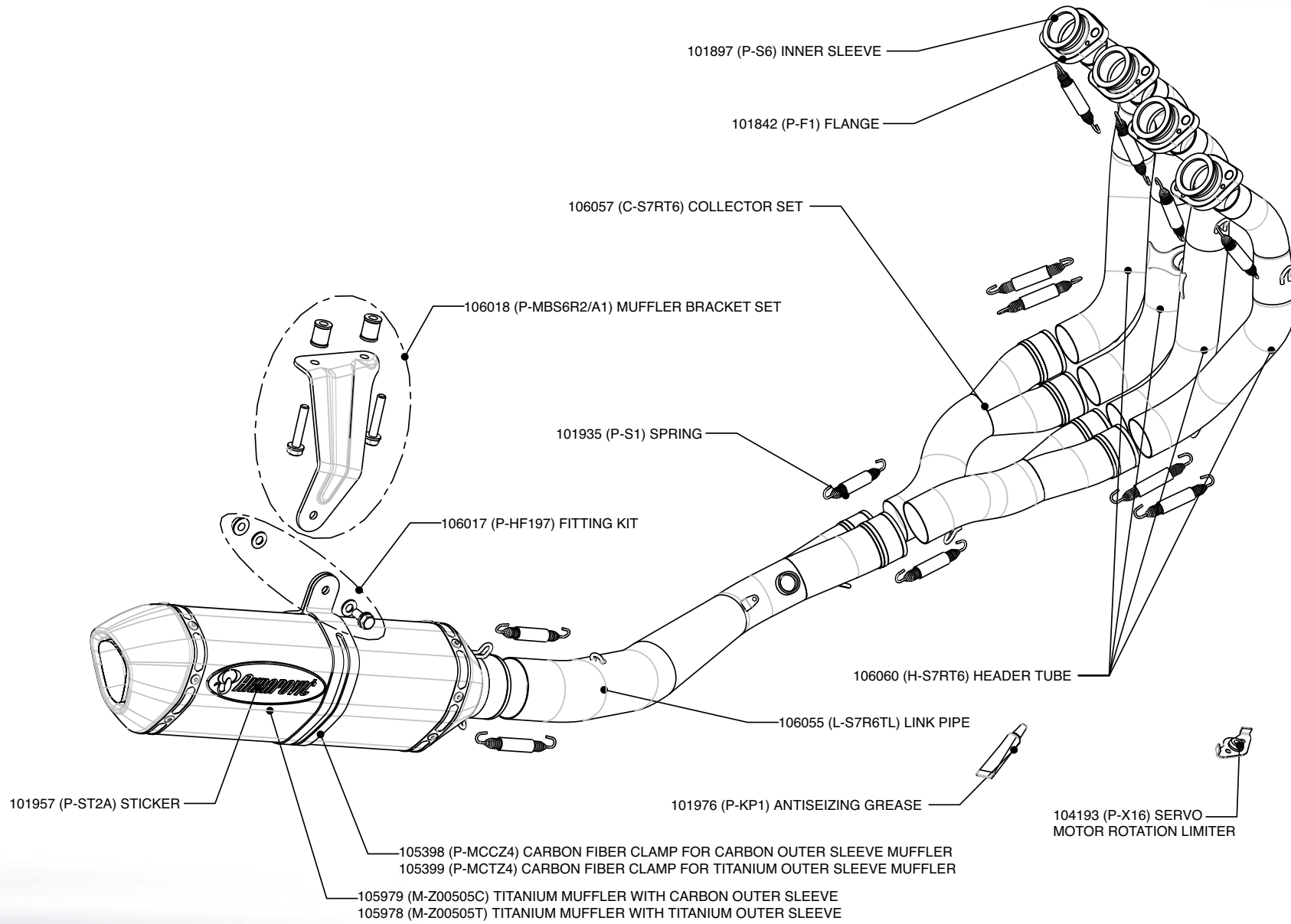

Road Program

Product code: S-S7RFT6TL-ZC, S-S7RFT6TL-ZT (evolution)

Akrapovic Racing & Evolution Exhaust System

for the suzuki GSX-R 750 (2006)

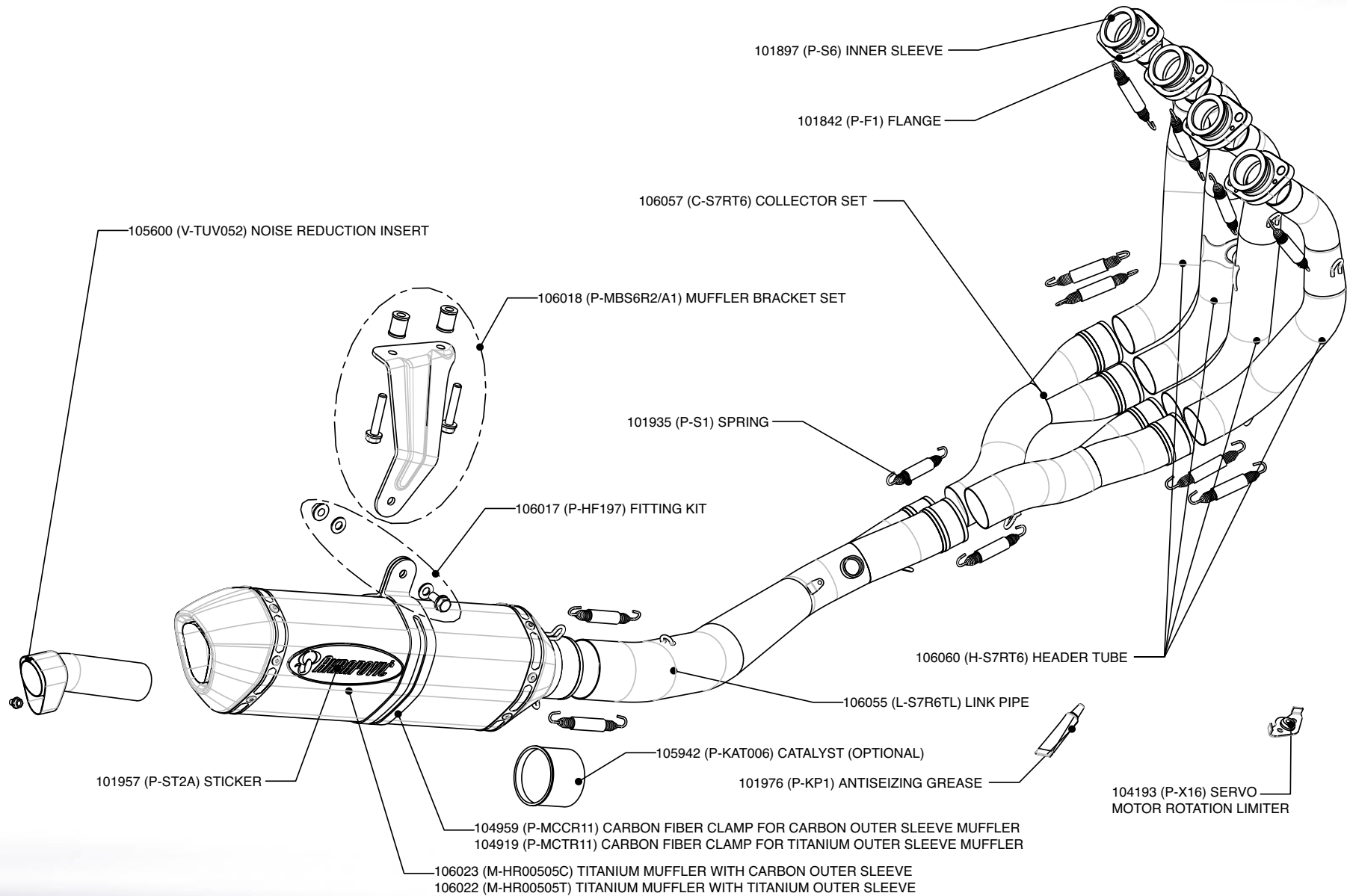

Akrapovic Exhaust System Technology copyright 2006, all rights reserved

Road Program

Product code: S-S7RFT6TL-HZC, S-S7RFT6TL-HZT (evolution homologated)

Akrapovic Racing & Evolution Exhaust System for the suzuki GSX-R 750 (2006)

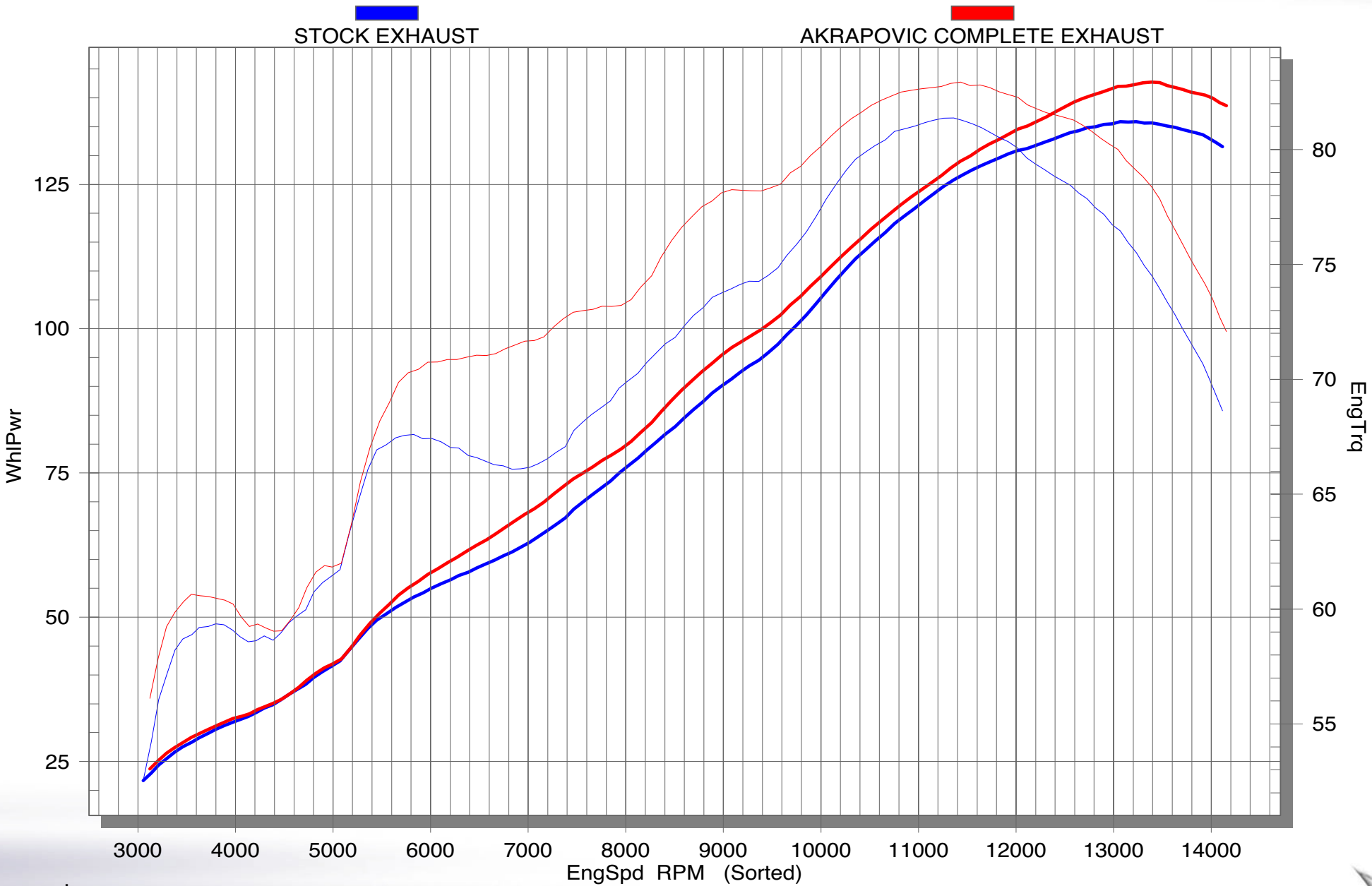

Road Program

Product code: S-S7R6L-ZC, S-S7RL-ZT (racing)
 S-S7R6L-HZC, S-S7RL-HZT (racing homologated),
 S-S7RFT6TL-ZC, S-S7RFT6TL-ZT (evolution),
 S-S7RFT6TL-HZC, S-S7RFT6TL-HZT (evolution homologated)



Akrapovic Exhaust System Technology copyright 2006. all rights reserved