



Suzuki GSX-R 750 (2006 - 2007)

Racing & Evolution Exhaust System

# Akrapovic Racing & Evolution Exhaust System

for the Suzuki GSX-R 750 (2006 - 2007)

The Akrapovic Racing2 and Evolution2 open systems are designed for riders in road racing closed course competition and for those who attend trackdays and expect the maximum from their exhaust system and know how to take advantage of it. This exhaust systems are within strict FIM and AMA supersport and superstock regulations. The Racing2 and Evolution2 open systems make the Suzuki substantially more responsive, and the HEXAGONAL muffler also provides a great visual modification.

## PERFORMANCE

Measurements of the Akrapovic EVOLUTION2 open system on the SUZUKI GSX-R 750 (without muffler insert):

Power & Torque: the Akrapovic exhaust system increase the responsiveness of the Suzuki and fill out the power and torque curves. The increase in torque starts already at around 3000 rpm, while the power curve increase starts around 5400 rpm and leads all the way to the top of the range. At 13400 rpm we measured a massive 141 HP.

## CONFIGURATION

The Racing and Evolution systems differ only in the selection of tubing materials. The Racing is made of stainless steel, and the Evolution is made of titanium. Both systems have conical tubes, cylindrical collectors, and a conical link pipe. All of the system components are attached with sleeve joints secured with silicon-shielded springs. The header tubes come with interference crossover tubes, and the systems also include a fitting for attaching a lambda sensor. The HEXAGONAL muffler is definitely the most eye-catching element of the system. It is made of a titanium inlet cap and perforated inner sleeve, while the outlet cap is made of carbon fiber. The outer sleeve is available in titanium. The muffler is attached to the frame using an Akrapovic carbon fiber clamp and carbon fiber bracket.

	PERFORMANCE		
	stock	AKRAPOVIC	max. increased power
max. rear wheel power HP / rpm (measured on Dynojet ATV)	134 / 13200	141 / 13400	7.1 / 13400

	CONFIGURATION		
	header tubes	collector	link pipe
material	S.S. / Ti	S.S. / Ti	S.S. / Ti
tube shape	CONICAL	CYLINDRICAL	CYLINDRICAL

interference crossover tubes	YES	lambda sensor	YES	
header tube inner sleeves	S.S. CNC MACHINED	header tube flanges	ALU CNC MACHINED	
header tubes - collector connection	SLEEVE JOINT + SILICON SHIELDED SPRING	collector / header tube - link pipe connection	SLEEVE JOINT + SILICON SHIELDED SPRING	
link pipe - muffler connection	WELDED	muffler inlet cap / outlet cap	S.S.-Carb.-fiber / Ti-Carb.-fiber	
muffler metal interior	S.S. / Ti	muffler outer sleeve	Ti	
muffler clamp	Carbon-fiber	muffler bracket	S.S.	
muffler insert	EU	YES	heat shield	NO
	US	-	catalytic converter	NO

	ADDITIONAL DATA				
	stock	AKRAPOVIC		difference	
		S.S. link pipe	TITANIUM link pipe	stock - S.S.	stock - titanium
weight comparison (kg)	9.9	4.2	3.23	5.7	6.67

noise measurements (dB / rpm)	stock	AKRAPOVIC
	102 / 6600	102 / 6600(with insert)
possibility of periodic service without removing A.E.S.	oil	oil filter
	YES	YES
legal for street use	NO	

Technical specifications of Akrapovic exhaust systems and related products subject to change without notice.

Product code: 107910 (S-S7R7-TC), 107909 (S-S7R7-TT)  
107878 (S-S7RFT7-TC) 107877 (S-S7RFT7-TT)

# Akrapovic Racing & Evolution Exhaust System for the Suzuki GSX-R 750 (2006 - 2007)

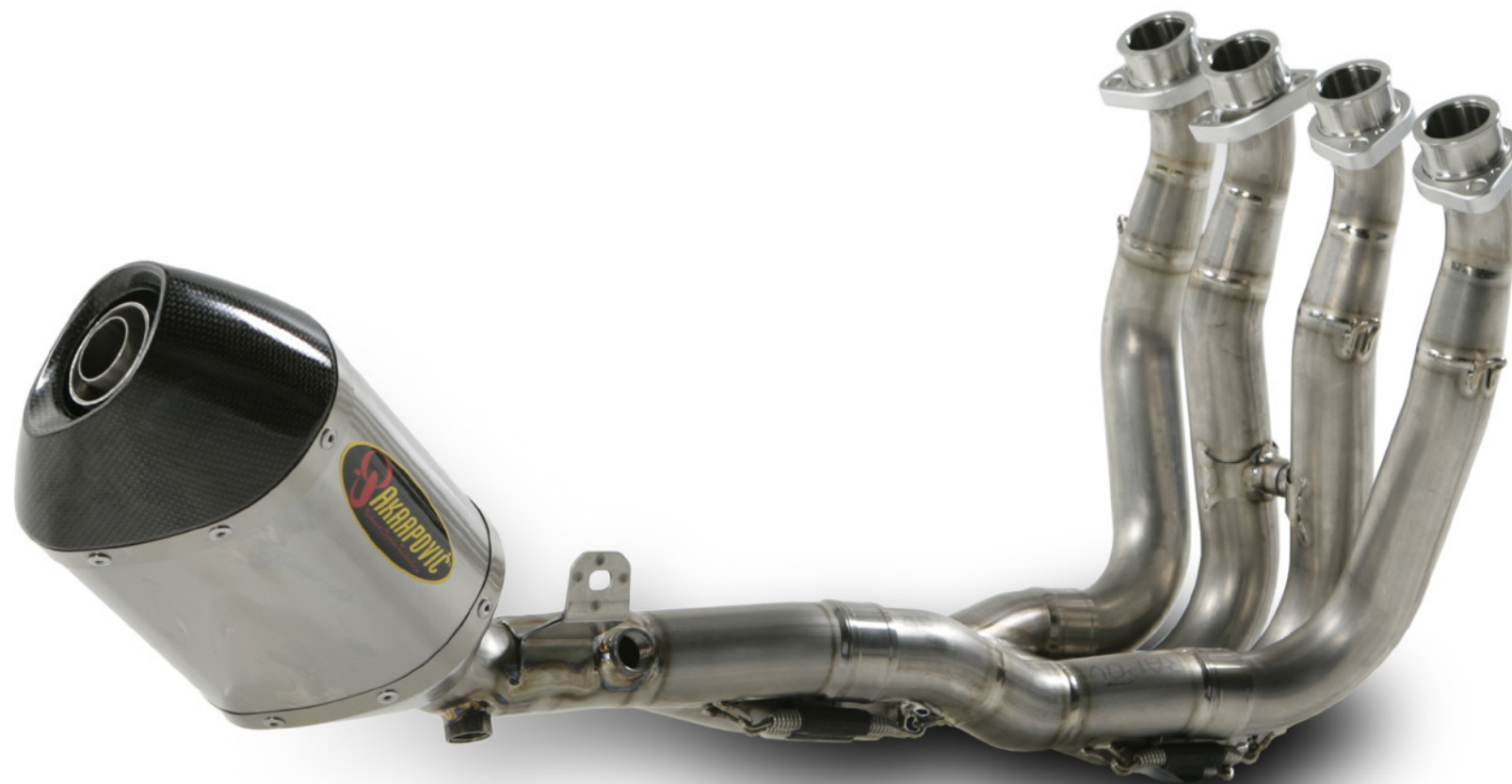

Akrapovic Exhaust System Technology copyright 2007, all rights reserved

Road  
Program

Product code: 107910 (S-S7R7-TC), 107909 (S-S7R7-TT)  
107878 (S-S7RFT7-TC) 107877 (S-S7RFT7-TT)

# Akrapovic Racing & Evolution Exhaust System for the Suzuki GSX-R 750 (2006 - 2007)



Akrapovic Exhaust System Technology copyright 2007, all rights reserved

Road  
Program

Product code: 107910 (S-S7R7-TC), 107909 (S-S7R7-TT)  
107878 (S-S7RFT7-TC) 107877 (S-S7RFT7-TT)

# Akrapovic Racing & Evolution Exhaust System for the Suzuki GSX-R 750 (2006 - 2007)



Akrapovic Exhaust System Technology copyright 2007, all rights reserved

Road Program

Product code: 107910 (S-S7R7-TC), 107909 (S-S7R7-TT)  
107878 (S-S7RFT7-TC) 107877 (S-S7RFT7-TT)

# Akrapovic Racing & Evolution Exhaust System

for the Suzuki GSX-R 750 (2006 - 2007)

**SUZUKI GSX-R 750 Complete exhaust system/Racing system, model year: 2006**

**Product code: 106067 (S-S7R6L-ZT)  
106068 (S-S7R6L-ZC)**

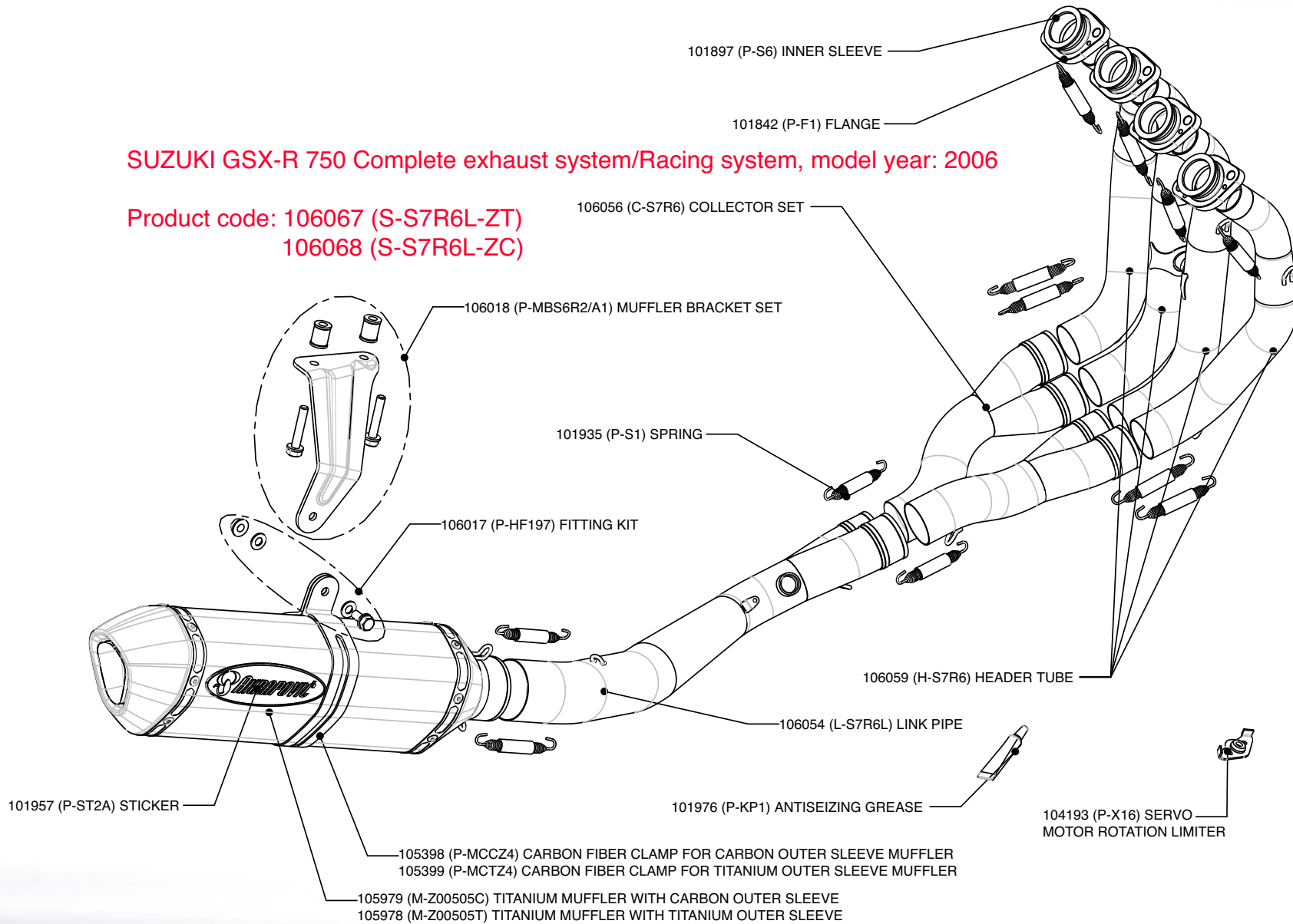

Product code: 107910 (S-S7R7-TC), 107909 (S-S7R7-TT)  
107878 (S-S7RFT7-TC) 107877 (S-S7RFT7-TT)

# Akrapovic Racing & Evolution Exhaust System

for the Suzuki GSX-R 750 (2006 - 2007)

**SUZUKI GSX-R 750 Complete exhaust system/Evolution line, model year: 2006**

**Product code: 106061 (S-S7RFT6TL-ZT)  
106062 (S-S7RFT6TL-ZC)**

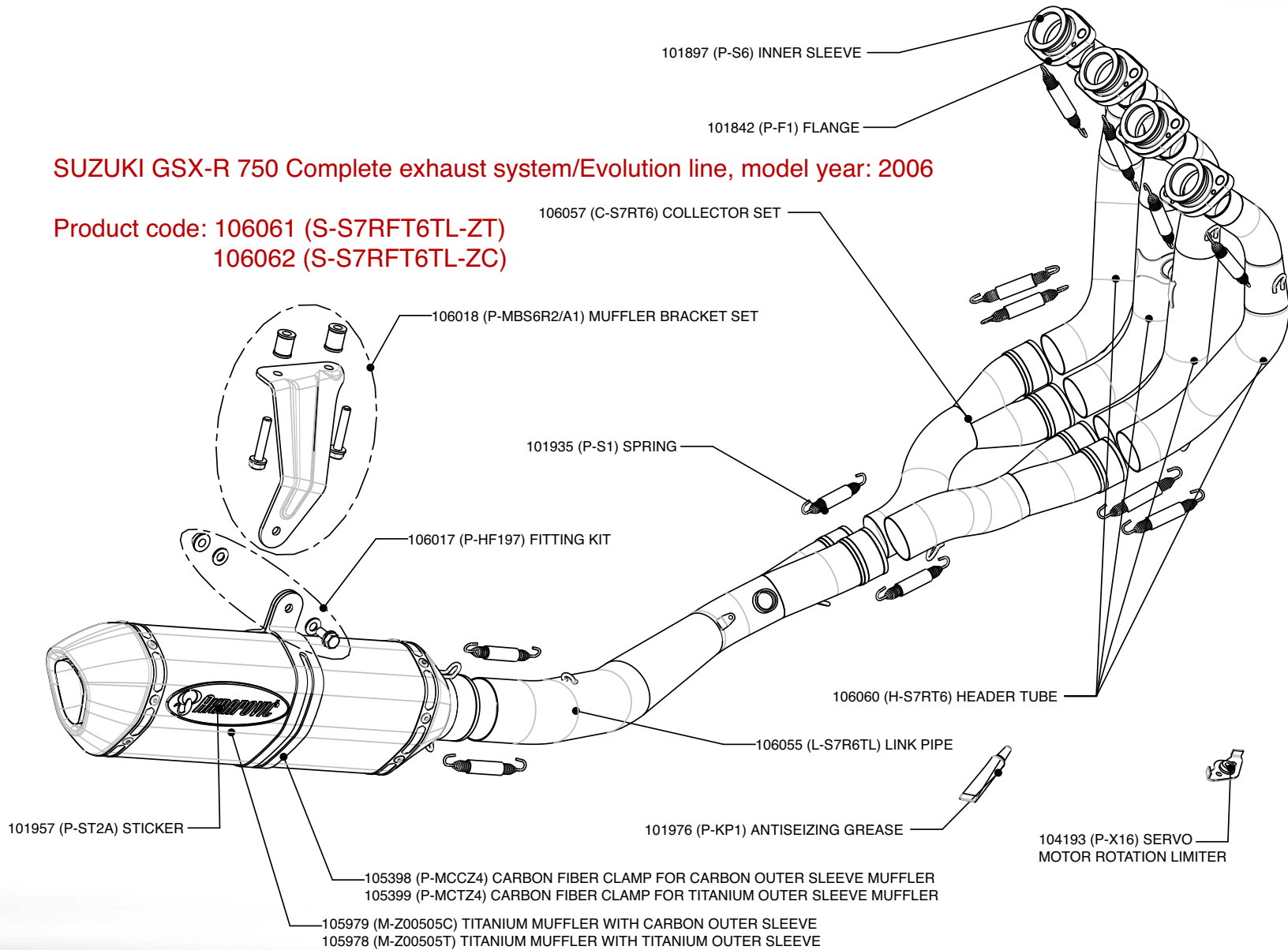

Road Program

Product code: 107910 (S-S7R7-TC), 107909 (S-S7R7-TT)  
107878 (S-S7RFT7-TC) 107877 (S-S7RFT7-TT)

# Akrapovic Racing & Evolution Exhaust System

for the Suzuki GSX-R 750 (2006 - 2007)

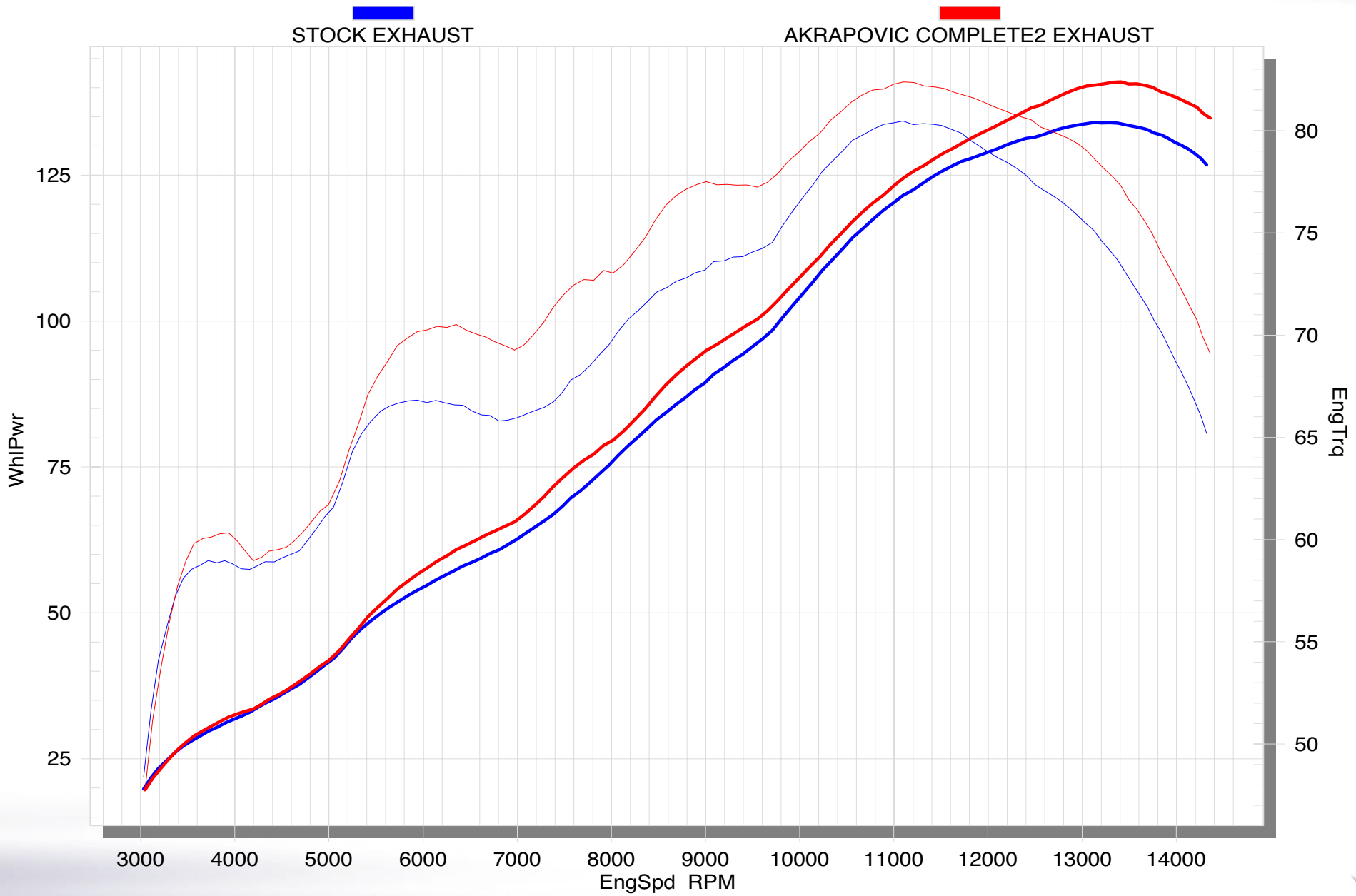

Road Program

Product code: 107910 (S-S7R7-TC), 107909 (S-S7R7-TT)  
107878 (S-S7RFT7-TC) 107877 (S-S7RFT7-TT)



Akrapovic Exhaust System Technology copyright 2007, all rights reserved