



AKRAPOVIC EVOLUTION EXHAUST SYSTEM
for the
BMW G450X (2008-2009)

Congratulations on purchasing an Akrapovic exhaust system. Please read these installation instructions carefully. If you have any trouble installing the system please contact your authorized dealer!

IMPORTANT INFORMATION

Exclusion of Certain Liability

1. The manufacturer, importer or dealer shall not be liable for any incidental damage including personal injury or any other damages caused by improper installation or operation of the Akrapovic exhaust system. When installing the Akrapovic exhaust system be careful that the exhaust system does not touch other parts sensitive to high temperature.
2. Akrapovic makes no representation or warranties with regard to damage caused by the improper installation, use and maintenance of the Akrapovic exhaust system. The warranty is limited to defects recognized by our technical department and to normal use, and excludes items subject to normal wear (gaskets and damping wool). The guarantee is void in case of accident, modification, improper or competition use.
3. Do not attempt to install the Akrapovic exhaust system on a motorcycle for which it was not made or tested by Akrapovic.
4. When the exhaust system gets very hot during operation, be careful not to burn yourself on the exhaust system or parts which are in direct contact with it, even when the motor is not running. Also protect other people, especially children, from the injuries mentioned above.
5. In some cases Akrapovic exhaust system kits contain chemical products (ceramic anti-seizing grease; bolt sealant). Handle with care, do not inhale or swallow. Avoid excessive contact with skin, eyes or mucous membranes. Keep out of reach of children.
6. Technical specifications of Akrapovic exhaust systems and related products subject to change without notice.

Trademarks

The Akrapovic Exhaust System Technology logo is a registered trademark of Akrapovic d.d.

Akrapovic website

Information about Akrapovic exhaust systems and related products is available on the Akrapovic website at:

<http://www.akrapovic.com/>

Copyright

No part of the Akrapovic exhaust system or its documentation may be reproduced or distributed in any form or by any means without the prior written authorization of the Akrapovic company.

© Akrapovic, d.d. All rights reserved.

Symbols

The following symbols are used throughout these installation instructions:



 **USE BOLT SEALANT;** Apply 3 to 4 small drops of bolt sealant onto the cleaned and degreased threads before tightening bolts. **WARNING! Avoid contact with skin, eyes and mucous membranes. Do not inhale fumes. Keep out of the reach of children.**

 **USE ANTI-SEIZING GREASE (white tube);** Prevents seizing, corrosion and excessive wear between the titanium components of your exhaust system. **WARNING! Avoid eye contact. Avoid excessive skin contact. Keep out of the reach of children.**

 **USE ANTI-SEIZE LEAD-FREE COPPER PASTE (black tube);** Provides trouble-free and long-lasting protection against seizing, corrosion and rusting of bolts, threaded ends, nuts, joints, etc. Also protects against vibration, wear and impact. **WARNING! Avoid eye contact. Avoid excessive skin contact. Keep out of the reach of children.**

INSTALLATION INSTRUCTIONS

 **BEFORE INSTALLING CHECK SCHEMATIC OF THE EXHAUST SYSTEM!**

! IF ANY ITEMS IN THE AKRAPOVIC EXHAUST SYSTEM PACKAGE ARE MISSING PLEASE CONTACT YOUR AUTHORIZED DEALER. KEEP THE SCHEMATIC FOR FUTURE REFERENCE.

! THESE INSTALLATION INSTRUCTIONS MUST BE READ CAREFULLY IN ORDER TO ENSURE PROPER INSTALLATION AND OPERATION OF THE AKRAPOVIC EXHAUST SYSTEM.

! THE EXHAUST SYSTEM CAN BE EXTREMELY HOT. ALLOW THE MOTORCYCLE TO COOL DOWN BEFORE BEGINNING INSTALLATION.

 **WE ADVISE YOU TO LEAVE INSTALLATION TO A QUALIFIED SERVICEMAN. IMPROPER INSTALLATION MAY RESULT IN A SHORTER LIFETIME OF THE EXHAUST SYSTEM AND/OR DAMAGE TO THE MOTORCYCLE.**



T-handle 8mm wrench
T-handle 10mm wrench
T-handle 13mm wrench
T-handle 12mm swiveling wrench
T-handle 4mm three hexagon key wrench
T-handle 5mm three hexagon key wrench
Combination 17mm wrench
Spring puller

REMOVAL OF STOCK EXHAUST SYSTEM:

1. Put the motorcycle on a side stand, we recommend a racing stand. Make sure, that surface is solid and flat.
2. For easier access to the muffler remove the rear right panel (**Figure 1, 2, 3, 4**).



Figure 1



Figure 2



Figure 3



Figure 4

3. Untighten the bolt from the metal clamp at the link pipe – header tube joint (**Figure 5**). Unscrew and remove the bolt from the metal bracket for the link pipe (**Figure 6**).



Figure 5



Figure 6

4. Unscrew and remove the bolt from the muffler metal bracket and remove the muffler, stock graphite gasket and metal clamp (**Figure 7, 8, 9, 10**).



Figure 7



Figure 8



Figure 9



Figure 10

5. Unscrew and remove the lambda sensor (Figure 11, 12).



Figure 11



Figure 12

6. Unscrew and remove the nuts of the header tube flange and remove the stock header tube (Figure 13, 14).



Figure 13



Figure 14

INSTALLATION OF THE AKRAPOVIC EVOLUTION EXHAUST SYSTEM:

1. Set up the inner sleeve together with the flange and springs; make sure they are correctly oriented; use stock gasket; hand tighten the flange; (Figure 15, 16).



Figure 15



Figure 16

2. Install the header tube and attach the springs. **WARNING!** make sure, that springs pull the header all the way into the sleeve – use rubber mallet if necessary to tap the connections into place! (Figure 17, 18).



Figure 17



Figure 18

3. Tighten the lambda sensor (Figure 19, 20). **WARNING!** grease only the threads of the lambda sensor!



Figure 19

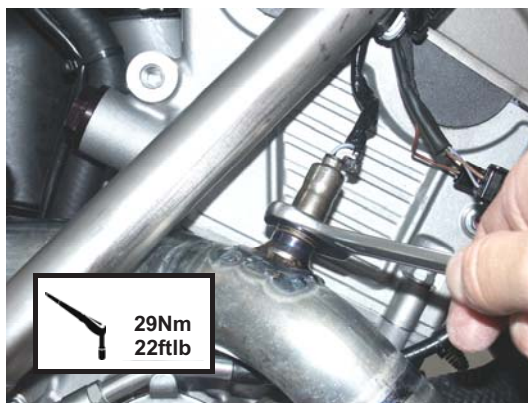

Figure 20

4. Install the press-on nut onto the link pipe bracket (Figure 21, 22).

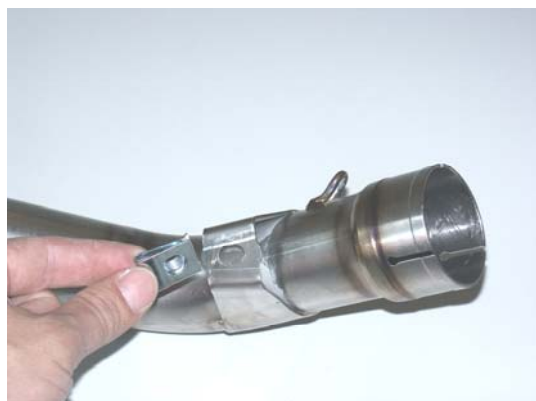

Figure 21



Figure 22

5. Coat the bolt and interior of the metal clamp with Akrapovic anti-seize lead-free copper paste (black tube) and correctly install the metal clamp onto the link pipe (**Figure 23**). Install graphite sleeve gasket into the link pipe with welded muffler (**Figure 24**).



Figure 23



Figure 24

6. Correctly position the carbon-fiber clamp and slide it onto the muffler - bear in mind the left offset of the carbon-fiber clamp viewed from the rear. **WARNING!** open the clamp to slightly wider than the diameter of the outer sleeve of the muffler – do not scrape it along the muffler outer sleeve! (**Figure 25**).



Figure 25

7. Correctly position the muffler with the link pipe and slide them onto the header tube (**Figure 26**). Hand tighten the bolt from the link pipe bracket and attach the spring. **WARNING!** make sure, that springs pull the collectors all the way onto the headers – use rubber mallet if necessary to tap the connections into place! (**Figure 27, 28**).



Figure 26



Figure 27



Figure 28

8. Attach the carbon-fiber clamp to the stock chassis hanging bracket – use the washer and spacers supplied in the Akrapovic kit. Do not fully tighten. Make sure the additional parts from the Akrapovic kit are correctly installed. (Figure 29, 30, 31, 32).



Figure 29



Figure 30



Figure 31



Figure 32

9. Tighten fully the bolts of the link pipe bracket, metal clamp, muffler clamp and header tube flange (Figure 33, 34, 35, 36, 37). Make sure the link pipe and muffler are not touching other parts of the motorcycle.

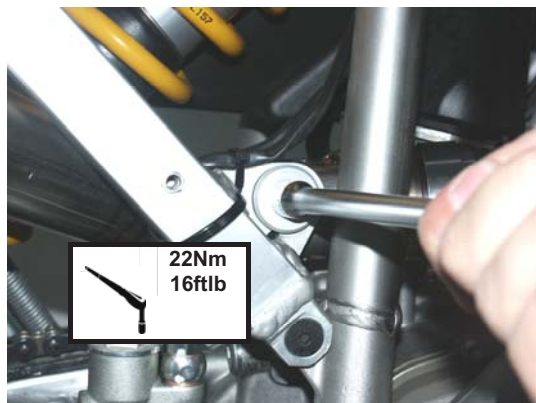

Figure 33

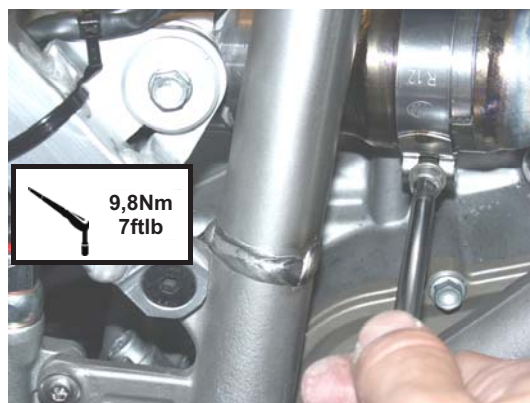

Figure 34



Figure 35

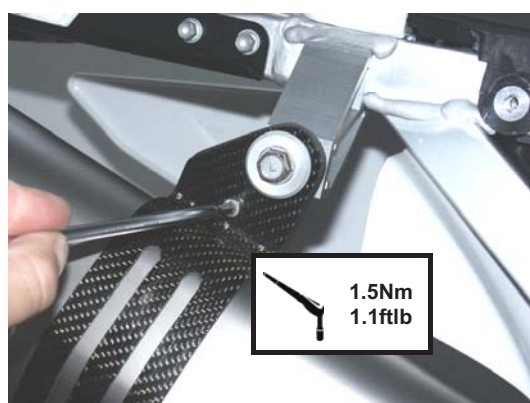

Figure 36

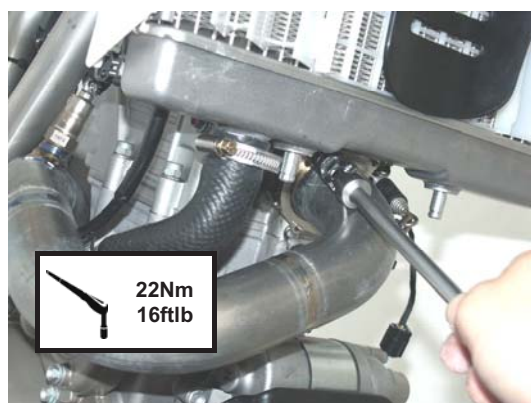

Figure 37

10. Reattach the rear right panel (Figure 38, 39). **WARNING!** remove the direction indicators (otherwise the right rear indicator could be damaged by hot exhaust gases).



Figure 38

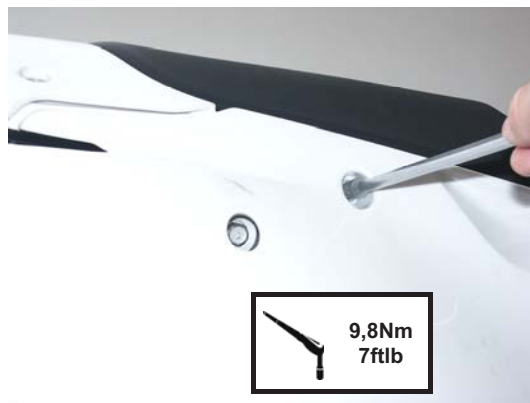

Figure 39

Final installation:

1. Clean grease spots:
 - a. Muffler – titanium outer sleeve: use a soft cloth sprayed with a multi-purpose spray lubricant (WD-40 or equivalent).
 - b. Muffler – carbon-fiber outlet cap: use a soft dry cloth.
 - c. Titanium inlet cap and welded link pipe: use a soft cloth sprayed with a multi-purpose spray lubricant (WD-40 or equivalent).

Cleaning will prevent spots from burning onto the surface. Do not use aggressive chemical cleaners, because they can damage the sticker.

Position of the correctly installed Akrapovic **EVOLUTION** system (Figure 40).



Figure 40

2. Check the operation of the brakes and suspension. Make sure all the bolts are sufficiently tightened. In case the exhaust system touches the cowling or other parts repeat the adjustment of the exhaust system or contact your authorized dealer.

! IT IS NORMAL IF WHITE SMOKE COMES OUT OF THE MUFFLER ON FIRST OPERATION.

! DO NOT STAND BEHIND THE MUFFLER ON FIRST OPERATION.

! DO NOT USE AUTOMOTIVE WHEEL CLEANERS OR ANY CLEANING PRODUCTS WHICH CONTAIN ACIDIC ADDITIVES TO CLEAN AKRAPOVIC EXHAUST SYSTEMS.

MAINTENANCE OF THE AKRAPOVIC EXHAUST SYSTEM

1. Clean the titanium exhaust components with a multi-purpose spray lubricant (WD-40 or equivalent), carbon fiber exhaust components with soft and dry cloth and stainless steel components with soft cloth sprayed with contact cleaner, then wipe with soft and dry cloth. Do not use aggressive chemical cleaners, because they can damage the sticker. A change in the color of the exhaust system is normal due to the high temperatures.
2. The wearing out of the muffler silencing material depends on the type of the engine and riding style. Contact your dealer/serviceman if visible changes appear on muffler's outer sleeve or the noise level is increased.
3. Periodically make sure all the bolts and springs are sufficiently tight.

BMW G450X ENDURO/ Complete exhaust system/ EVOLUTION LINE, Model year: 2008 - 2009

Product code: S-B4MET1-ZTA

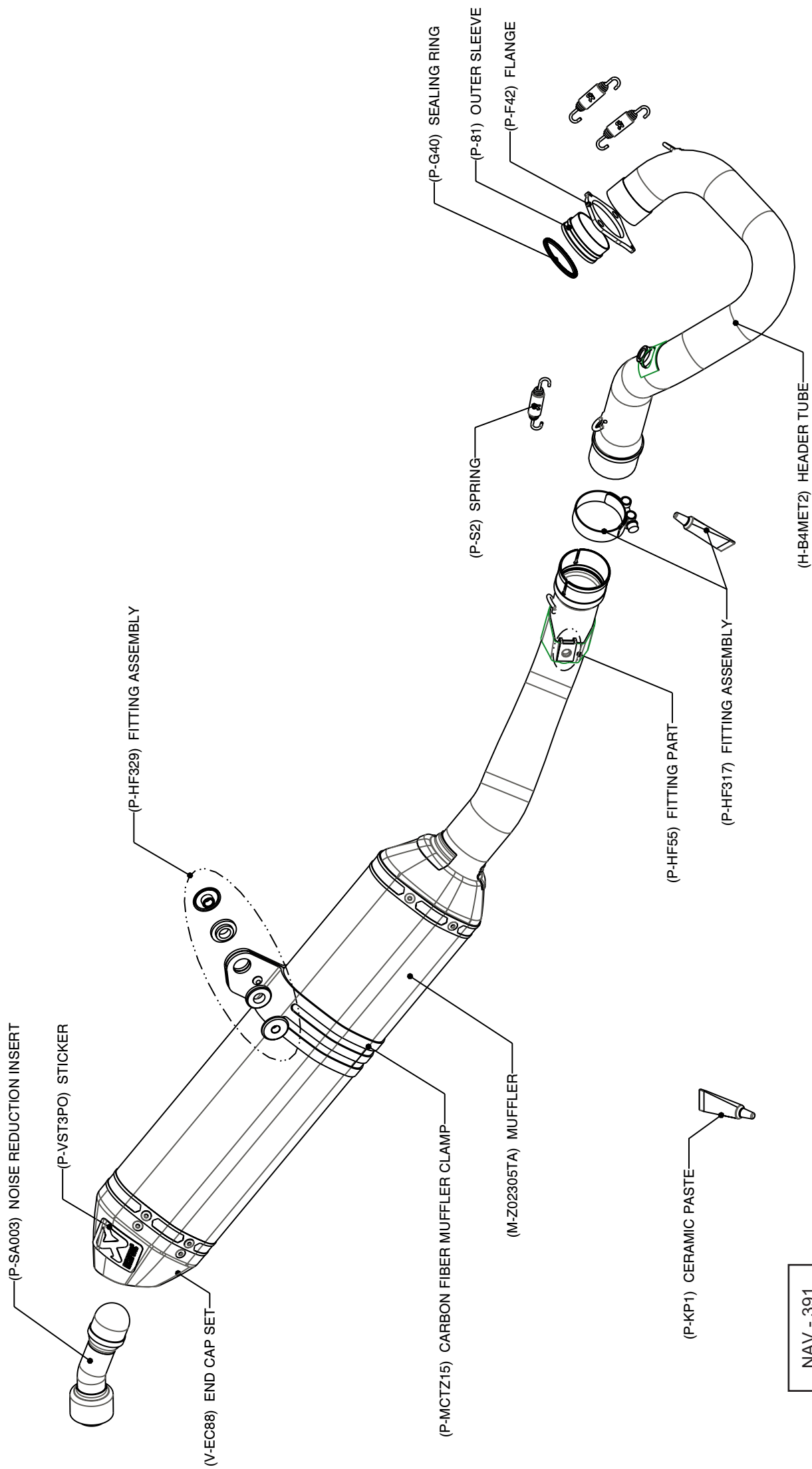

BMW G450X ENDURO/ Complete exhaust system/ EVO KIT/ EU spec., Model year: 2008 - 2009

Product code: S-B4MET1-ZT/EU

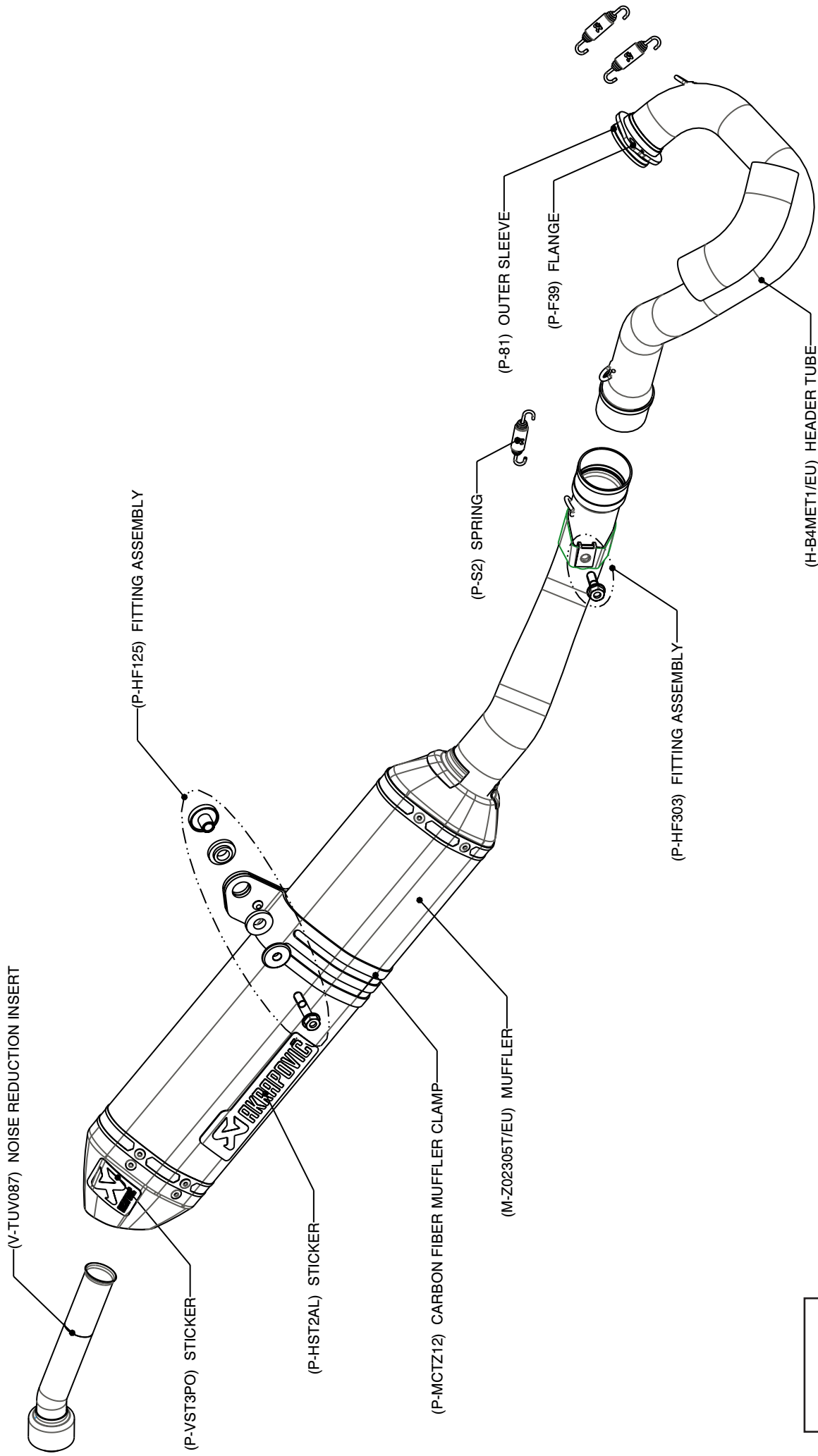

BMW G450X ENDURO/ Complete exhaust system/ EVO KIT/ USA spec., Model year: 2008 - 2009

Product code: S-B4MET1-ZT/USA

