



KAWASAKI ZX-10R (2008 - 2010)

SLIP-ON STREET LEGAL EXHAUST SYSTEM

Our sporty and lightweight SLIP-ON system offer a great balance between price and performance and represent the first step in the exhaust system tuning process. The change will also be visual as our HEXAGONAL muffler perfectly fit the exterior line of the ZX-10R and add a clean racing image.

The muffler outer sleeve is made of titanium or carbon-fiber, which gives a special hi-tech touch and reduces weight. The street legal version includes integrated exhaust valve.

PERFORMANCE

Measurements of the Akrapovic SLIP-ON street legal system on the KAWASAKI ZX-10R (without muffler insert):

Power & Torque: the exhaust system modification with the SLIP-ON street legal system results in a major boost in performance, delivering a massive 172.7 HP at 12450 rpm on the back wheel. But the increased power isn't available just at the top of the range; the system shows its quality from 5000 rpm already up through the entire rpm range. Max. increased power between the Akrapovic and the stock system is 4.6 HP at 7950 rpm. Besides this, the torque is substantially higher in a lower rpm area at 3500 rpm and from middle to high rpm area.



PERFORMANCE			
	stock	AKRAPOVIC	max. increased power
max. rear wheel power HP / rpm <small>(measured on SuperFlow Cyle Dyn)</small>	169.3 / 12350	172.7 / 12450	4.6 / 7950

ADDITIONAL DATA					
weight comparison (kg)	stock	AKRAPOVIC		difference	
	3.72	SS link pipe	TITANIUM link pipe	stock - S.S.	stock - TITANIUM
		-	1.85	-	1.87

noise measurements (dB / rpm)	stock	AKRAPOVIC
		95 / 6250
legal for street use	YES	

Technical specifications of Akrapovic exhaust systems and related products subject to change without notice.

Product code: S-K10SO4-HZC, S-K10SO4-HZT
L-K10SO4/1 optional link pipe - Warning! Using with this combination is not street legal!

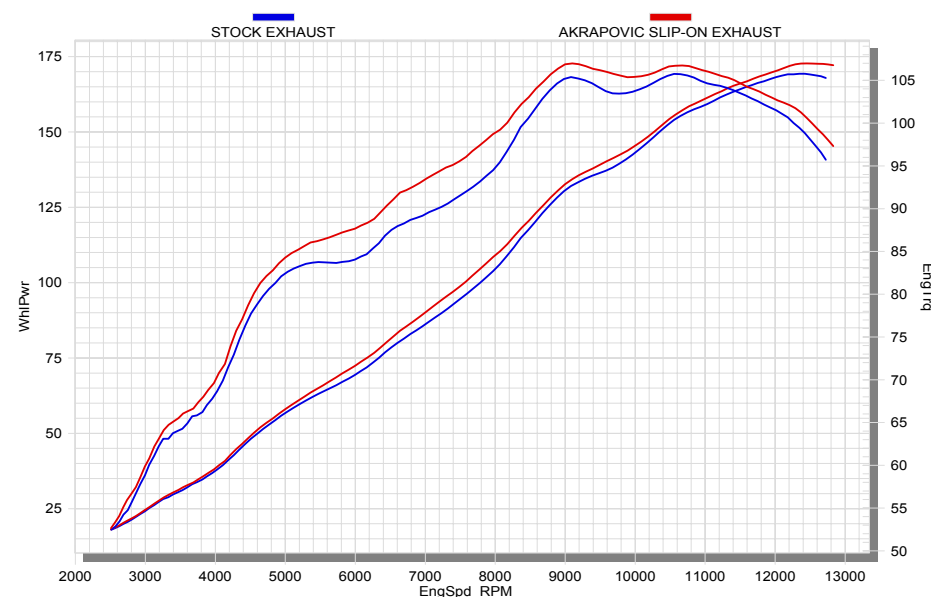

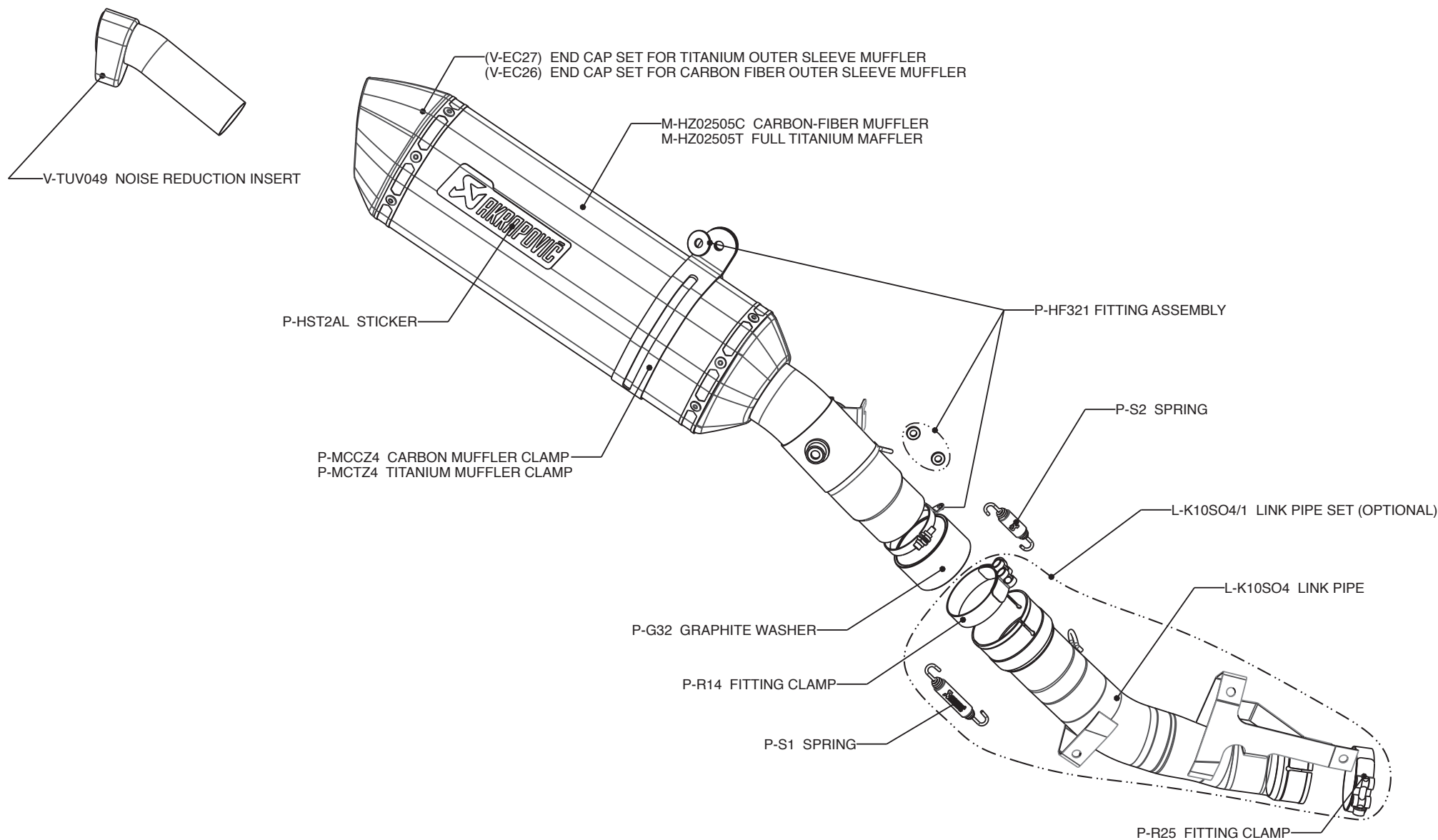

Product code: S-K10SO4-HZC, S-K10SO4-HZT
L-K10SO4/1 optional link pipe - Warning! Using with this combination is not street legal!