



Slip-On Line (Titanium)

The Akrapovič Slip-On exhaust system is designed for riders who do not want to make expensive and major modifications to their stock exhaust system. However, the Hexagonal muffler delivers great looks as well as increased performance for the bike.

| TECHNICAL DATA | UNIT | STOCK | AKRAPOVIČ | DIFFERENCE |
|--------------------|--------|------------------|------------------|-------------------|
| maximum power | kW | 70.5 at 9430 rpm | 73.2 at 9430 rpm | + 2.7 at 9430 rpm |
| | HP (m) | 95.8 at 9430 rpm | 99.5 at 9430 rpm | + 3.7 at 9430 rpm |
| | HP (i) | 94.5 at 9430 rpm | 98.1 at 9430 rpm | + 3.6 at 9430 rpm |
| maximum torque | Nm | 76 at 8590 rpm | 79 at 8630 rpm | + 4.2 at 6350 rpm |
| | lb-ft | 56.1 at 9430 rpm | 54 at 9430 rpm | + 2 at 9430 rpm |
| weight | kg | 5.8 | 2.2 | - 3.6 |
| | lb | 12.8 | 12.8 | - 7.9 |
| static noise level | dB | 88 | 88 | 0 |
| | rpm | 5000 | 5000 | 0 |

measured with: Honda Crossrunner 2011

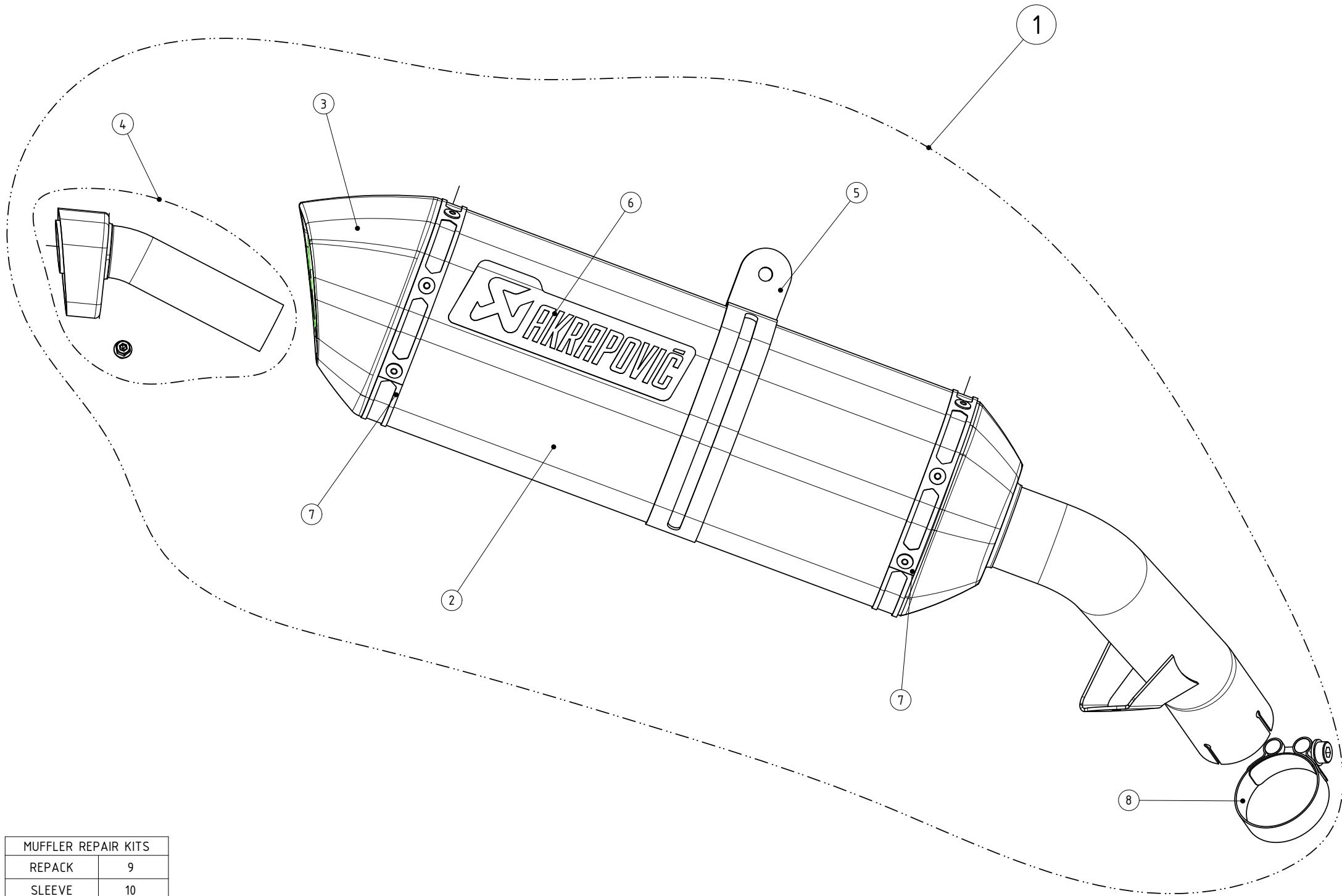

| MUFFLER REPAIR KITS | |
|---------------------|----|
| REPACK | 9 |
| SLEEVE | 10 |

| No. | SALES CODE | DESCRIPTION | QTY. |
|-----|--------------|--|------|
| 1 | S-H8SO2-HRT | S HO Crossrunner SO 012 MST R H | 1 |
| 2 | M-HR02902T | M HSO S50R1 T350/50 C69×49R5/32 HO Cross | 1 |
| 3 | V-EC31 | SRO zad. CA R5 TI za BMW K1200S,R E,R 05 | 1 |
| 4 | V-TUV084 | vložek ses. HOM SS D32/90/65×46/22° D | 1 |
| 5 | P-MCTR27 | MC CA R TI 25/8,5/98/32 TR27 | 1 |
| 6 | P-HST2AL | nalepka Akrap. HOR 150 AL | 1 |
| 7 | P-TT13 | trak zak. TI L=410 S=16 R TI TT13 | 2 |
| 8 | P-R12/1 | objemka SS D50×16 M8×35 | 1 |
| 9 | P-RPCK49 | MMRCK tip 49 | 1 |
| 10 | P-RKS125RT35 | MRRSK tip125T35 TI350R | 1 |