



Honda CBR 900 RR (2002, 2003)

Bolt-on Exhaust System

# Akrapovic Bolt-On Exhaust System

for the Honda CBR 900 RR (2002, 2003)

A great bike from any angle. Its ten years on the market are proof of the sound design of this light, intuitive motorcycle, whose main purpose is great handling. In other words, the CBR 900 is a bike that won't let you down; easy to ride, excellent handling characteristics, a fluid and powerful engine, controls right where you want them to be! It has recently undergone some changes, but these have only improved the bike, which remains virtually a synonym for a top-quality, top performance motorcycle.

## GOAL

Take all the best things from every brand of bike, put them all together and call it a CBR 900 RR. Is it really that simple? No. Years of development, knowledge and experience went into this model, since this is the only way to develop a top-quality product. And that's how we look at it as well. We too have used our knowledge and experience to reach a level recognized around the world. So why not combine the two? Our development department has developed a BOLT-ON system especially for the CBR 900 RR which will make a lot of Honda owners happy by offering a simple way to visually enhance their motorcycle.

## ABOUT AKRAPOVIC BOLT-ON SYSTEMS

The Akrapovic BOLT-ON system is a unique product intended exclusively for the particular motorcycle for which it was designed. This means that it has received the attention of the same development department which develops exhaust systems for racing motorcycles around the world. The BOLT-ON system is an excellent compromise between top-flight knowledge, technology, aesthetic perfection and affordability.

The design of the BOLT-ON system is based mainly on simple installation which can be performed by the customer, without having to remove or modify any of the motorcycle's exterior parts. Mounting is performed simply with the unbolting of the bolts on the stock muffler and replacing it with the Akrapovic BOLT-ON system. The BOLT-ON system is made of top-quality materials – the perforated inner sleeve and end cap are made of titanium, while the front rosette is CNC machined from special billet aluminum. The outer sleeve is available in either carbon-fiber or titanium, while the muffler clamp is available only in carbon-fiber. Your BOLT-ON kit will also include titanium bolts which replace the stock bolts, and a special temperature-resistant sealant which prevents the bolts from unseating.

Technical specifications of Akrapovic exhaust systems and related products subject to change without notice.

## Measured performance of the BOLT-ON system:

### • power:

the Akrapovic BOLT-ON system is not intended for extreme high-performance. The Akrapovic range includes other systems for that purpose. The main characteristic of the BOLT-ON system when looked at from the point of view of performance is the leveling of the minor oscillations in the power curve of the stock engine. Our system performs well in this area, as can be seen by comparing the curves, which show a clear leveling of the stock oscillations below 3000 rpm and from 4200 to 5000 rpm, making the bike more rider-friendly. Of course, the system's racing heritage can still be felt, with a 3.5 HP increase at the top of the rpm range and a maximum increased power of 5.2 HP.

### • torque:

as with the power curve, the torque curve for the Akrapovic BOLT-ON system shows its utility. Leveling between 4200 and 5000 rpm and increased torque throughout the range from there on is proof of the successful design of this system.

How about the look and sound? The BOLT-ON system will give you a special aesthetic effect in the carbon-fiber outer sleeve option, which complements the red/black color combination of the bike. Of course if you prefer, it is also available in titanium. There is no difference in performance, only in appearance. As far as sound, it will be immediately obvious that you have replaced your stock system, as the color and depth of Akrapovic exhaust systems are easy to recognize. You will not be disappointed with the Akrapovic BOLT-ON system for everyday use; our many satisfied customers will attest to that!

## NOTE:

The BOLT-ON system for 2002 and 2003 Honda CBR 900 RR, although similar in appearance to previous models, is not interchangeable with them!

	stock	AKRAPOVIC	difference
weight comparison	2.80 kg	1.80 kg	1 kg
max. rear wheel power	131.5 / 11200 RPM	135 HP / 11500 RPM	5.2 HP / 11800 RPM*
noise measurement	92 db / 5625 RPM	98.5db / 5625 RPM	6.5 db / 5625 RPM
periodic service possibilities without taking off A.E.S.		oil YES	oil filter YES
legal for street use		NO	

\*MAXIMUM MEASURED POWER DIFFERENCE

# Akrapovic Bolt-On Exhaust System

for the Honda CBR 900 RR (2002, 2003)

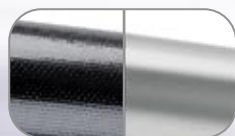

The outer sleeve is available in carbon-fiber or titanium

CARBON-FIBER  
MUFFLER CLAMP

Road  
Program

Product code: S-H9BO2-T, S-H9BO2-C



# Akrapovic Bolt-On Exhaust System for the Honda CBR 900 RR (2002, 2003)

Akrapovic Exhaust System Technology copyright 2003, all rights reserved



Road  
Program

# Akrapovic Bolt-On Exhaust System for the Honda CBR 900 RR (2002, 2003)



Akrapovic Exhaust System Technology copyright 2003, all rights reserved

Road Program

# Akrapovic Bolt-On Exhaust System

for the Honda CBR 900 RR (2002, 2003)

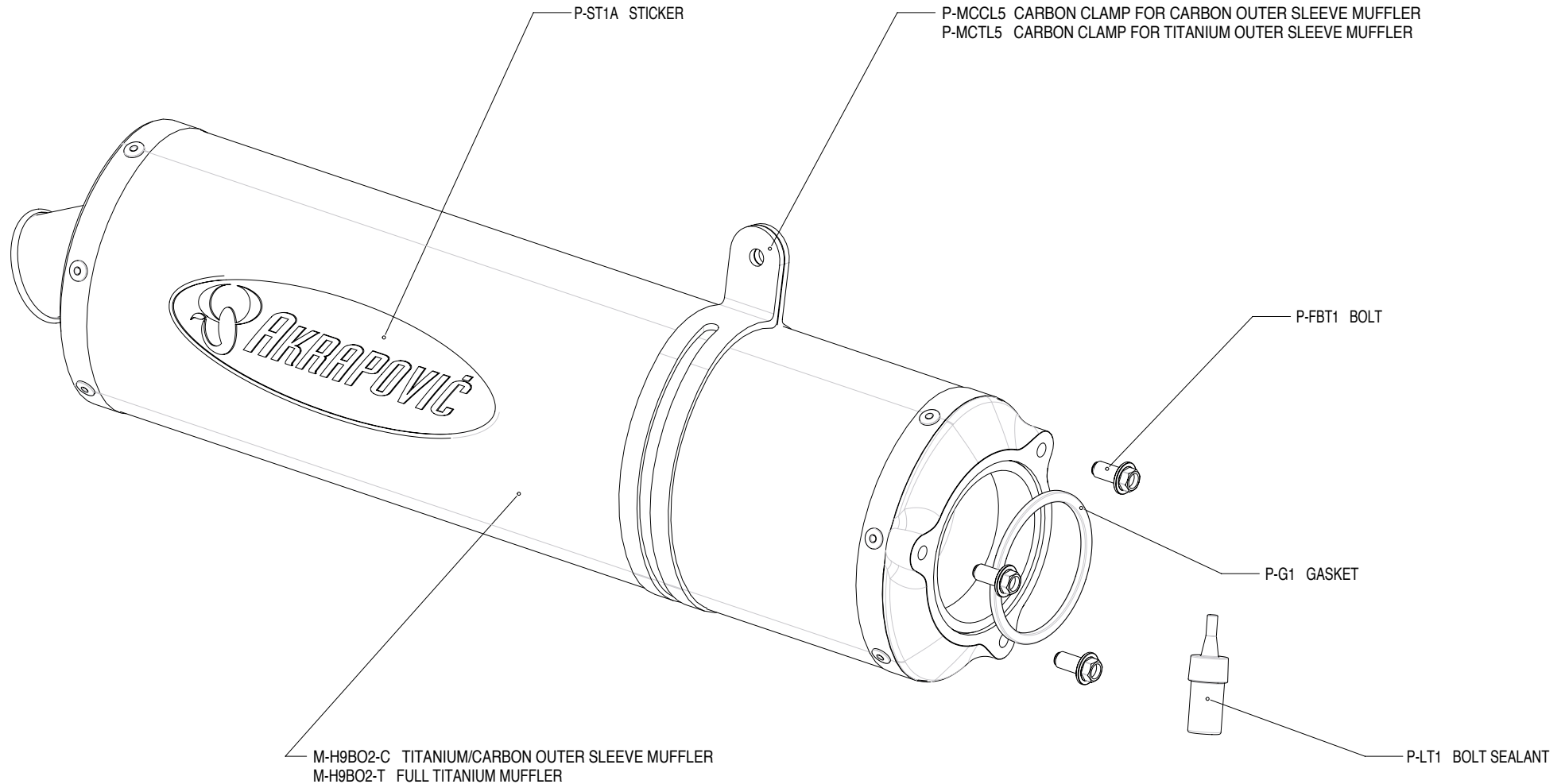

Akrapovic Exhaust System Technology copyright 2003, all rights reserved

Road Program



# Akrapovic Bolt-On Exhaust System

for the Honda CBR 900 RR (2002, 2003)

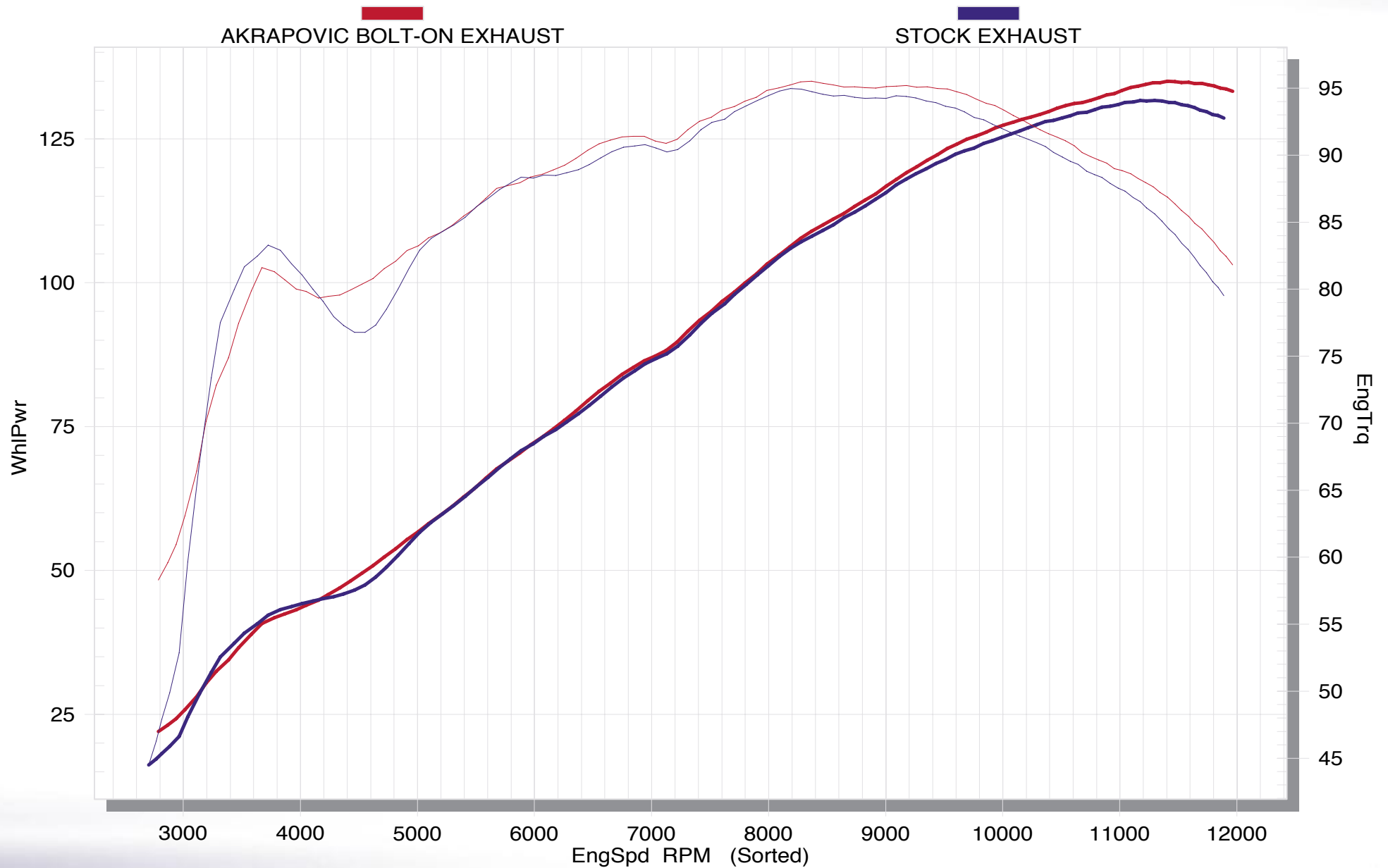

Akrapovic Exhaust System Technology copyright 2003, all rights reserved

Road Program

