



AKRAPOVIC RACING2 & EVOLUTION2 EXHAUST SYSTEM
for the
SUZUKI GSXR600/750 (2006-2007)

Congratulations on purchasing an Akrapovic exhaust system. Please read these installation instructions carefully. If you have any trouble installing the system please contact your authorized dealer!

IMPORTANT INFORMATION

Exclusion of Certain Liability

1. The manufacturer, importer or dealer shall not be liable for any incidental damage including personal injury or any other damages caused by improper installation or operation of the Akrapovic exhaust system. When installing the Akrapovic exhaust system be careful that the exhaust system does not touch other parts sensitive to high temperature.
2. Akrapovic makes no representation or warranties with regard to damage caused by the improper installation, use and maintenance of the Akrapovic exhaust system. The warranty is limited to defects recognized by our technical department and to normal use, and excludes items subject to normal wear (gaskets and damping wool). The guarantee is void in case of accident, modification, improper or competition use.
3. Do not attempt to install the Akrapovic exhaust system on a motorcycle for which it was not made or tested by Akrapovic.
4. When the exhaust system gets very hot during operation, be careful not to burn yourself on the exhaust system or parts which are in direct contact with it, even when the motor is not running. Also protect other people, especially children, from the injuries mentioned above.
5. In some cases Akrapovic exhaust system kits contain chemical products (ceramic anti-seizing grease; bolt sealant). Handle with care, do not inhale or swallow. Avoid excessive contact with skin, eyes or mucous membranes. Keep out of reach of children.
6. Technical specifications of Akrapovic exhaust systems and related products subject to change without notice.

Trademarks

The Akrapovic Exhaust System Technology logo is a registered trademark of Akrapovic d.å.

Akrpovic website

Information about Akrapovic exhaust systems and related products is available on the Akrapovic website at:
<http://www.akrapovic-exhaust.com/>

Copyright

No part of the Akrapovic exhaust system or its documentation may be reproduced or distributed in any form or by any means without the prior written authorization of the Akrapovic company.

© Akrapovic d.å. All rights reserved.

Symbols

The following symbols are used throughout these installation instructions:



 **USE BOLT SEALANT;** Apply 1 to 2 small drops of bolt sealant onto the cleaned and degreased threads before tightening bolts. **WARNING! Avoid contact with skin, eyes and mucous membranes. Do not inhale fumes. Keep out of the reach of children.**

 **USE ANTI-SEIZING GREASE (white tube);** Prevents seizing, corrosion and excessive wear between the titanium components of your exhaust system. **WARNING! Avoid eye contact. Avoid excessive skin contact. Keep out of the reach of children.**

 **USE ANTI-SEIZE LEAD-FREE COPPER PASTE (black tube);** Provides trouble-free and long-lasting protection against seizing, corrosion and rusting of bolts, threaded ends, nuts, joints, etc. Also protects against vibration, wear and impact. **WARNING! Avoid eye contact. Avoid excessive skin contact. Keep out of the reach of children.**

INSTALLATION INSTRUCTIONS

 **BEFORE INSTALLING CHECK SCHEMATIC OF THE EXHAUST SYSTEM!**

! IF ANY ITEMS IN THE AKRAPOVIC EXHAUST SYSTEM PACKAGE ARE MISSING PLEASE CONTACT YOUR AUTHORIZED DEALER. KEEP THE SCHEMATIC FOR FUTURE REFERENCE.

! THESE INSTALLATION INSTRUCTIONS MUST BE READ CAREFULLY IN ORDER TO ENSURE PROPER INSTALLATION AND OPERATION OF THE AKRAPOVIC EXHAUST SYSTEM.

! THE EXHAUST SYSTEM CAN BE EXTREMELY HOT. ALLOW THE MOTORCYCLE TO COOL DOWN BEFORE BEGINNING INSTALLATION.

 **WE ADVISE YOU TO LEAVE INSTALLATION TO A QUALIFIED SERVICEMAN. IMPROPER INSTALLATION MAY RESULT IN A SHORTER LIFETIME OF THE EXHAUST SYSTEM AND/OR DAMAGE TO THE MOTORCYCLE.**



T-handle 12mm wrench
T-handle 10mm wrench
Combination 22mm wrench
Combination 10mm wrench
T-handle 6mm swiveling three hexagon key wrench
T-handle 4mm three hexagon key wrench
T-handle 6mm three hexagon key wrench
Screwdriver for slotted head screw – small
Spring hook

REMOVAL OF STOCK EXHAUST SYSTEM:

1. Put the motorcycle on a side stand, we recommend a racing stand. Make sure, that surface is solid and flat.
2. Remove the lower and the middle parts of the cowling (**Figure 1, 2, 3, 4**).



Figure 1



Figure 2



Figure 3



Figure 4

3. Untighten the bolt from the metal clamp at the muffler – collector joint, unscrew the bolts from the muffler brackets and remove the muffler (**Figure 5, 6, 7**). Remove the metal inner sleeve of the rubber damper from the muffler left hanging bracket.



Figure 5



Figure 6



Figure 7

4. Remove both seats (**Figure 8, 9**). Remove right side panel (**Figure 10**). Disconnect the turn signal connector (**Figure 11**).



Figure 8



Figure 9



Figure 10



Figure 11

5. Loosen and completely remove the cables from the exhaust valve (**Figure 12, 13**). Completely remove the exhaust valve cables from the servo motor (from the control wheel for cable position) and from the motorcycle (**Figure 14**).



Figure 12



Figure 13



Figure 14

- Uncrew and remove the control wheel for cable position (use pliers to fix the wheel) (**Figure 15**). Correctly position and install the Akrapovic servo motor rotation limiter (**Figure 16**) ; **WARNING: do not overtighten the bolt – you can damage the axle and rotation ability of the servo motor – use pliers to fix the axle**. Reconnect the turn signal connector (**Figure 17**). Replace the side panel and seats in the reverse order from the order in which they were removed (**Figure 18**).



Figure 15



Figure 16



Figure 17



Figure 18

- Unscrew the lambda sensor (**Figure 19**). Unscrew the bolt from the water cooler hanging bracket ; make sure not to damage the cooling fins (**Figure 20**). Unscrew the bolts from the header tube flanges and remove the stock header tubes; make sure not to damage the cooling fins (**Figure 21, 22**).



Figure 19



Figure 20

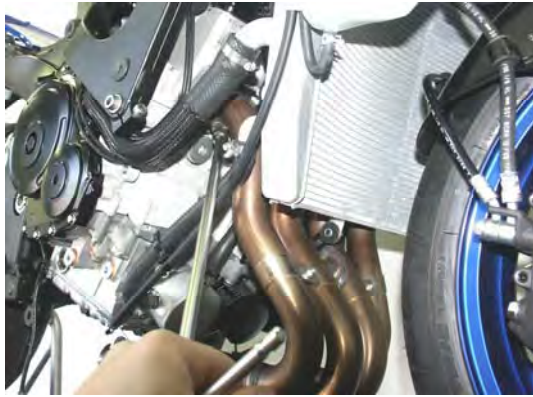

Figure 21



Figure 22

INSTALLATION OF THE AKRAPOVIC RACING2 OR EVOLUTION2 EXHAUST SYSTEM:

1. Set up the sleeves together with the flanges and springs; make sure they are correctly oriented (Figure 23, 24). Tighten the flanges (to specified torque) ; make sure not to damage the cooling fins.



Figure 23

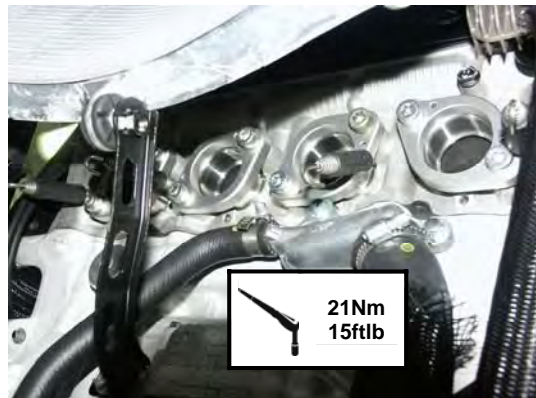

Figure 24

21Nm
15ftlb

2. Insert the header tubes properly and attach the springs; make sure not to damage the cooling fins (Figure 25, 26). Make sure the header tubes are not touching the engine, other tubes, electrical installations etc.



Figure 25



Figure 26

3. Make sure the collectors are correctly oriented. Slide the collectors onto the header tubes and attach the springs (**Figure 27, 28**). **For Evolution exhaust only:** coat the interior side of the input bushes of the titanium collector with Akrapovic ceramic anti-seizing grease (white tube). Reattach the bolt from the water cooler hanging bracket (**Tightening torque: 9.8Nm / 7ftlb**).



Figure 27



Figure 28

4. Unscrew the bolts from the driver's right footpeg bracket (slightly remove the bracket) (**Figure 29**). Install the Akrapovic muffler bracket (**Figure 30**). Tighten the footpeg bracket on its position (**Figure 31**).



Figure 29

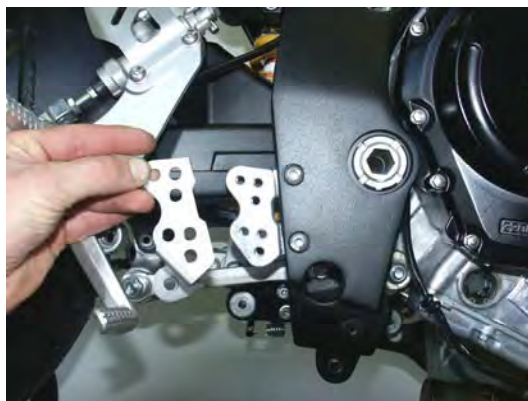

Figure 30

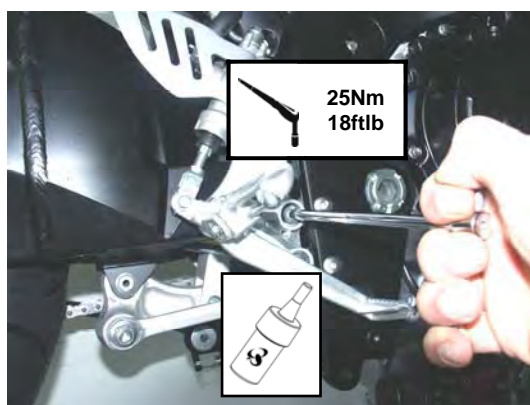

Figure 31

5. Attach the press-on nut onto the link pipe bracket (**Figure 32, 33**).



Figure 32



Figure 33

6. Slide the muffler with link pipe onto the collectors and attach the springs (**Figure 34, 35**). **For Evolution exhaust only:** coat the interior side of the input bushes of the titanium link-pipe with Akrapovic ceramic anti-seizing grease (white tube). Hand tighten the bolt of the link-pipe bracket (**Figure 36**). Attach and tighten the lambda sensor (**Figure 37**). Correctly position the carbon-fiber clamp and slide it onto the muffler - bear in mind **the left offset** of the carbon-fiber clamp viewed from the rear. **WARNING:** open the clamp slightly wider than the diameter of the outer sleeve of the muffler – **do not scrape it along the muffler outer sleeve!** (**Figure 38**). Tighten the carbon-fiber clamp onto the Akrapovic clamp bracket (**Figure 39**). Tighten the link-pipe bracket (**Figure 40**).



Figure 34



Figure 35



Figure 36

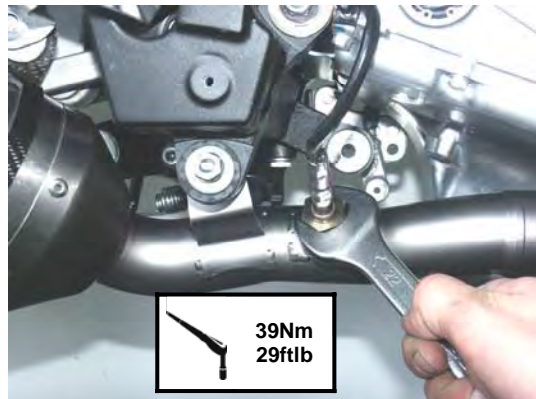

Figure 37



Figure 38



Figure 39

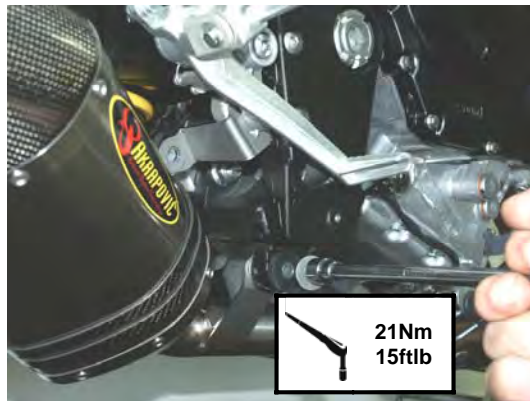

Figure 40

7. Replace all cowlings in the reverse order from the order in which they were removed (Figure 41, 42).



Figure 41

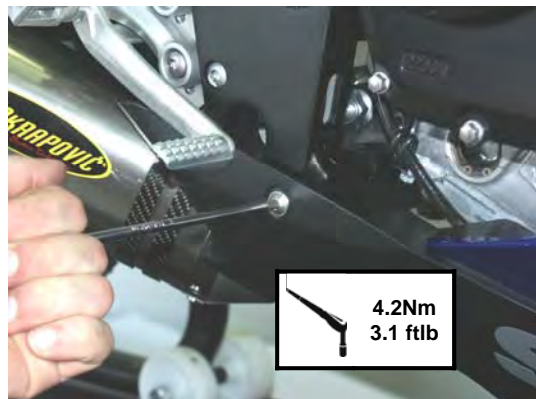

Figure 42

final installation:

1. Clean grease spots:
 - a. Muffler – titanium outer sleeve: use a soft cloth sprayed with a multi-purpose spray lubricant (WD-40 or equivalent).
 - b. RACING - stainless steel link pipe, collectors and header tubes: use a soft cloth sprayed with a contact cleaner, then wipe with a soft dry cloth
 - c. EVOLUTION - titanium link pipe, collectors and header tubes : use a soft cloth sprayed with a multi-purpose spray lubricant (WD-40 or equivalent).

Cleaning will prevent spots from burning onto the surface. Do not use aggressive chemical cleaners, because they can damage the sticker.

Position of the correctly installed Akrapovic **RACING2** or **EVOLUTION2** system (Figure 43).



Figure 43

2. Check the operation of the brakes and suspension. Make sure all the bolts are sufficiently tightened. In case the exhaust system touches the cowling or other parts repeat the adjustment of the exhaust system or contact your authorized dealer.

! IT IS NORMAL IF WHITE SMOKE COMES OUT OF THE MUFFLER ON FIRST OPERATION.

! DO NOT STAND BEHIND THE MUFFLER ON FIRST OPERATION.

! DO NOT USE AUTOMOTIVE WHEEL CLEANERS OR ANY CLEANING PRODUCTS WHICH CONTAIN ACIDIC ADDITIVES TO CLEAN AKRAPOVIC EXHAUST SYSTEMS.

MAINTENANCE OF THE AKRAPOVIC EXHAUST SYSTEM

1. Clean the titanium exhaust components with a multi-purpose spray lubricant (WD-40 or equivalent), carbon fiber exhaust components with soft and dry cloth and stainless steel components with soft cloth sprayed with contact cleaner, then wipe with soft and dry cloth. Do not use aggressive chemical cleaners, because they can damage the sticker. A change in the color of the exhaust system is normal due to the high temperatures.
2. The wearing out of the muffler silencing material depends on the type of the engine and riding style. Contact your dealer/serviceman if visible changes appear on muffler's outer sleeve or the noise level is increased.
3. Periodically make sure all the bolts and springs are sufficiently tight.

SUZUKI GSX-R 600 Complete exhaust system/ Racing line, model year: 2006, 2007

NAV - 308

Product code: 107729 (S-S6R7-TC)
107837 (S-S6R7-TT)

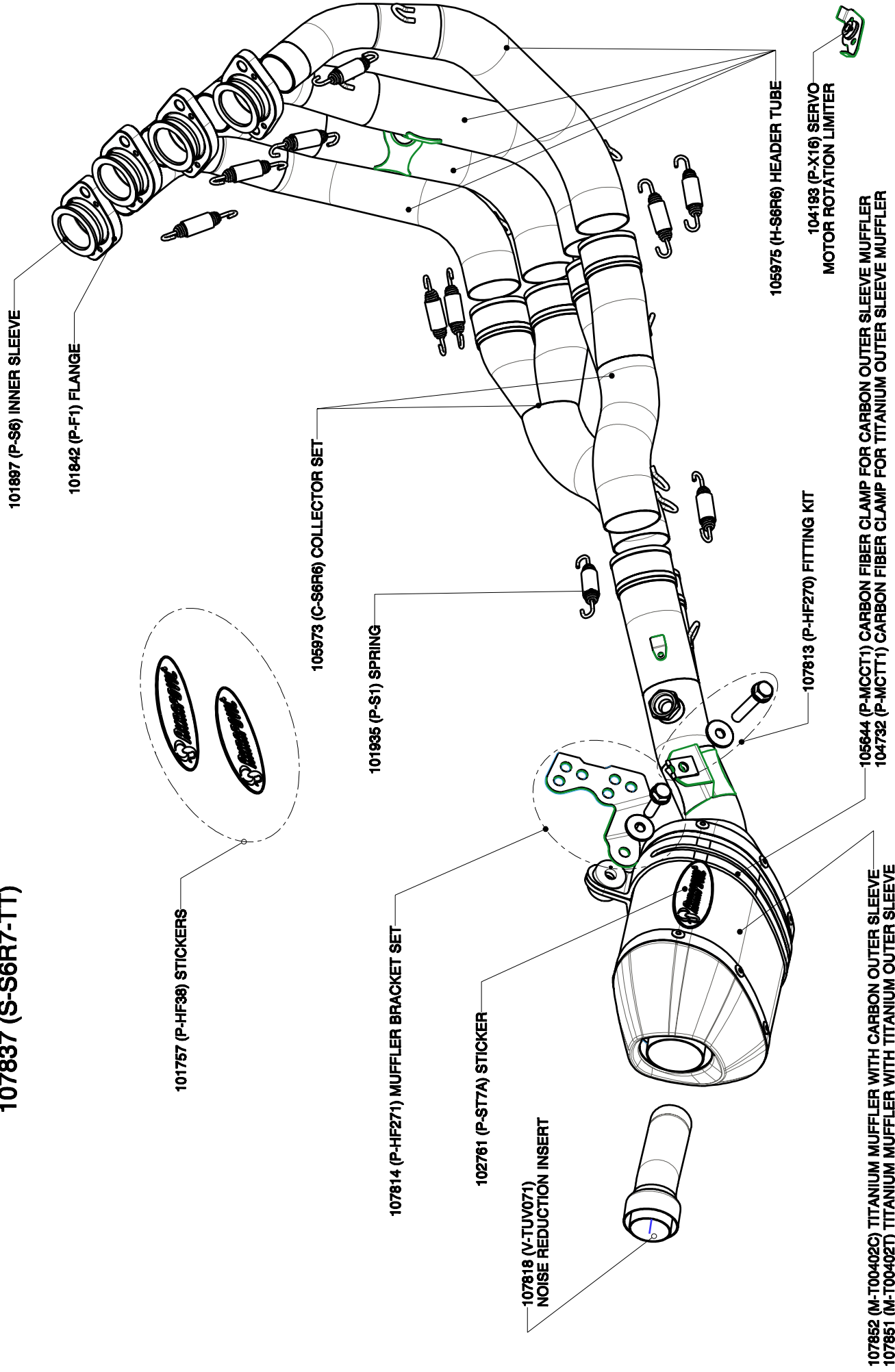

SUZUKI GSX-R 600 Complete exhaust system/Evolution line, model year: 2006, 2007

NAV - 308

**Product code: 107728 (S-S6RFT7-TC)
107766 (S-S6RFT7-TT)**

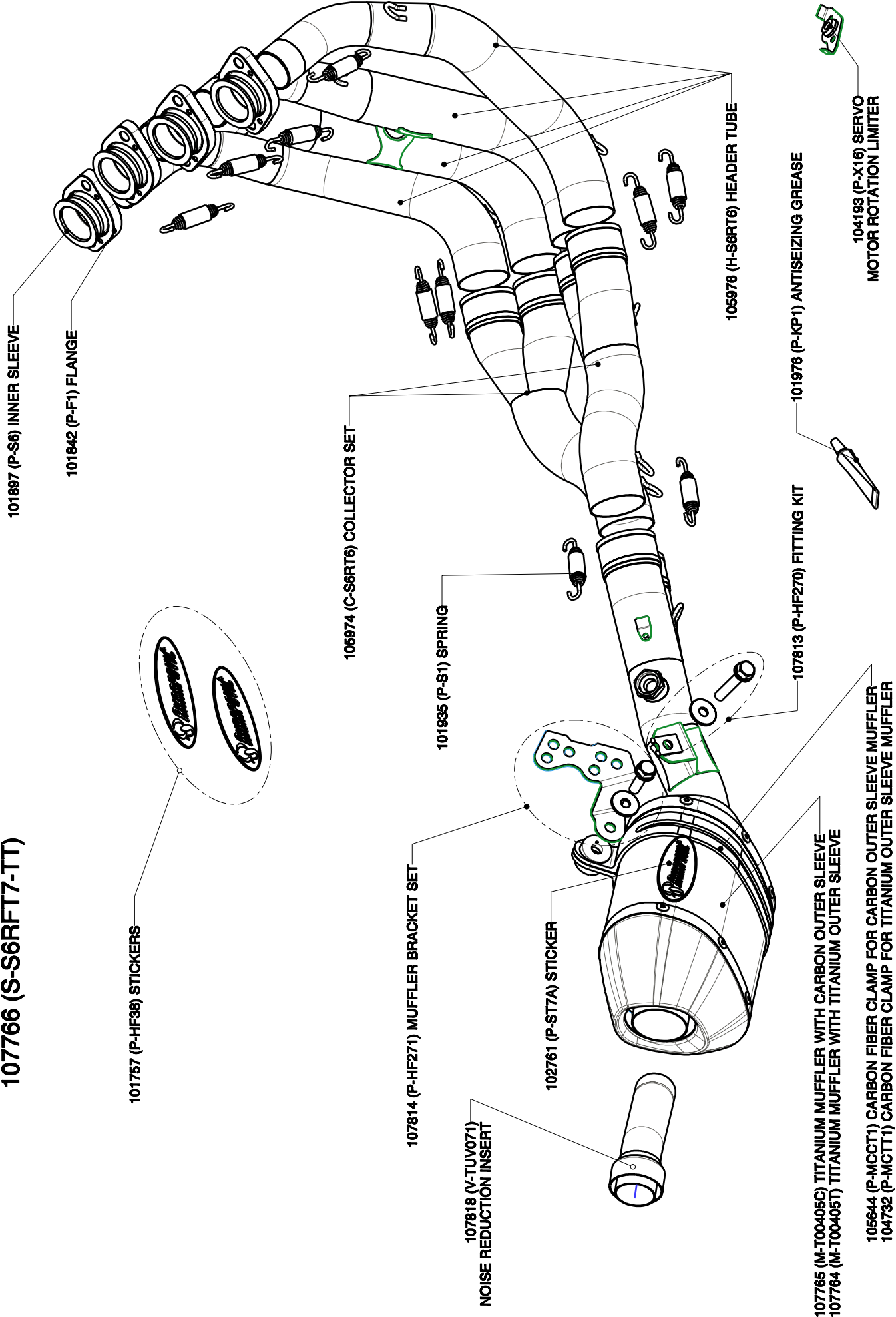

SUZUKI GSX-R 750 Complete exhaust system/Evolution line, model year: 2006, 2007

NAV - 308

**Product code: 107910 (S-S7R7-TC)
107909 (S-S7R7-TT)**

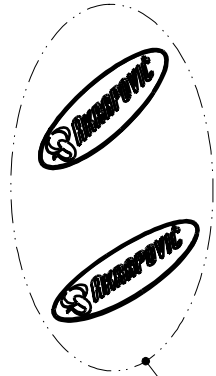

101757 (P-HF38) STICKERS

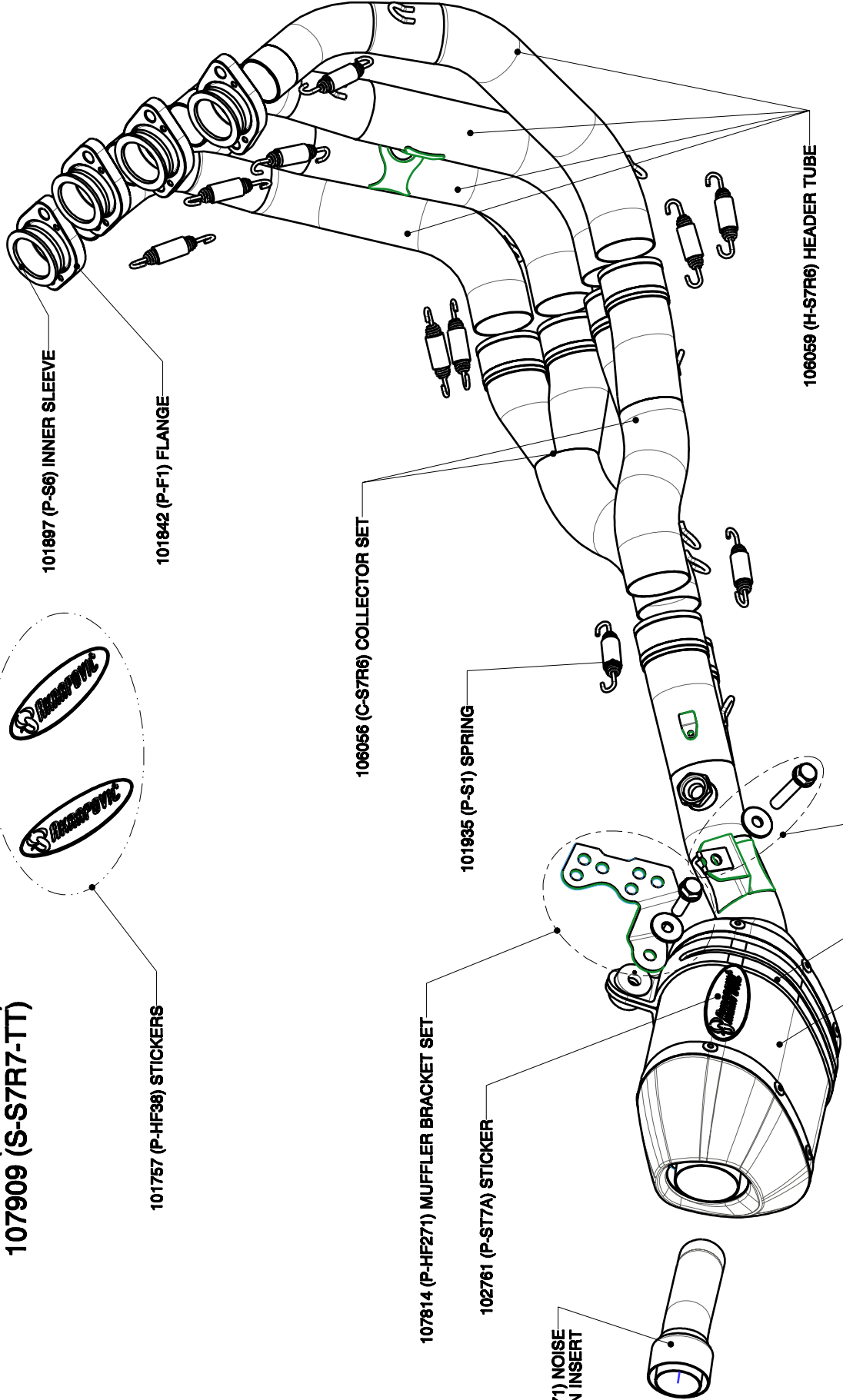

101897 (P-S6) INNER SLEEVE

101842 (P-F1) FLANGE

106056 (C-S7R6) COLLECTOR SET

101935 (P-S1) SPRING

107814 (P-HF271) MUFFLER BRACKET SET

102761 (P-ST7A) STICKER

107818 (V-TUV071) NOISE
REDUCTION INSERT

106059 (H-S7R6) HEADER TUBE

107813 (P-HF270) FITTING KIT

103508 (P-HF113) COPPER PASTE

104193 (P-X16) SERVO
MOTOR ROTATION LIMITER

107913 (M-T00602C) TITANIUM MUFFLER WITH CARBON OUTER SLEEVE
107912 (M-T00602T) TITANIUM MUFFLER WITH TITANIUM OUTER SLEEVE

105644 (P-MCCT1) CARBON FIBER CLAMP FOR CARBON OUTER SLEEVE MUFFLER
104732 (P-MCTT1) CARBON FIBER CLAMP FOR TITANIUM OUTER SLEEVE MUFFLER

SUZUKI GSX-R 750 Complete exhaust system/Evolution line, model year: 2006, 2007

NAV - 308

**Product code: 107878 (S-S7RFT7-TC)
107877 (S-S7RFT7-TT)**

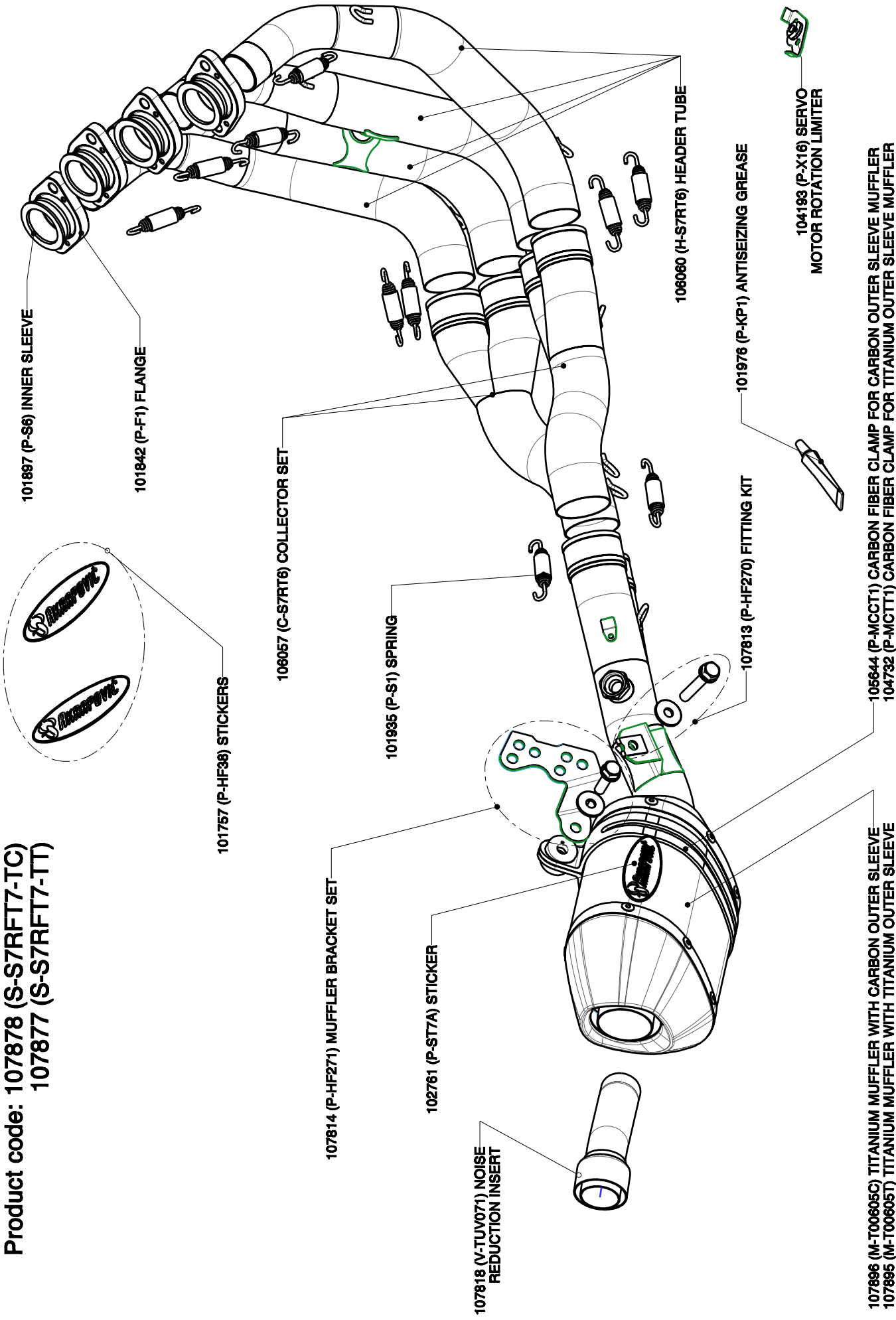

101897 (P-S6) INNER SLEEVE

101842 (P-F1) FLANGE

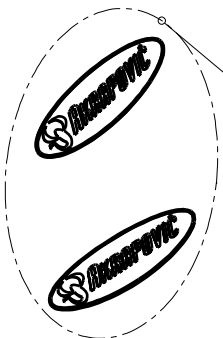

101757 (P-HF38) STICKERS

106057 (C-S7RT6) COLLECTOR SET

107814 (P-HF271) MUFFLER BRACKET SET

101935 (P-S1) SPRING

102761 (P-ST7A) STICKER

107818 (V-TUV071) NOISE REDUCTION INSERT

106060 (H-S7RT6) HEADER TUBE

101976 (P-KP1) ANTISEIZING GREASE

107813 (P-HF270) FITTING KIT

104193 (P-X16) SERVO MOTOR ROTATION LIMITER

105644 (P-MCCT1) CARBON FIBER CLAMP FOR CARBON OUTER SLEEVE MUFFLER
104732 (P-MCTT1) CARBON FIBER CLAMP FOR TITANIUM OUTER SLEEVE MUFFLER

107896 (M-T00605C) TITANIUM MUFFLER WITH CARBON OUTER SLEEVE
107895 (M-T00605T) TITANIUM MUFFLER WITH TITANIUM OUTER SLEEVE