



AKRAPOVIC SLIP-ON SP SERIES EXHAUST SYSTEM
for the
KAWASAKI ZX-6 R/RR (2005)

Congratulations on purchasing an Akrapovic exhaust system. Please read these installation instructions carefully. If you have any trouble installing the system please contact your authorized dealer!

IMPORTANT INFORMATION

Exclusion of Certain Liability

1. The manufacturer, importer or dealer shall not be liable for any incidental damage including personal injury or any other damages caused by improper installation or operation of the Akrapovic exhaust system. When installing the Akrapovic exhaust system be careful that the exhaust system does not touch other parts sensitive to high temperature.
2. Akrapovic makes no representation or warranties with regard to damage caused by the improper installation, use and maintenance of the Akrapovic exhaust system. The warranty is limited to defects recognized by our technical department and to normal use, and excludes items subject to normal wear (gaskets and damping wool). The guarantee is void in case of accident, modification, improper or competition use.
3. Do not attempt to install the Akrapovic exhaust system on a motorcycle for which it was not made or tested by Akrapovic.
4. When the exhaust system gets very hot during operation, be careful not to burn yourself on the exhaust system or parts which are in direct contact with it, even when the motor is not running. Also protect other people, especially children, from the injuries mentioned above.
5. In some cases Akrapovic exhaust system kits contain chemical products (ceramic anti-seizing grease; bolt sealant). Handle with care, do not inhale or swallow. Avoid excessive contact with skin, eyes or mucous membranes. Keep out of reach of children.
6. Technical specifications of Akrapovic exhaust systems and related products subject to change without notice.

Trademarks

The Akrapovic Exhaust System Technology logo is a registered trademark of Akrapovic d.d.

Akrapovic website

Information about Akrapovic exhaust systems and related products is available on the Akrapovic website at:
<http://www.akrapovic-exhaust.com/>

Copyright

No part of the Akrapovic exhaust system or its documentation may be reproduced or distributed in any form or by any means without the prior written authorization of the Akrapovic company.





© Akrapovic d.d. All rights reserved.

Symbols

The following symbols are used throughout these installation instructions:



INSTALLATION INSTRUCTIONS

	BEFORE INSTALLING CHECK SCHEMATIC OF THE EXHAUST SYSTEM!
	IF ANY ITEMS IN THE AKRAPOVIC EXHAUST SYSTEM PACKAGE ARE MISSING PLEASE CONTACT YOUR AUTHORIZED DEALER. KEEP THE SCHEMATIC FOR FUTURE REFERENCE.
	THESE INSTALLATION INSTRUCTIONS MUST BE READ CAREFULLY IN ORDER TO ENSURE PROPER INSTALLATION AND OPERATION OF THE AKRAPOVIC EXHAUST SYSTEM.
	THE EXHAUST SYSTEM CAN BE EXTREMELY HOT. ALLOW THE MOTORCYCLE TO COOL DOWN BEFORE BEGINNING INSTALLATION.
	WE ADVISE YOU TO LEAVE INSTALLATION TO A QUALIFIED SERVICEMAN. IMPROPER INSTALLATION MAY RESULT IN A SHORTER LIFETIME OF THE EXHAUST SYSTEM AND/OR DAMAGE TO THE MOTORCYCLE.

REMOVAL OF STOCK EXHAUST SYSTEM

1. put the motorcycle on a side stand, we recommend a racing stand
2. remove passenger seat and both side panels (**Figure 1, 2**)
3. remove driver's seat (**Figure 3, 4**)
4. unscrew the bolts from rear cowling (fastback) (**Figure 5, 6, 7, 8**), disconnect the tail light electrical connector (**Figure 9**) and remove the cowling (**Figure 10**)
5. unscrew the bolts from muffler / link pipe plastic heat shields (**Figure 11, 12, 13, 14, 15**)
6. remove the rubber shield which protects the servo motor and cables (**Figure 16**)
7. unscrew the bolts from muffler / link pipe ALU heat shield and remove the shield (**Figure 17, 18**)
8. unscrew the upper bolts from the license plate / turn signals chassis hanging bracket (**Figure 19**)
9. disconnect the license plate light and turn signals electrical connectors (**Figure 20, 21**)
10. unscrew the lower bolts from the license plate / turn signals chassis hanging bracket and remove the bracket (**Figure 22, 23**)
11. loosen and completely remove the cables from the exhaust valve (**Figure 24, 25, 26, 27, 28, 29**)
12. unscrew the bolts from the muffler chassis hanging bracket (**Figure 30**)
13. unscrew the bolt from the metal clamp at the muffler - link pipe joint and remove the muffler (**Figure 31, 32**)
14. completely remove the exhaust valve cables from the servo motor (from the control wheel for cable position) (**Figure 33, 34**)

INSTALLATION OF THE AKRAPOVIC SLIP-ON SP SERIES EXHAUST SYSTEM

installing the servo motor rotation limiter:

1. remove the stock control wheel for cable position (**Figure 35, 36**)
2. correctly position and install the Akrapovic servo motor rotation limiter; **WARNING: do not overtighten the bolt – you can damage the axle and rotation ability of the servo motor (Figure 37, 38, 39)**

installing the independent link pipe:

1. correctly position and install additional fitting ring for attaching the spring (behind the stock link pipe widening); loop for attaching must be parallel with stock link pipe line. Hand tighten the bolt of the metal ring. (**Figure 40, 41**)
2. slide the Akrapovic link pipe onto the stock link pipe; line up the loops for attaching the spring and attach the spring (**Figure 42, 43**)
3. tighten fully the bolt of the additional metal ring (**Figure 44**)
4. make sure the Akrapovic link pipe is not touching the frame and other parts

installing the muffler:

1. position the muffler correctly and slide it onto the outlet side of the link pipe (**Figure 45**)
2. correctly position the carbon-fiber clamp and slide it onto the muffler. **WARNING: open the clamp to slightly wider than the diameter of the outer sleeve of the muffler – do not scrape it along the muffler outer sleeve! (Figure 46)**
3. hand tighten the lower part of the carbon-fiber clamp (**Figure 47**)
4. tighten the upper part of the carbon-fiber clamp onto the stock chassis hanging bracket; use the stock bolts (long ones (**Figure 48**)) and Akrapovic nuts (**Figure 49, 50**)
5. attach the springs at the Akrapovic muffler - link pipe joint (**Figure 51**)
6. tighten the lower part of the carbon-fiber clamp (**Figure 52**)
7. tighten the metal clamp at the Akrapovic link pipe – stock link pipe joint (**Figure 53**)
8. make sure the muffler is not touching other parts of the motorcycle

final installation:

1. clean grease spots:
 - a. muffler – titanium outer sleeve: use a soft cloth sprayed with a multi-purpose spray lubricant (WD-40 or equivalent)
 - b. stainless steel link pipe: use a soft cloth sprayed with a contact cleaner, then wipe with a soft dry clothCleaning will prevent spots from burning onto the surface. Do not use aggressive chemical cleaners, because they can damage the sticker.
2. bear in mind the correct position (see the holes for the bolts) of the Akrapovic stainless steel chassis hanging bracket for attaching the license plate / turn signals bracket (**Figure 54**)
3. correctly attach the Akrapovic stainless steel bracket onto the license plate / turn signals bracket (**Figure 55, 56, 57**)
4. attach the tail assembly onto the motorcycle chassis and tighten the bolts (**Figure 58, 59**)
5. connect the license plate light and turn signals electrical connectors (**Figure 60, 61**)

7. reposition the rear cowling (fastback) and reconnect the tail light electrical connector (Figure 65, 66)
8. tighten the bolts for the rear cowling (fastback) (Figure 67)
9. reattach the driver's seat, side panels and passenger seat (Figure 68, 69, 70, 71, 72)
10. position of the installed Akrapovic Slip-on SP series system (Figure 73)

Check the operation of the brakes and suspension. Make sure all the bolts are sufficiently tightened. In case the exhaust system touches the cowling or other parts repeat the adjustment of the exhaust system or contact your authorized dealer.

- | |
|--|
| <p>! IT IS NORMAL IF WHITE SMOKE COMES OUT OF THE MUFFLER ON FIRST OPERATION.</p> |
| <p>! DO NOT STAND BEHIND THE MUFFLER ON FIRST OPERATION.</p> |
| <p>! DO NOT USE AUTOMOTIVE WHEEL CLEANERS OR ANY CLEANING PRODUCTS WHICH CONTAIN ACIDIC ADDITIVES TO CLEAN AKRAPOVIC EXHAUST SYSTEMS.</p> |

MAINTENANCE OF THE AKRAPOVIC EXHAUST SYSTEM

1. Clean the titanium muffler outer sleeve with a multi-purpose spray lubricant (WD-40 or equivalent). Do not use aggressive chemical cleaners, because they can damage the sticker. A change in the color of the exhaust system is normal due to the high temperatures.
2. The wearing out of the muffler silencing material depends on the type of the motor and riding style. Contact your dealer/serviceman if visible changes appear on muffler's outer sleeve or the noise level is increased.
3. Periodically ensure that all the bolts and springs are sufficiently tight.

Photos:



Figure 1



Figure 2



Figure 3



Figure 4



Figure 5



Figure 6



Figure 7



Figure 8



Figure 9



Figure 10

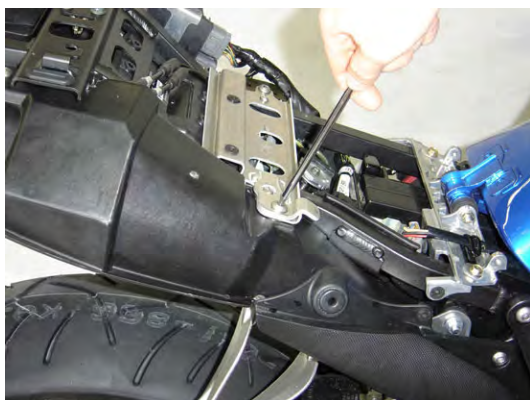

Figure 11



Figure 12



Figure 13

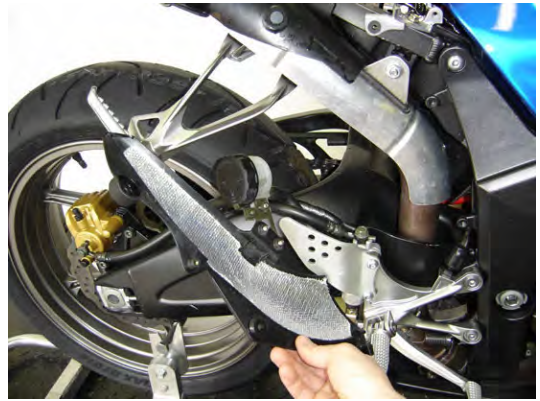

Figure 14



Figure 15



Figure 16



Figure 17



Figure 18



Figure 19



Figure 20

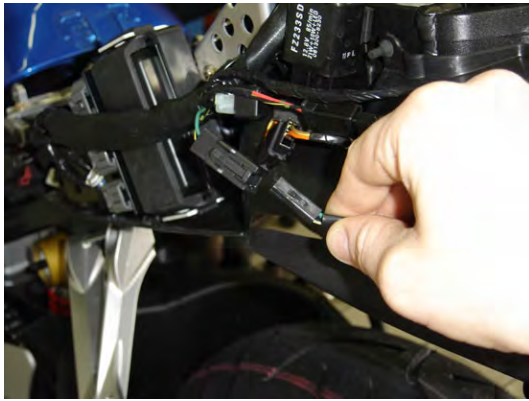

Figure 21



Figure 22



Figure 23



Figure 24



Figure 25



Figure 26



Figure 27



Figure 28



Figure 29



Figure 30



Figure 31



Figure 32

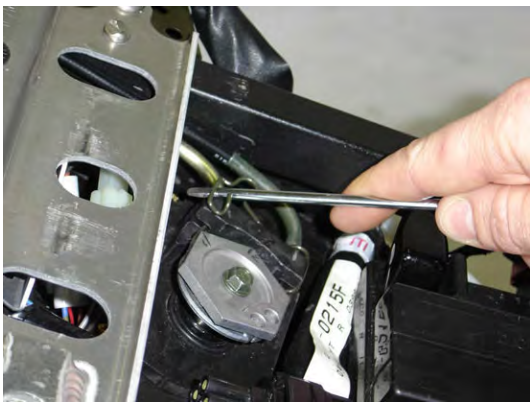

Figure 33



Figure 34



Figure 35



Figure 36



Figure 37



Figure 38



Figure 39



Figure 40



Figure 41



Figure 42



Figure 43



Figure 44



Figure 45



Figure 46



Figure 47



Figure 48



Figure 49



Figure 50



Figure 51



Figure 52



Figure 53



Figure 54



Figure 55

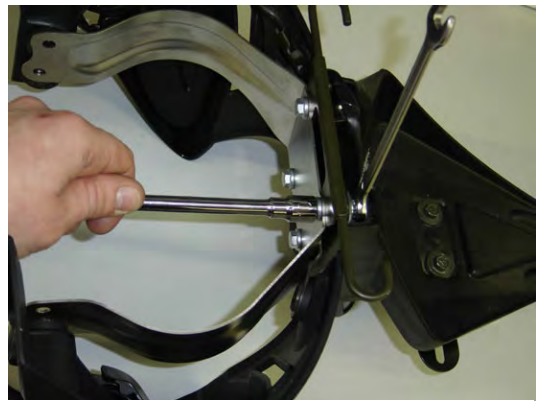

Figure 56



Figure 57



Figure 58



Figure 59



Figure 60



Figure 61



Figure 62



Figure 63



Figure 64



Figure 65



Figure 66



Figure 67



Figure 68



Figure 69



Figure 70



Figure 71



Figure 72



Figure 73

KAWASAKI ZX-6R/RR, Slip-on Exhaust System, SP Series, model year: 2005

Product code: 104055 (SS-K6SO3-NT)

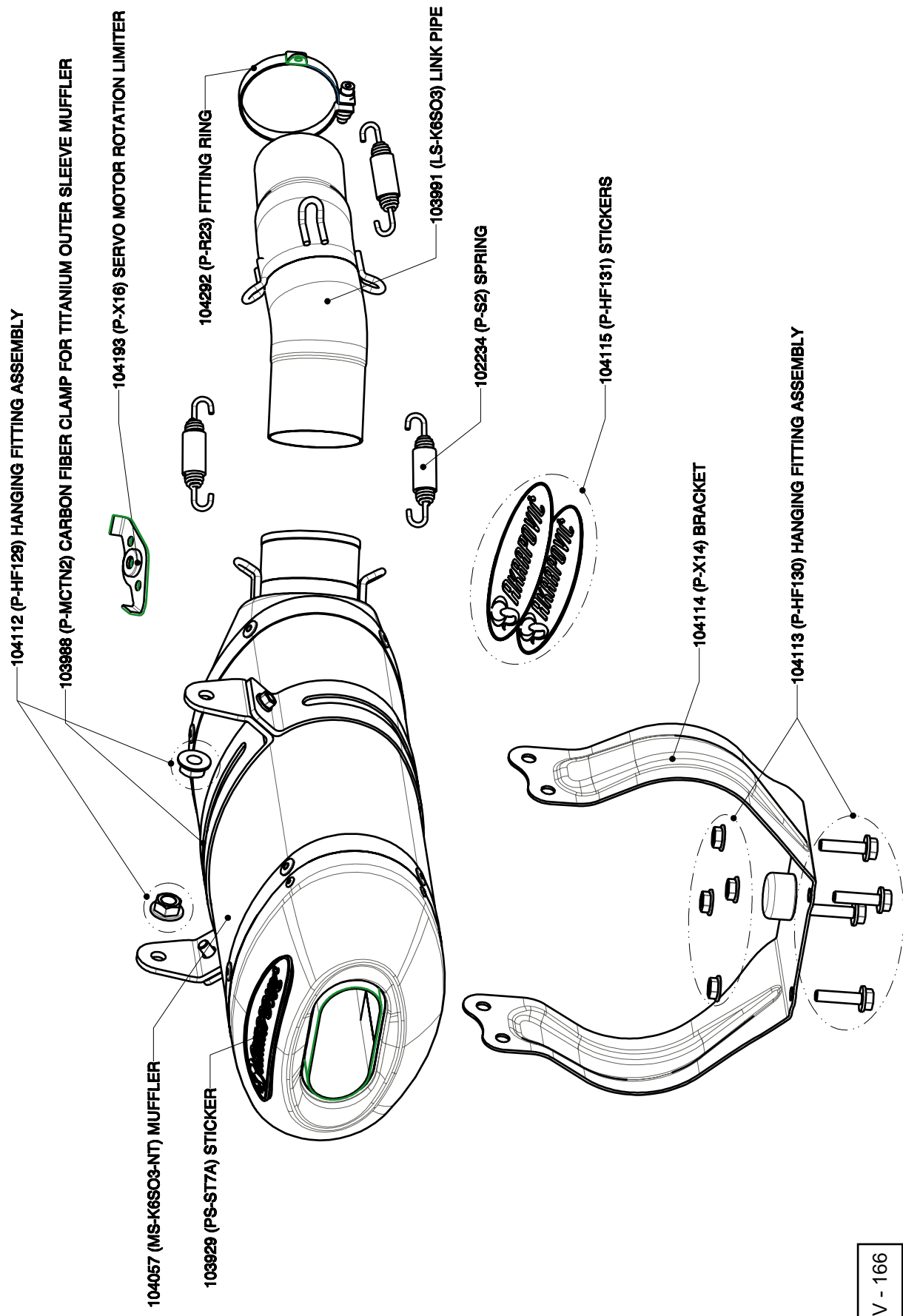

KAWASAKI ZX-6R/RR, Homologated Slip-on Exhaust System, SP Series, model year: 2005

Product code: 104056 (SS-K6SO3-HNT)

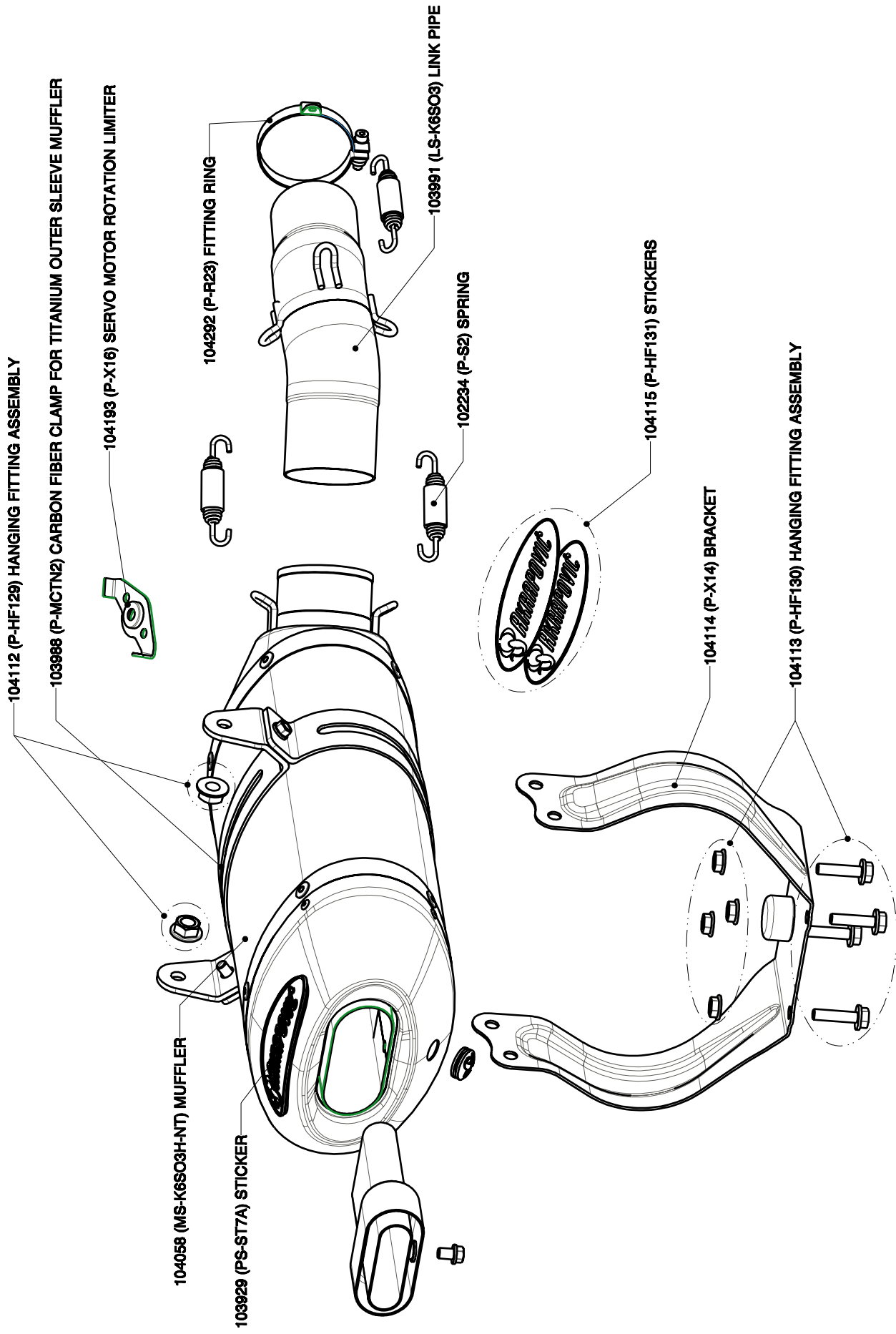

WARNING:

Please note that certain aftermarket exhaust systems may not comply with applicable California laws and regulations, and may therefore be prohibited for use on California highways or roads, or on roads or vehicles otherwise subject to emissions control requirements.

Akrapovič exhaust systems for automobiles and motorcycles mounted downstream of the catalytic converter (also known as “cat-back systems”) are considered “replacement parts” in California by the California Air Resources Board (CARB), and do not require an exemption or executive order from CARB to be sold in California. However, California prohibits the use of any aftermarket exhaust system that modifies, removes or replaces original equipment catalysts, unless CARB has issued an Executive Order as to such part or system.

Further, Akrapovič parts or exhaust systems used or intended for use on “racing vehicles” (i.e. a competition vehicle used exclusively for competition on closed-course circuits) do not require an exemption or Executive Order from CARB to be sold in California. However, such parts are prohibited from use on California public highways or roads, even if occasionally used “off-road.”