



**AKRAPOVIC SLIP-ON, SLIP-ON STREET LEGAL EXHAUST SYSTEM  
for the  
BMW R 1200 S (2006-2009)**

**Congratulations on purchasing an Akrapovic exhaust system. Please read these installation instructions carefully. If you have any trouble installing the system please contact your authorized dealer!**

**IMPORTANT INFORMATION**

**Exclusion of Certain Liability**

1. The manufacturer, importer or dealer shall not be liable for any incidental damage including personal injury or any other damages caused by improper installation or operation of the Akrapovic exhaust system. When installing the Akrapovic exhaust system be careful that the exhaust system does not touch other parts sensitive to high temperature.
2. Akrapovic makes no representation or warranties with regard to damage caused by the improper installation, use and maintenance of the Akrapovic exhaust system. The warranty is limited to defects recognized by our technical department and to normal use, and excludes items subject to normal wear (gaskets and damping wool). The guarantee is void in case of accident, modification, improper or competition use.
3. Do not attempt to install the Akrapovic exhaust system on a motorcycle for which it was not made or tested by Akrapovic.
4. When the exhaust system gets very hot during operation, be careful not to burn yourself on the exhaust system or parts which are in direct contact with it, even when the motor is not running. Also protect other people, especially children, from the injuries mentioned above.
5. In some cases Akrapovic exhaust system kits contain chemical products (ceramic anti-seizing grease; bolt sealant). Handle with care, do not inhale or swallow. Avoid excessive contact with skin, eyes or mucous membranes. Keep out of reach of children.
6. Technical specifications of Akrapovic exhaust systems and related products subject to change without notice.

**Trademarks**

The Akrapovic Exhaust System Technology logo is a registered trademark of Akrapovic d.d.

**Akrapovic website**

Information about Akrapovic exhaust systems and related products is available on the Akrapovic website at:  
**<http://www.akrapovic.com/>**

**Copyright**

No part of the Akrapovic exhaust system or its documentation may be reproduced or distributed in any form or by any means without the prior written authorization of the Akrapovic company.

© Akrapovic, d.d. All rights reserved.

**Symbols**

The following symbols are used throughout these installation instructions:



## INSTALLATION INSTRUCTIONS

 **BEFORE INSTALLING CHECK SCHEMATIC OF THE EXHAUST SYSTEM!**

 **IF ANY ITEMS IN THE AKRAPOVIC EXHAUST SYSTEM PACKAGE ARE MISSING PLEASE CONTACT YOUR AUTHORIZED DEALER. KEEP THE SCHEMATIC FOR FUTURE REFERENCE.**

 **THESE INSTALLATION INSTRUCTIONS MUST BE READ CAREFULLY IN ORDER TO ENSURE PROPER INSTALLATION AND OPERATION OF THE AKRAPOVIC EXHAUST SYSTEM.**

 **THE EXHAUST SYSTEM CAN BE EXTREMELY HOT. ALLOW THE MOTORCYCLE TO COOL DOWN BEFORE BEGINNING INSTALLATION.**

 **WE ADVISE YOU TO LEAVE INSTALLATION TO A QUALIFIED SERVICEMAN. IMPROPER INSTALLATION MAY RESULT IN A SHORTER LIFETIME OF THE EXHAUST SYSTEM AND/OR DAMAGE TO THE MOTORCYCLE.**

### REMOVAL OF STOCK EXHAUST SYSTEM

1. put the motorcycle on a side stand, we recommend a racing stand
2. unlock and remove both seats (**Figure 1, 2, 3**)
3. unscrew the bolts from the muffler metal clamp (**Figure 4, 5**)
4. unscrew the licence plate bracket and unplug the electrical connector for the light fitting at the rear of the motorcycle (**Figure 6, 7**)
5. undo the springs and remove the muffler (**Figure 8, 9**)

### INSTALLATION OF THE AKRAPOVIC SLIP-ON EXHAUST SYSTEM

#### **installing the independent link pipe:**

1. correctly position and slide the Akrapovic link pipe onto the collector (**Figure 10**)
2. attach the spring at the link pipe – collector joint (**Figure 11**)
3. make sure the link pipe is not touching the frame and other parts

#### **installing the muffler:**

1. position the upper stainless steel bracket on the subframe and tighten both bolts (**Figure 12, 13**)
2. correctly position the stainless steel licence plate brackets on the muffler and tighten the bolts - Akrapovic bolt sealant **MUST** be used when tightening the bolts (**Figure 14, 15**)
3. correctly position the double carbon-fiber clamp and slide it onto muffler ; **WARNING:** open the clamp to slightly wider than the diameter of the outer sleeve of the muffler – do not scrape it along the muffler outer sleeve! (**Figure 16**)
4. position the muffler correctly, slide it onto the outlet side of the link pipe and attach the spring – in the case of a titanium link pipe use ceramic anti-seizing grease in the joint (**Figure 17, 18**)
5. tighten the carbon-fiber clamp onto the stainless steel bracket - use the bolts and washers supplied in the Akrapovic kit - Akrapovic bolt sealant **MUST** be used when tightening the bolts (**Figure 19**)
6. tighten the stock licence plate holder onto the Akrapovic stainless steel licence plate brackets - use the bolts and washers supplied in the Akrapovic kit . Make sure the additional parts from the Akrapovic kit are correctly installed. (**Figure 20, 21, 22**)
7. plug the electrical connector for the rear light fitting (**Figure 23**)
8. make sure the muffler is not touching other parts of the motorcycle

#### **final installation:**

1. tighten fully the metal clamp at the link pipe – collector joint
2. replace both seats
3. clean grease spots:
  - a. muffler – titanium outer sleeve and link pipe(welded to muffler): use a soft cloth sprayed with a multi-purpose spray lubricant (WD-40 or equivalent)  
Cleaning will prevent spots from burning onto the surface. Do not use aggressive chemical cleaners, because they can damage the sticker.
4. position of the installed Akrapovic Slip-On system (**Figure 24**)
5. **WARNING: after running engine for 30 minutes, tighten the bolts and nuts of the Akrapovic exhaust system!**

Check the operation of the brakes and suspension. Make sure all the bolts are sufficiently tightened. In case the exhaust system touches the cowling or other parts repeat the adjustment of the exhaust system or contact your authorized dealer.

 **IT IS NORMAL IF WHITE SMOKE COMES OUT OF THE MUFFLER ON FIRST OPERATION.**

 **DO NOT STAND BEHIND THE MUFFLER ON FIRST OPERATION.**

 **DO NOT USE AUTOMOTIVE WHEEL CLEANERS OR ANY CLEANING PRODUCTS WHICH CONTAIN ACIDIC ADDITIVES TO CLEAN AKRAPOVIC EXHAUST SYSTEMS.**

## **MAINTENANCE OF THE AKRAPOVIC EXHAUST SYSTEM**

1. Clean the titanium muffler outer sleeve with a multi-purpose spray lubricant (WD-40 or equivalent ). Do not use aggressive chemical cleaners, because they can damage the sticker. A change in the color of the exhaust system is normal due to the high temperatures.
2. The wearing out of the muffler silencing material depends on the type of the motor and riding style. Contact your dealer/serviceman if visible changes appear on muffler's outer sleeve or the noise level is increased.
3. Periodically ensure that all the bolts and springs are sufficiently tight.

### **Photos:**



*Figure 1*



*Figure 2*



*Figure 3*



*Figure 4*



*Figure 5*



*Figure 6*

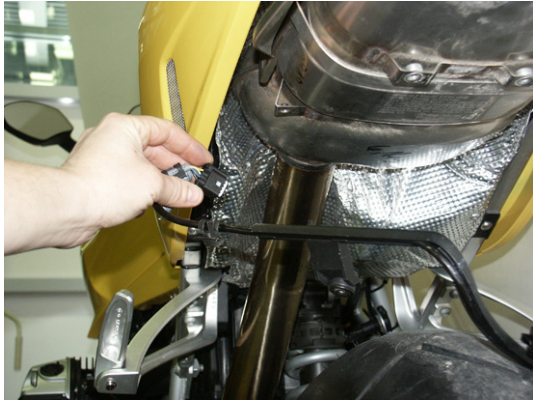

Figure 7



Figure 8



Figure 9



Figure 10

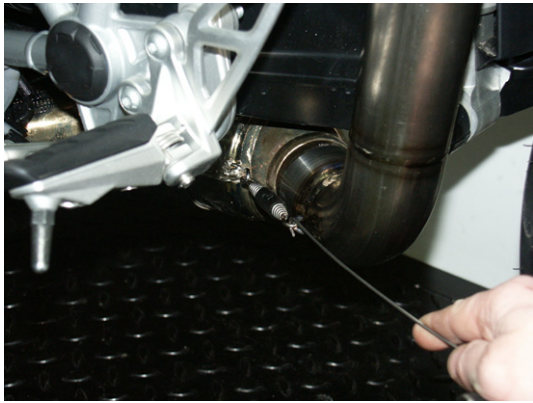

Figure 11



Figure 12



Figure 13



Figure 14



Figure 15



Figure 16



Figure 17



Figure 18



Figure 19



Figure 20



Figure 21



Figure 22



*Figure 23*



*Figure 24*

BMW R1200S 2006 - 2009 / Slip on

Product code: 105920 (S-B12SO4T-UT)

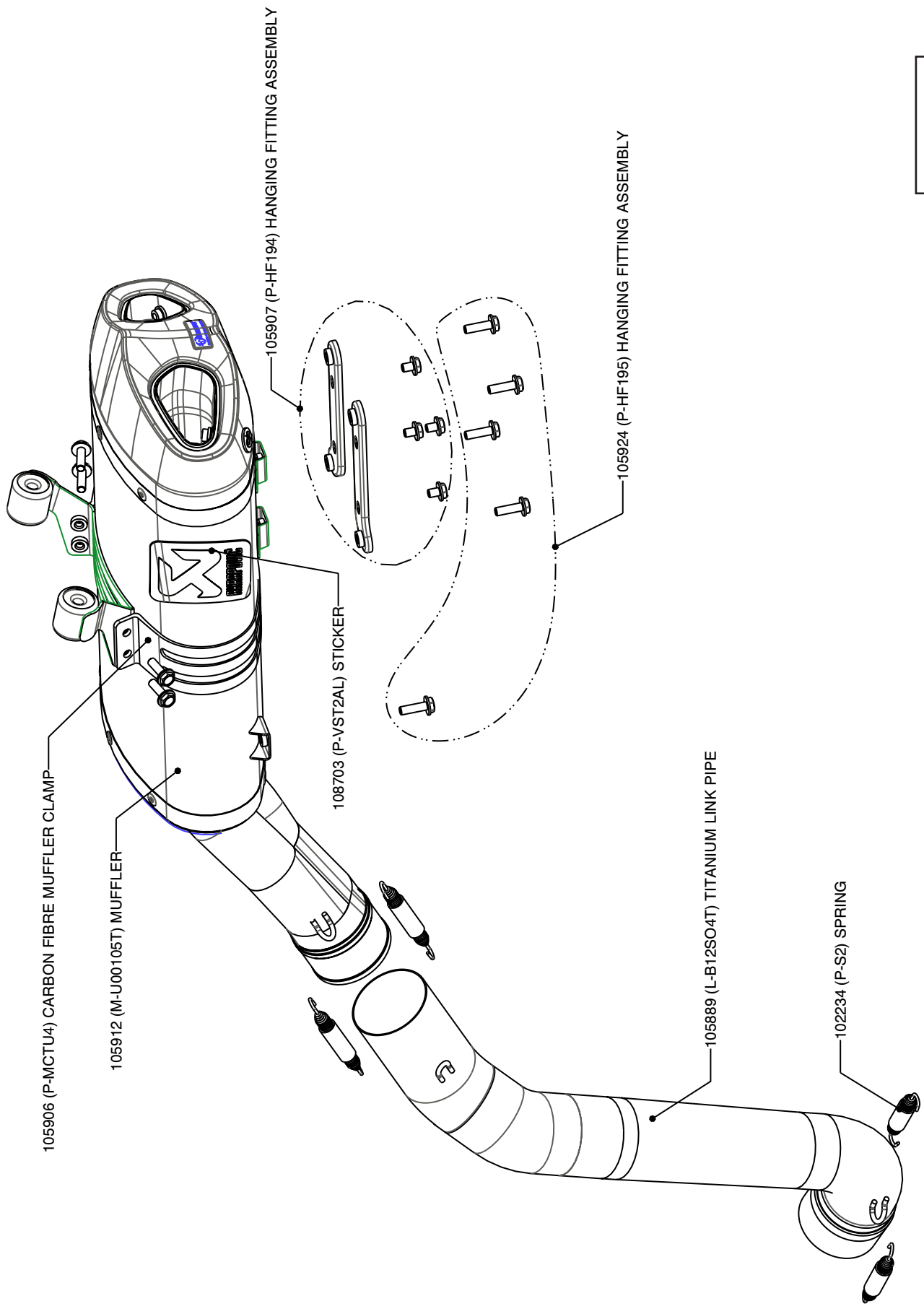

BMW R1200S 2006 - 2009 / Slip on / street legal

Product code: 105921 (S-B12SO4T-HUT)

