

Installation instructions:



AKRAPOVIC RACING & EVOLUTION OPEN for the K1200R Sport (2007) ; RACING & EVOLUTION OPEN&STREET LEGAL EXHAUST SYSTEM for the BMW K1200 S, R (2005-)

Congratulations on purchasing an Akrapovic exhaust system. Please read these installation instructions carefully. If you have any trouble installing the system please contact your authorized dealer!

IMPORTANT INFORMATION

Exclusion of Certain Liability

1. The manufacturer, importer or dealer shall not be liable for any incidental damage including personal injury or any other damages caused by improper installation or operation of the Akrapovic exhaust system. When installing the Akrapovic exhaust system be careful that the exhaust system does not touch other parts sensitive to high temperature.
2. Akrapovic makes no representation or warranties with regard to damage caused by the improper installation, use and maintenance of the Akrapovic exhaust system. The warranty is limited to defects recognized by our technical department and to normal use, and excludes items subject to normal wear (gaskets and damping wool). The guarantee is void in case of accident, modification, improper or competition use.
3. Do not attempt to install the Akrapovic exhaust system on a motorcycle for which it was not made or tested by Akrapovic.
4. When the exhaust system gets very hot during operation, be careful not to burn yourself on the exhaust system or parts which are in direct contact with it, even when the motor is not running. Also protect other people, especially children, from the injuries mentioned above.
5. In some cases Akrapovic exhaust system kits contain chemical products (ceramic anti-seizing grease; bolt sealant). Handle with care, do not inhale or swallow. Avoid excessive contact with skin, eyes or mucous membranes. Keep out of reach of children.
6. Technical specifications of Akrapovic exhaust systems and related products subject to change without notice.

Trademarks

The Akrapovic Exhaust System Technology logo is a registered trademark of Akrapovic d.å.

Akrpovic website

Information about Akrapovic exhaust systems and related products is available on the Akrapovic website at:
<http://www.akrapovic-exhaust.com/>

Copyright

No part of the Akrapovic exhaust system or its documentation may be reproduced or distributed in any form or by any means without the prior written authorization of the Akrapovic company.





© Akrapovic d.å. All rights reserved.

Symbols

The following symbols are used throughout these installation instructions:

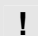

INSTALLATION INSTRUCTIONS

	BEFORE INSTALLING CHECK SCHEMATIC OF THE EXHAUST SYSTEM!
	IF ANY ITEMS IN THE AKRAPOVIC EXHAUST SYSTEM PACKAGE ARE MISSING PLEASE CONTACT YOUR AUTHORIZED DEALER. KEEP THE SCHEMATIC FOR FUTURE REFERENCE.
	THESE INSTALLATION INSTRUCTIONS MUST BE READ CAREFULLY IN ORDER TO ENSURE PROPER INSTALLATION AND OPERATION OF THE AKRAPOVIC EXHAUST SYSTEM.
	THE EXHAUST SYSTEM CAN BE EXTREMELY HOT. ALLOW THE MOTORCYCLE TO COOL DOWN BEFORE BEGINNING INSTALLATION.
	WE ADVISE YOU TO LEAVE INSTALLATION TO A QUALIFIED SERVICEMAN. IMPROPER INSTALLATION MAY RESULT IN A SHORTER LIFETIME OF THE EXHAUST SYSTEM AND/OR DAMAGE TO THE MOTORCYCLE.

REMOVAL OF STOCK EXHAUST SYSTEM

1. put the motorcycle on a side stand, we recommend a racing stand
2. **K 1200S version only:** unscrew the bolts and plastic fasteners from the side and inner part of the cowling (**Figure 1, 2**)
3. **K 1200S version only:** remove the cowling (**Figure 3**)
4. unscrew the bolt from the metal clamp at the muffler - link pipe joint (**Figure 4, 4a K 1200R version**)
5. unscrew the bolt from the muffler metal clamp and remove the muffler (**Figure 5, 6**)
6. unscrew and remove the lambda sensor (**Figure 7, 8**)
7. unscrew the nuts from the header tube flanges and remove the stock header tubes; make sure not to damage the cooling fins (**Figure 9, 10**)

INSTALLATION OF THE AKRAPOVIC RACING OR EVOLUTION EXHAUST SYSTEM

installing the header tubes:

1. set up the sleeves together with the flanges and springs; make sure they are correctly oriented and that the holes for attaching the springs line up with the loops on the header tubes; tighten the flanges; make sure not to damage the cooling fins (**Figure 11, 12**)
2. insert the header tubes properly and attach the springs; make sure not to damage the cooling fins (**Figure 13, 14**)
3. make sure the header tubes are not touching the engine, coolers, other tubes, electrical installations etc.

installing the independent collectors:

1. **for Evolution exhaust only:** coat the interior side of the input of the titanium collector with Akrapovic ceramic anti-seizing grease (white tube)
2. make sure the collectors are correctly oriented – loops for attaching the springs must line up
3. slide the collectors onto the header tubes (**Figure 15**)
4. attach the springs (**Figure 16**)
5. make sure the collectors are not touching the frame and other parts

installing the independent link pipe:

1. **for Evolution exhaust only:** coat the interior side of the input of the titanium link pipe with Akrapovic ceramic anti-seizing grease (white tube)
2. slide the Akrapovic link pipe onto the collectors (**Figure 17**)
3. attach the springs (**Figure 18**)
4. make sure the link pipe is not touching the frame and other parts
5. correctly position and install lambda sensor (**Figure 19, 20**)

In case of installing optional catalytic converter:

1. position catalytic converter correctly and insert it into the link pipe (the exposed edge on the converter must be on the outside) (**Figure 21**)

installing the muffler:

1. **for Evolution exhaust only:** coat the interior side of the mufflers titanium inlet cap with Akrapovic ceramic anti-seizing grease (white tube)
2. position the muffler correctly and slide it onto the outlet side of the link pipe (**Figure 22**)
3. attach the springs at the Akrapovic muffler - link pipe joint (**Figure 23**)
4. correctly position the carbon-fiber clamp and slide it onto the muffler, bear in mind the **left offset** of the carbon-fiber clamp viewed from the rear **WARNING:** open the clamp to slightly wider than the diameter of the outer sleeve of the muffler – do not scrape it along the muffler outer sleeve! (**Figure 24**)
5. tighten the carbon-fiber clamp onto the stock chassis hanging bracket on the frame; use the bolt, nut and washers from the Akrapovic kit (**Figure 25, 26, 27, 28**)
6. make sure the muffler is not touching other parts of the motorcycle

final installation:

1. clean grease spots:
 - a. muffler – titanium outer sleeve: use a soft cloth sprayed with a multi-purpose spray lubricant (WD-40 or equivalent)
 - b. muffler – carbon-fiber outer sleeve: use a soft dry cloth
 - c. RACING - stainless steel link pipe, collectors, header tubes: use a soft cloth sprayed with a contact cleaner, then wipe with a soft dry cloth
 - d. EVOLUTION - titanium link pipe, collectors, header tubes: use a soft cloth sprayed with a multi-purpose spray lubricant (WD-40 or equivalent)

Cleaning will prevent spots from burning onto the surface. Do not use aggressive chemical cleaners, because they can damage the sticker.

2. **K 1200S version only:** reposition the complete cowling and tighten the bolts and plastic fasteners; make sure not to damage the cooling fins (**Figure 29, 30**)
3. position of the installed Akrapovic Racing or Evolution system (**Figure 31, 32, 33**)

Check the operation of the brakes and suspension. Make sure all the bolts are sufficiently tightened. In case the exhaust system touches the cowling or other parts repeat the adjustment of the exhaust system or contact your authorized dealer.

! IT IS NORMAL IF WHITE SMOKE COMES OUT OF THE MUFFLER ON FIRST OPERATION.

! DO NOT STAND BEHIND THE MUFFLER ON FIRST OPERATION.

! DO NOT USE AUTOMOTIVE WHEEL CLEANERS OR ANY CLEANING PRODUCTS WHICH CONTAIN ACIDIC ADDITIVES TO CLEAN AKRAPOVIC EXHAUST SYSTEMS.

MAINTENANCE OF THE AKRAPOVIC EXHAUST SYSTEM

1. Clean the titanium muffler outer sleeve with a multi-purpose spray lubricant (WD-40 or equivalent) and carbon fiber outer sleeve with soft and dry cloth. Do not use aggressive chemical cleaners, because they can damage the sticker. A change in the color of the exhaust system is normal due to the high temperatures.
2. The wearing out of the muffler silencing material depends on the type of the motor and riding style. Contact your dealer/serviceman if visible changes appear on muffler's outer sleeve or the noise level is increased.
3. Periodically ensure that all the bolts and springs are sufficiently tight.

Photos:



Figure 1



Figure 2



Figure 3



Figure 4



Figure 4a



Figure 5



Figure 6



Figure 7



Figure 8



Figure 9

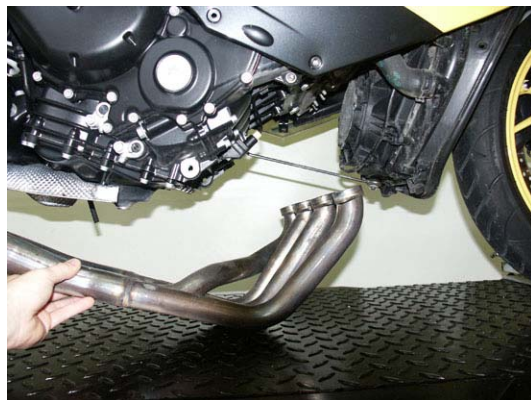

Figure 10



Figure 11



Figure 12



Figure 13



Figure 14



Figure 15



Figure 16

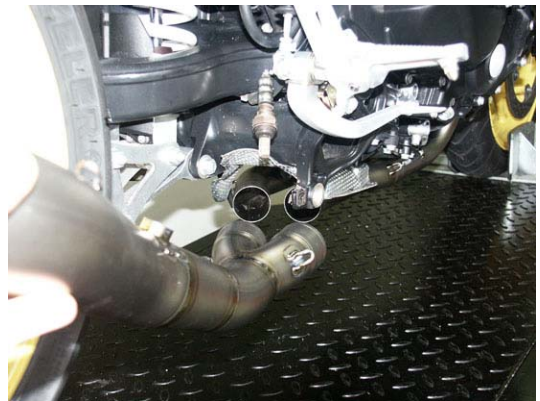

Figure 17



Figure 18



Figure 19



Figure 20



Figure 21



Figure 22



Figure 23



Figure 24



Figure 25



Figure 26



Figure 27



Figure 28



Figure 29



Figure 30



Figure 31



Figure 32



Figure 33

BMW K1200S / K1200R / K1200RS Complete Exhaust System, Racing Line, Model Year: 2005-2007
Product code: Carbon fibre outer sleeve muffler: 104978 (S-B12R2-RC)
Titanium outer sleeve muffler: 104979 (S-B12R2-RT)

NAV - 205

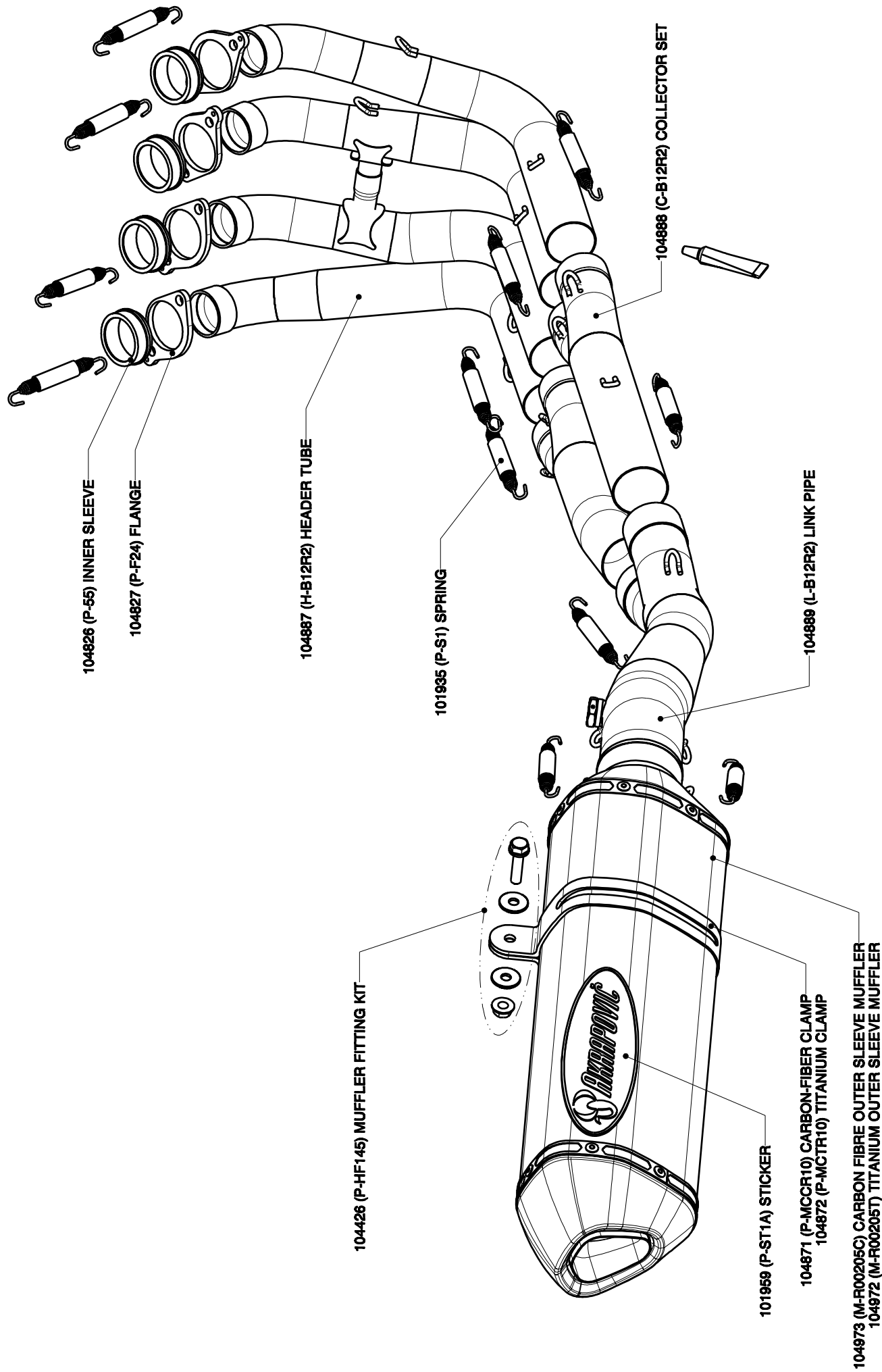

BMW K1200S / K1200R / K1200RS Complete Exhaust System, Evolution Line, Model Year: 2005-2007
Product code: Carbon fibre outer sleeve muffler: 104980 (S-B12RFT2TL-RC)
Titanium outer sleeve muffler: 104981 (S-B12RFT2TL-RT)

NAV - 205

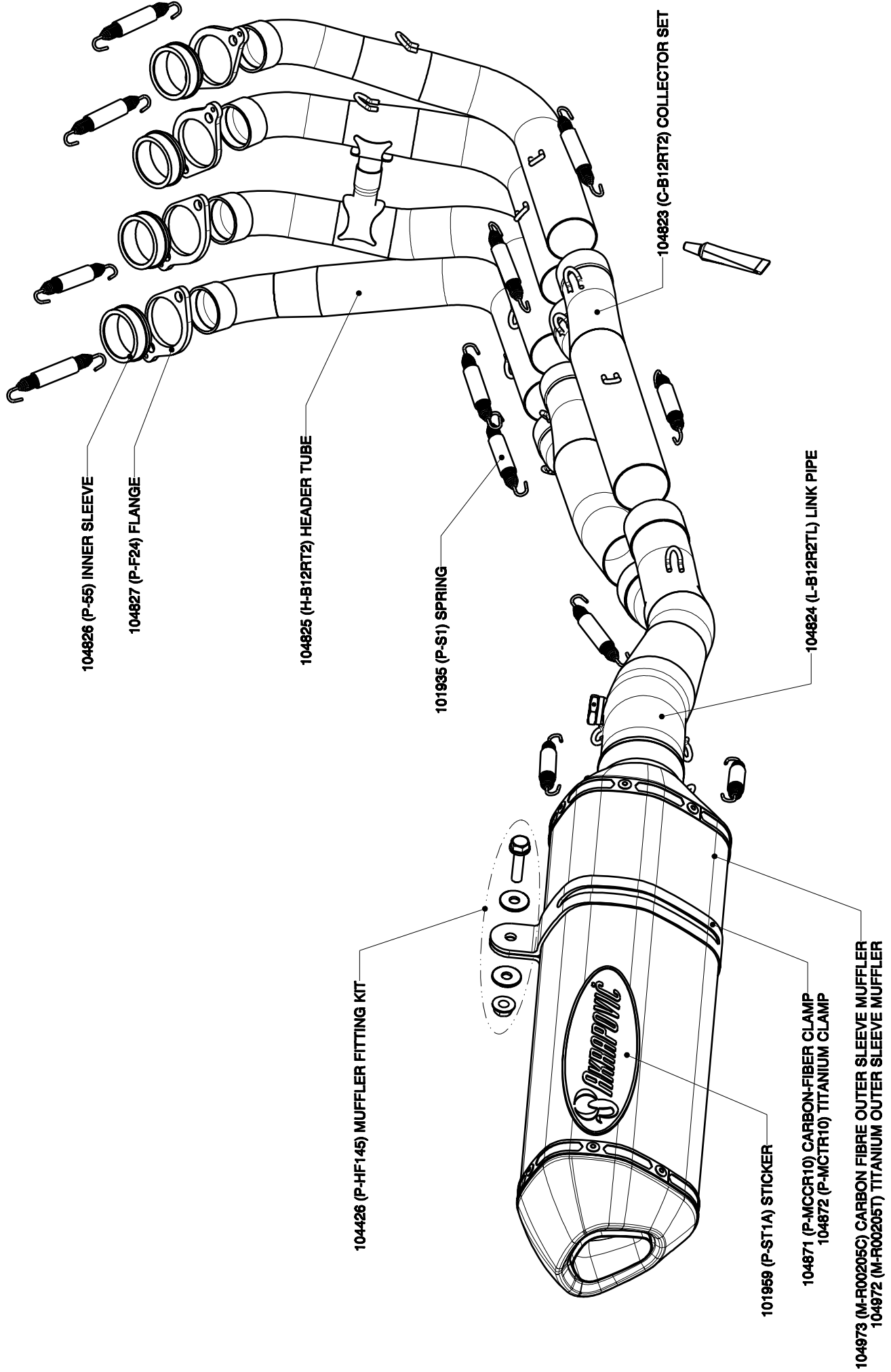

BMW K1200S / K1200R Complete Exhaust System, Racing Line, Street legal, Model Year: 2005
Product code: Carbon fibre outer sleeve muffler: 104974 (S-B12R2-HRC)
Titanium outer sleeve muffler: 104975 (S-B12R2-HRT)

NAV - 205

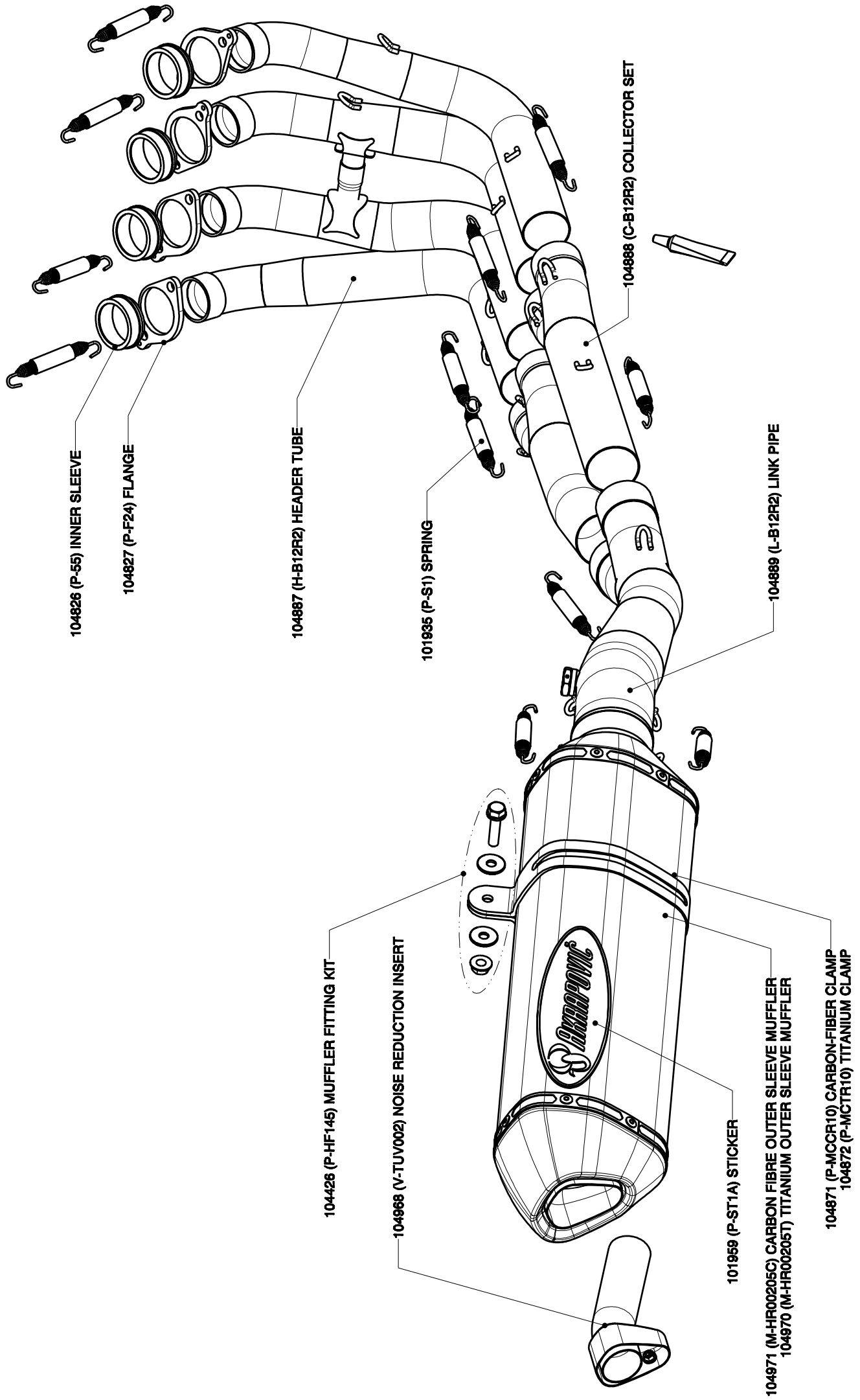

BMW K1200S / K1200R Complete Exhaust System, Evolution Line, Street legal, Model Year: 2005
Product code: Carbon fibre outer sleeve muffler: 104976 (S-B12RFT2TL-HRC)
Titanium outer sleeve muffler: 104977 (S-B12RFT2TL-HRT)

NAV - 205

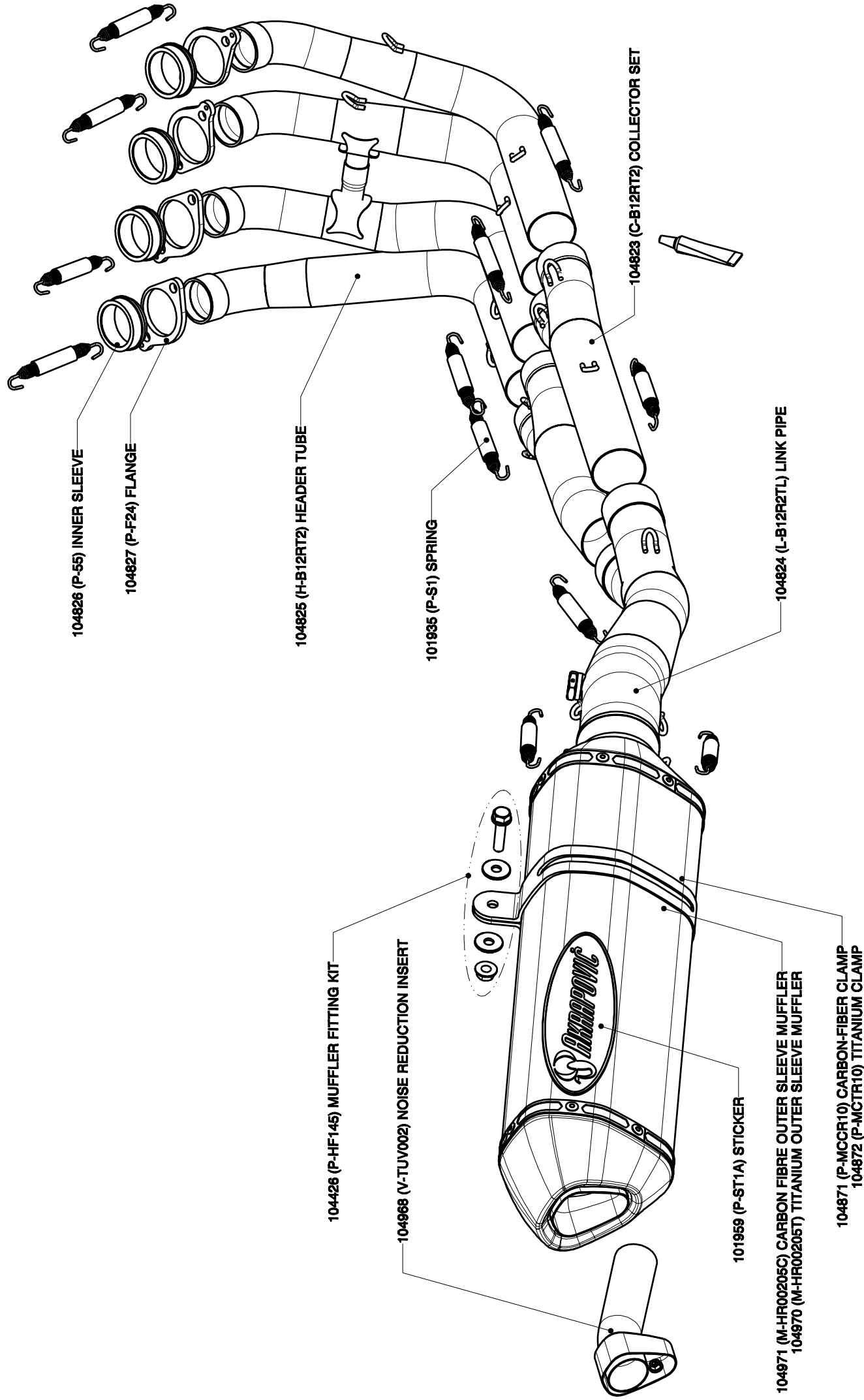

104826 (P-55) INNER SLEEVE

104827 (P-F24) FLANGE

104825 (H-B12RT2) HEADER TUBE

101935 (P-S1) SPRING

104823 (C-B12RT2) COLLECTOR SET

104426 (P-HF145) MUFFLER FITTING KIT

104966 (V-TUV002) NOISE REDUCTION INSERT

101959 (P-ST1A) STICKER

104971 (M-HR00205C) CARBON FIBRE OUTER SLEEVE MUFFLER
 104970 (M-HR00205T) TITANIUM OUTER SLEEVE MUFFLER

104824 (L-B12R2TL) LINK PIPE

104871 (P-MCCR10) CARBON-FIBER CLAMP
 104872 (P-MCTR10) TITANIUM CLAMP

WARNING:

Please note that certain aftermarket exhaust systems may not comply with applicable California laws and regulations, and may therefore be prohibited for use on California highways or roads, or on roads or vehicles otherwise subject to emissions control requirements.

Akrapovič exhaust systems for automobiles and motorcycles mounted downstream of the catalytic converter (also known as “cat-back systems”) are considered “replacement parts” in California by the California Air Resources Board (CARB), and do not require an exemption or executive order from CARB to be sold in California. However, California prohibits the use of any aftermarket exhaust system that modifies, removes or replaces original equipment catalysts, unless CARB has issued an Executive Order as to such part or system.

Further, Akrapovič parts or exhaust systems used or intended for use on “racing vehicles” (i.e. a competition vehicle used exclusively for competition on closed-course circuits) do not require an exemption or Executive Order from CARB to be sold in California. However, such parts are prohibited from use on California public highways or roads, even if occasionally used “off-road.”