



Kawasaki KLV 1000 (2004)
Suzuki V-Strom DL 1000 (2004)

Slip-On SP Series Exhaust System

Akrapovic Slip-On SP Series Exhaust System

for the Suzuki V-Strom DL 1000 (2004), Kawasaki KLV 1000 (2004)

SP SERIES exhaust systems are made of high-quality stainless steel in order to make the given model of exhaust system more affordable. Since the Suzuki and Kawasaki are set up similarly, this Akrapovic SLIP-ON SP SERIES exhaust system fits on both motorcycles. The system is designed for riders who want to make a primarily aesthetic modification to their bike at a reasonable price. The system also includes a built-in noise damper, and therefore conforms to traffic regulations with regard to exhaust system noise levels for street use.

PERFORMANCE

Measurements of the Akrapovic SLIP-ON SP SERIES system on the SUZUKI V-STROM DL 1000 (without noise damper):

Power: the engine breathes nicely through the system, as shown by the power and torque curves. The power increase grows linearly all the way from the low end right to the top of the rpm range. Max. power of 96.7 HP is achieved at 8200 rpm.
Torque: the stock torque figures are substantially increased throughout the rpm range with the Akrapovic SLIP-ON SP SERIES. The increase is most noticeable at around 6000 rpm, which suits the character and purpose of the bike.

CONFIGURATION

The Akrapovic SLIP-ON SP SERIES exhaust system is the same for both the Suzuki and the Kawasaki. It is made up of two stainless steel cylindrical link pipes and two mufflers. The individual link pipes are attached to the stock header assembly and the mufflers using free-floating joints. The connection to the header assembly is secured with a metal clamp and a spring, while the muffler joint uses only a spring. The mufflers are attached to the frame using Akrapovic carbon-fiber clamps. The mufflers have built-in noise dampers with which they conform to exhaust system noise level regulations for street use.

| | PERFORMANCE | | |
|--|-------------|-------------|----------------------|
| | stock | AKRAPOVIC | max. increased power |
| max. rear wheel power HP / rpm (measured on SuperFlow Cycle Dyn) | 94.3 / 8200 | 96.7 / 8200 | 3.8 / 7000 |

| | CONFIGURATION | | |
|------------|---------------|-----------|-----------------|
| | header tubes | collector | link pipe |
| material | - | - | STAINLESS STEEL |
| tube shape | - | - | CYLINDRICAL |

| | | | |
|-------------------------------------|---|--|---|
| interference crossover tubes | - | lambda sensor | - |
| header tube inner sleeves | - | header tube flanges | - |
| header tubes - collector connection | - | collector / header tube - link pipe connection | FREE-FLOATING + METAL CLAMP + SILICON SHIELDED SPRING |
| link pipe - muffler connection | FREE-FLOATING + SILICON SHIELDED SPRING | muffler inlet cap / outlet cap | STAINLESS STEEL / STAINLESS STEEL |
| muffler metal interior | STAINLESS STEEL | muffler outer sleeve | TITANIUM |
| muffler clamp | CARBON-FIBER ROAD | muffler bracket | - |
| noise damper | HOMOLOGATED | heat shield | - |

| OPTIONS | | | | |
|-----------|--------------|----------------------|-----------------|-------------|
| link pipe | noise damper | muffler outer sleeve | muffler bracket | heat shield |
| - | - | - | - | - |

| | ADDITIONAL DATA | | | | |
|---|-----------------|----------------|--------------------|--------------|------------------|
| | stock | AKRAPOVIC | | difference | |
| | | S.S. link pipe | TITANIUM link pipe | stock - S.S. | stock - titanium |
| weight comparison (kg) | 12.28 | 4.78 | - | 7.50 | - |
| noise measurements (dB / rpm) | stock | | AKRAPOVIC | | |
| | 92 / 3800 | | 92 / 3800 | | |
| possibility of periodic service without removing A.E.S. | oil | | oil filter | | |
| | YES | | YES | | |
| legal for street use | YES | | | | |

Technical specifications of Akrapovic exhaust systems and related products subject to change without notice.

Akrapovic Slip-On SP Series Exhaust System

for the Suzuki V-Strom DL 1000 (2004), Kawasaki KLV 1000 (2004)



CARBON-FIBER
MUFFLER CLAMPS



Akrapovic Exhaust System Technology copyright 2004, all rights reserved

Road
Program



Akrapovic Slip-On SP Series Exhaust System

for the Suzuki V-Strom DL 1000 (2004), Kawasaki KLV 1000 (2004)



Akrapovic Exhaust System Technology copyright 2004, all rights reserved

Road Program

Akrapovic Slip-On SP Series Exhaust System

for the Suzuki V-Strom DL 1000 (2004), Kawasaki KLV 1000 (2004)



Akrapovic Exhaust System Technology copyright 2004, all rights reserved

Road Program

Akrapovic Slip-On SP Series Exhaust System

for the Suzuki V-Strom DL 1000 (2004), Kawasaki KLV 1000 (2004)

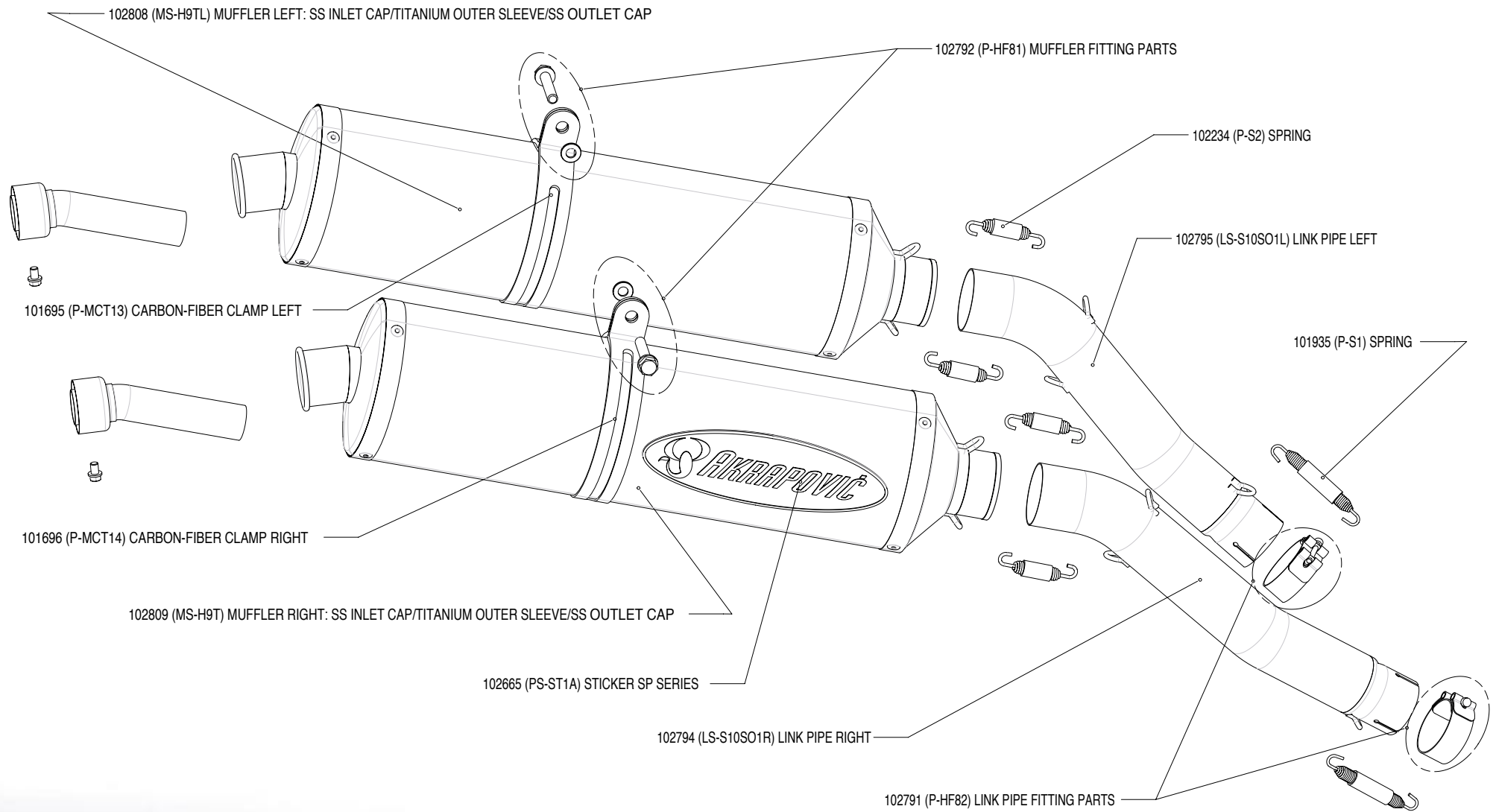

Akrapovic Exhaust System Technology copyright 2004, all rights reserved

Road Program



Akrapovic Slip-On SP Series Exhaust System for the Suzuki V-Strom DL 1000 (2004), Kawasaki KLV 1000 (2004)

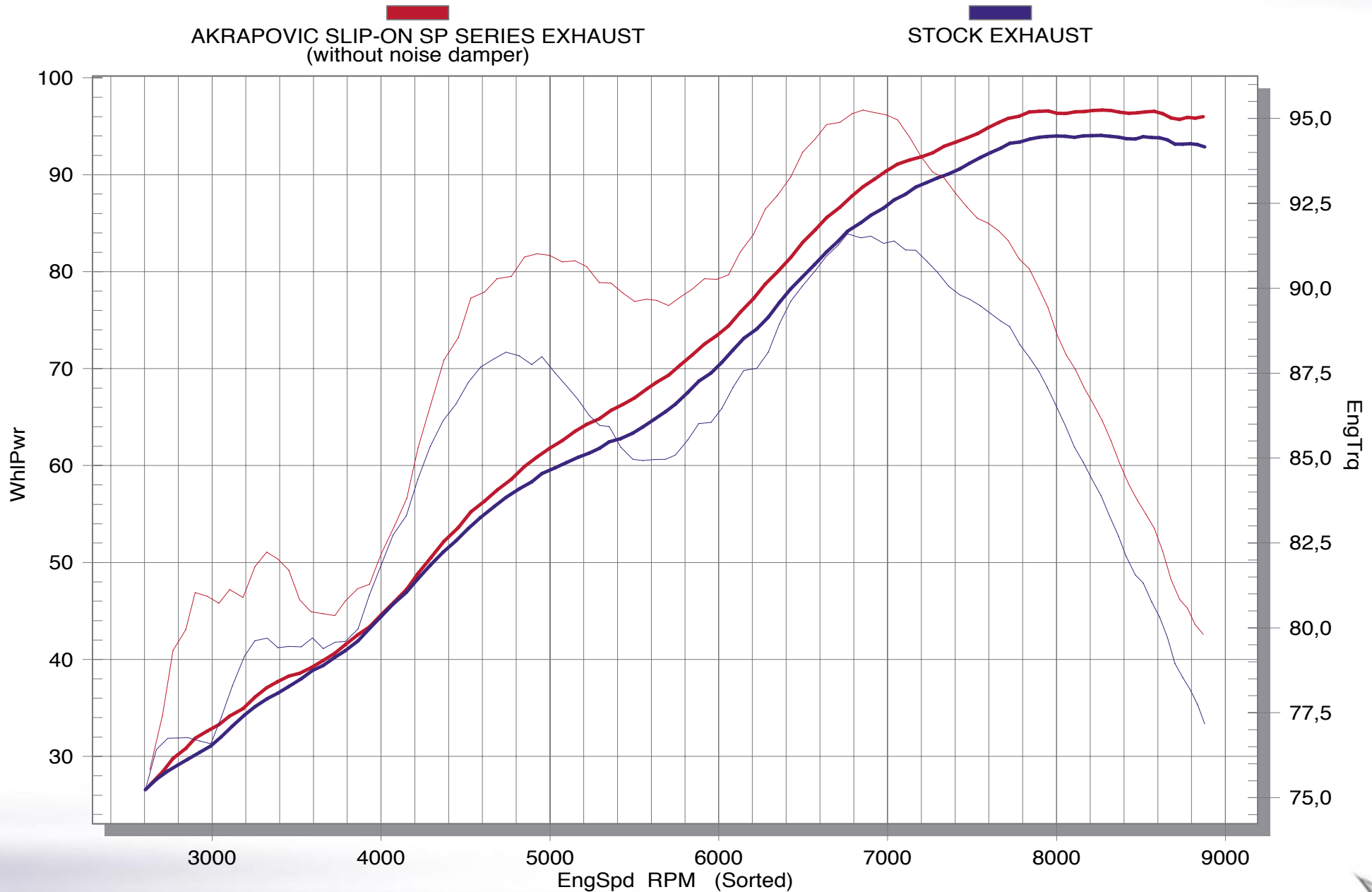

Road Program



Akrapovic Exhaust System Technology copyright 2004, all rights reserved